

ENMX

MINI HIGH FEED



High feed Milling
P Acciai K Ghisa



PELIZZARI
FAUSTINO
UTENSILI SRL







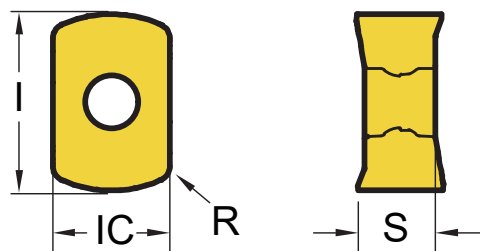

ENMX

Inserti HIGH FEED 4 taglienti negativi

- Cerchio inscritto (IC): 6.3 mm
- Spessore (S) : 4.21 mm
- Lunghezza (l) : 9.46 mm
- Raggio (r) : 0.8 mm



Geometria		Descrizione	Codice (YG602)
ENMX  General	 	ENMX 0604	12000474
ENMX  TR Tagliente rinforzato Acciai alto legati Acciai induriti Ghisa	 	ENMX 0604 - TR	12000459

Velocità di taglio																				
Gruppo materiali			Grado	Geometria inserto	Vc m/min	APMX * mm	Fz per frese con sporgenza fino a 3 x D ** ***										Plunging mm/dente			
ISO	VDI	Materiali					Diametro fresa mm													
							16	17	18	20	21	25	26	32	35	40	42	50		
P	1~5	Acciai non legati	YG602	General	140 - 380	1	0.3 ~ 1.6					0.3 ~ 2.0					0.1			
				TR	140 - 380		0.3 ~ 2.0					0.3 ~ 2.5								
	6~9	Acciai basso legati		General	120 - 300		0.3 ~ 1.6					0.3 ~ 2.0					0.1			
				TR	120 - 300		0.3 ~ 2.0					0.3 ~ 2.5								
10~11	Acciai alto legati	General	70 - 150	0.3 ~ 1.6					0.3 ~ 2.0					0.1						
		TR	70 - 150	0.3 ~ 2.0					0.3 ~ 2.5											
M	12~13	Ferritici & Martensitici	YG602	General	120 - 200	1	0.2 ~ 1.0					0.2 ~ 1.0					0.1			
	14	Austenitici		130 - 250	0.2 ~ 1.0					0.2 ~ 1.0										
K	15~16	Ghisa grigia	YG602	General	120 - 250	1	0.3 ~ 1.6					0.3 ~ 2.0					0.1			
				TR	120 - 250		0.3 ~ 2.0					0.3 ~ 2.5								
	17~18	Ghisa nodulare		General	130 - 220		0.3 ~ 1.6					0.3 ~ 2.0					0.1			
				TR	130 - 220		0.3 ~ 2.0					0.3 ~ 2.5								
H	38~41	Acciai temprati	YG602	TR	40 - 80	1	0.1 ~ 0.6					0.1 ~ 0.6					0.05			

* Per le frese diametro 16.00 ridurre il valore di ap a 0,90 mm
** Ridurre Vc - fz - ap del 30% per sporgenze > 4XD - 5XD - 6XD.

NB: Modulare i dati in funzione delle condizioni di stabilità

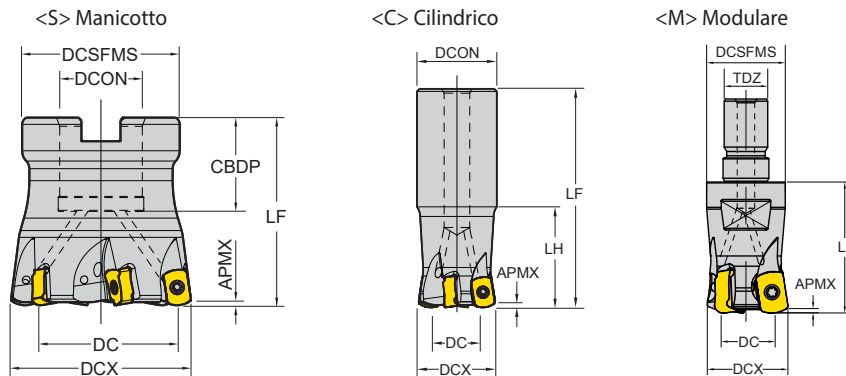

Unità: mm

APMX	Descrizione	Codice 1700..	DC	DCX	ZEFP	LF	Tipo	DCON/ TDZ	LH	CBDP	DCSFMS	
0.9	EHF-ENMX06-D16Z2C16-L100	0644	9.0	16	2	100	Cilindrica	16	30	-	-	●
	EHF-ENMX06-D16Z2C16-L150	0645	9.0	16	2	150		16	50	-	-	●
1	EHF-ENMX06-D20Z3C20-L130	0463	12.6	20	3	130		20	50	-	-	●
	EHF-ENMX06-D20Z3C20-L160	0646	12.6	20	3	160		20	80	-	-	●
	EHF-ENMX06-D25Z4C25-L140	0647	17.6	25	4	140		25	60	-	-	●
	EHF-ENMX06-D25Z4C25-L180	0464	17.6	25	4	180		25	80	-	-	●
	EHF-ENMX06-D25Z4C25-L250	0648	17.6	25	4	250		25	120	-	-	●
	EHF-ENMX06-D32Z5C32-L150	0649	24.6	32	5	150		32	70	-	-	●
	EHF-ENMX06-D32Z5C32-L200	0465	24.6	32	5	200		32	100	-	-	●
	0.9	MHF-ENMX06-D16Z2M08	0691	9.0	16	2		23	Modulare	M08	-	-
MHF-ENMX06-D18Z2M08		0730	11.0	18	2	23	M08	-		-	13	●
1	MHF-ENMX06-D20Z3M10	0692	12.6	20	3	30	M10	-		-	18	●
	MHF-ENMX06-D25Z4M12	0693	17.6	25	4	35	M12	-		-	21	●
	MHF-ENMX06-D32Z5M16	0694	24.6	32	5	42	M16	-		-	29	●
	MHF-ENMX06-D35Z5M16	0695	27.6	35	5	42	M16	-		-	29	●
	MHF-ENMX06-D40Z6M16	0732	32.6	40	6	42	M16	-		-	29	●
	MHF-ENMX06-D42Z6M16	0696	34.6	42	6	42	M16	-		-	29	●
1	FHF-ENMX06-D40Z6S16	0482	32.6	40	6	40	Manicotto	16	-	18	37	●
	FHF-ENMX06-D50Z6S22	0471	42.6	50	6	50		22	-	25	42	●

⚙ Vite : 18000039

🔑 Chiave : TWFT08

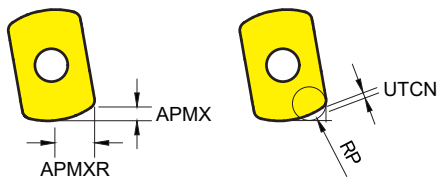

RP	UTCN	Overcut
Raggio programmazione	Spessore non lavorato	
2	0.31	0
2.5	0.18	0.18
3	0.07	0.36

Unità: mm

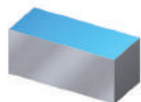

Spianatura



Plunging



Rampa

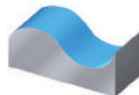

Profilatura

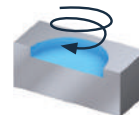

Interpolazione elicoidale

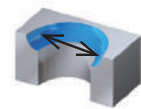

Allargatura foro

Diametro fresa Massima profondità di passata Massima profondità di passata radiale Angolo di rampa Raggio di programmazione Spessore non lavorato Diametro minimo eseguibile Diametro massimo eseguibile Passo interpolazione elicoidale Profondità di passata radiale

DCX	APMX	APMXR	RMPX	RP	UTCN	D Min	D Max	Passo	Ae
16 mm	0.9	3.5	3.6°	R2.0	0.3	21	30	0.9	12.5
20 mm	1	3.7	3.3°	R2.0	0.31	29	38	1	16.3
25 mm	1	3.7	2.2°	R2.0	0.31	39	48	1	21.3
32 mm	1	3.7	1.5°	R2.0	0.31	53	62	1	28.3
40 mm	1	3.7	1.1°	R2.0	0.31	69	78	1	36.3
50 mm	1	3.7	0.8°	R2.0	0.31	89	98	1	46.3



Descrizione	Quantità Corpo/Inserto	Codice Corpo/Inserto	Codice SET	EURO
EHF-ENMX06-D16Z2C16-L100+TR	1	17000644	KITENMX01T	242,92 €
	30	12000459		
EHF-ENMX06-D16Z2C16-L100+GN	1	17000644	KITENMX01G	242,92 €
	30	12000474		
EHF-ENMX06-D16Z2C16-L100 +20TR+10GN	1	17000644	KITENMX01M	242,92 €
	20	12000459		
	10	12000474		
EHF-ENMX06-D16Z2C16-L150+TR	1	17000645	KITENMX02T	242,92 €
	30	12000459		
EHF-ENMX06-D16Z2C16-L150+GN	1	17000645	KITENMX02G	242,92 €
	30	12000474		
EHF-ENMX06-D16Z2C16-L150 +20TR+10GN	1	17000645	KITENMX02M	242,92 €
	20	12000459		
	10	12000474		
MHF-ENMX06-D16Z2M08+TR	1	17000691	KITENMX12T	242,92 €
	30	12000459		
MHF-ENMX06-D16Z2M08+GN	1	17000691	KITENMX12G	242,92 €
	30	12000474		
MHF-ENMX06-D16Z2M08+20TR+10GN	1	17000691	KITENMX12M	242,92 €
	20	12000459		
	10	12000474		
MHF-ENMX06-D18Z2M08+TR	1	17000730	KITENMX13T	242,92 €
	30	12000459		
MHF-ENMX06-D18Z2M08+GN	1	17000730	KITENMX13G	242,92 €
	30	12000474		
MHF-ENMX06-D18Z2M08+20TR+10GN	1	17000730	KITENMX13M	242,92 €
	20	12000459		
	10	12000474		
EHF-ENMX06-D20Z3C20-L130+TR	1	17000463	KITENMX03T	242,92 €
	30	12000459		
EHF-ENMX06-D20Z3C20-L130+GN	1	17000463	KITENMX03G	242,92 €
	30	12000474		
EHF-ENMX06-D20Z3C20-L130+20TR+10GN	1	17000463	KITENMX03M	242,92 €
	20	12000459		
	10	12000474		
EHF-ENMX06-D20Z3C20-L160+TR	1	17000646	KITENMX04T	242,92 €
	30	12000459		
EHF-ENMX06-D20Z3C20-L160+GN	1	17000646	KITENMX04G	242,92 €
	30	12000474		
EHF-ENMX06-D20Z3C20-L160+20TR+10GN	1	17000646	KITENMX04M	242,92 €
	20	12000459		
	10	12000474		
MHF-ENMX06-D20Z3M10+TR	1	17000692	KITENMX14T	242,92 €
	30	12000459		
MHF-ENMX06-D20Z3M10+GN	1	17000692	KITENMX14G	242,92 €
	30	12000474		
MHF-ENMX06-D20Z3M10+20TR+10GN	1	17000692	KITENMX14M	242,92 €
	20	12000459		
	10	12000474		
EHF-ENMX06-D25Z4C25-L140+TR	1	17000647	KITENMX06T	323,56 €
	40	12000459		
EHF-ENMX06-D25Z4C25-L140+GN	1	17000647	KITENMX06G	323,56 €
	40	12000474		
EHF-ENMX06-D25Z4C25-L140+30TR+10GN	1	17000647	KITENMX06M	323,56 €
	30	12000459		
	10	12000474		
EHF-ENMX06-D25Z4C25-L180+TR	1	17000464	KITENMX05T	323,56 €
	40	12000459		
EHF-ENMX06-D25Z4C25-L180+GN	1	17000464	KITENMX05G	323,56 €
	40	12000474		
EHF-ENMX06-D25Z4C25-L180+30TR+10GN	1	17000464	KITENMX05M	323,56 €
	30	12000459		
	10	12000474		
EHF-ENMX06-D25Z4C25-L250+TR	1	17000648	KITENMX07T	323,56 €
	40	12000459		
EHF-ENMX06-D25Z4C25-L250+GN	1	17000648	KITENMX07G	323,56 €
	40	12000474		
EHF-ENMX06-D25Z4C25-L250+30TR+10GN	1	17000648	KITENMX07M	323,56 €
	30	12000459		
	10	12000474		

Prezzi al netto IVA



Descrizione	Quantità Corpo/ Inserto	Codice Corpo/Inserto	Codice SET	EURO
MHF-ENMX06-D25Z4M12+TR	1	17000693	KITENMX15T	323,56 €
	40	12000459		
MHF-ENMX06-D25Z4M12+GN	1	17000693	KITENMX15G	323,56 €
	40	12000474		
MHF-ENMX06-D25Z4M12+30TR+10GN	1	17000693	KITENMX15M	323,56 €
	30	12000459		
	10	12000474		
EHF-ENMX06-D32Z5C32-L150+TR	1	17000649	KITENMX08T	404,20 €
	50	12000459		
EHF-ENMX06-D32Z5C32-L150+GN	1	17000649	KITENMX08G	404,20 €
	50	12000474		
EHF-ENMX06-D32Z5C32-L150 +30TR+20GN	1	17000649	KITENMX08M	404,20 €
	30	12000459		
	20	12000474		
EHF-ENMX06-D32Z5C32-L200+TR	1	17000465	KITENMX09T	404,20 €
	50	12000459		
EHF-ENMX06-D32Z5C32-L200+GN	1	17000465	KITENMX09G	404,20 €
	50	12000474		
EHF-ENMX06-D32Z5C32-L200 +30TR+20GN	1	17000465	KITENMX09M	404,20 €
	30	12000459		
	20	12000474		
MHF-ENMX06-D32Z5M16+TR	1	17000694	KITENMX16T	404,20 €
	50	12000459		
MHF-ENMX06-D32Z5M16+GN	1	17000694	KITENMX16G	404,20 €
	50	12000474		
MHF-ENMX06-D32Z5M16+30TR+20GN	1	17000694	KITENMX16M	404,20 €
	30	12000459		
	20	12000474		
MHF-ENMX06-D35Z5M16+TR	1	17000695	KITENMX17T	404,20 €
	50	12000459		
MHF-ENMX06-D35Z5M16+GN	1	17000695	KITENMX17G	404,20 €
	50	12000474		
MHF-ENMX06-D35Z5M16+30TR+20GN	1	17000695	KITENMX17M	404,20 €
	30	12000459		
	20	12000474		
MHF-ENMX06-D40Z6M16+TR	1	17000732	KITENMX18T	484,84 €
	60	12000459		
MHF-ENMX06-D40Z6M16+GN	1	17000732	KITENMX18G	484,84 €
	60	12000474		
MHF-ENMX06-D40Z6M16 +40TR+20GN	1	17000732	KITENMX18M	484,84 €
	40	12000459		
	20	12000474		
MHF-ENMX06-D42Z6M16+TR	1	17000696	KITENMX19T	484,84 €
	60	12000459		
MHF-ENMX06-D42Z6M16+GN	1	17000696	KITENMX19G	484,84 €
	60	12000474		
MHF-ENMX06-D42Z6M16+40TR+20GN	1	17000696	KITENMX19M	484,84 €
	40	12000459		
	20	12000474		
FHF-ENMX06-D40Z6S16+TR	1	17000482	KITENMX10T	484,84 €
	60	12000459		
FHF-ENMX06-D40Z6S16+GN	1	17000482	KITENMX10G	484,84 €
	60	12000474		
FHF-ENMX06-D40Z6S16+40TR+20GN	1	17000482	KITENMX10M	484,84 €
	40	12000459		
	20	12000474		
FHF-ENMX06-D50Z6S22+TR	1	17000471	KITENMX11T	484,84 €
	60	12000459		
FHF-ENMX06-D50Z6S22+GN	1	17000471	KITENMX11G	484,84 €
	60	12000474		
FHF-ENMX06-D50Z6S22+40TR+20GN	1	17000471	KITENMX11M	484,84 €
	40	12000459		
	20	12000474		

Prezzi al netto IVA



PELIZZARI
FAUSTINO
UTENSILI SRL

Via Matteotti, 31 - 25063 Gardone Valtrompia (Bs)
Tel. 030 832775 - Fax 030 8911264
www.utensileriapelizzari.it
commerciale@pelizzarifaustino.it