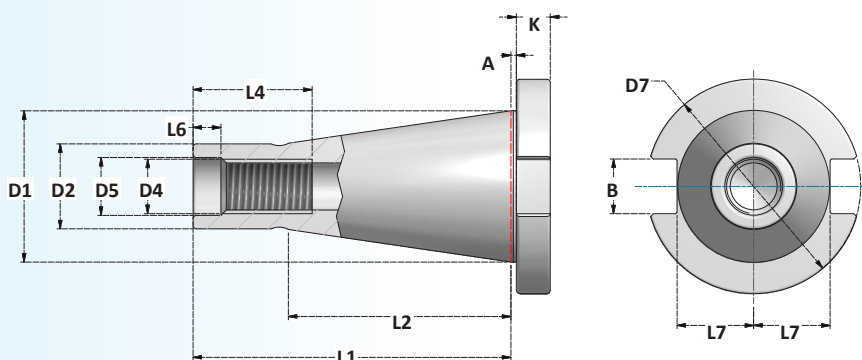
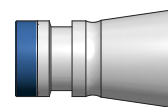

**MANDRINI ISO**  
ISO TOOLHOLDERS**DIMENSIONI CONO**  
TAPER DIMENSIONS

CONO / TAPER	A	B	D1	D2	D4	D5	D7	L1	L2	L4	L6	L7	K	
	±0,2	H12					0 -0,4				+0,5 0	max	±0,15	
<b>30</b>	1,6	16,1	31,75	17,4	M12	13	50	68,4	48,4	24	5,5	16,2	8	
<b>40</b>	1,6	16,1	44,45	25,3	M16	17	63	93,4	65,4	32	8,2	22,5	10	OTT (Fig.1)
<b>50</b>	3,2	25,7	69,85	39,6	M24	26	97,5	126,8	101,8	47	11,5	35,3	12	

(Fig.1) **GOLA MAHO - OTT**  
(Fig.1) **MAHO - OTT GROOVE****CARATTERISTICHE:**

Tolleranza di precisione dei coni: AT3.  
 Costruiti in acciaio certificato in barre.  
 Eseguiti trattamenti termici da fornitori certificati.  
 Rettificati di precisione esternamente e internamente.  
 Controllati con strumenti di misura certificati.  
 Prebilanciati nei gradi indicati nelle pagine di catalogo.

**FEATURES:**

The precision tolerance of tapers is AT3.  
 Made of certified steel.  
 Heat treatments performed by certified suppliers.  
 Precision grinding externally and internally.  
 Checked with certified measuring instruments.  
 Pre-balanced as indicated in the catalog pages.

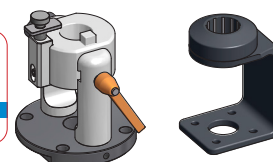
SUPPORTI DI MONTAGGIO  
ASSEMBLY DEVICES **P.310**

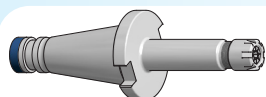

**MANDRINI PORTAPINZA ER  
GHIERE MINI**  
COLLET CHUCKS ER  
MINI NUTS

DIN ISO 15488 (DIN6499)

PAG. 156

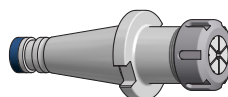

**MANDRINI PORTAPINZA ER  
GHIERE STANDARD**  
COLLET CHUCKS ER  
STANDARD NUTS

DIN ISO 15488 (DIN6499)

PAG. 157

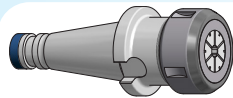

**MANDRINI PORTAPINZA EOC**  
COLLET CHUCKS EOC

DIN ISO 10897 (DIN6388)

PAG. 158

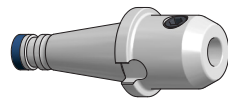

**MANDRINI  
PORTAFRESA WELDON**  
END MILL HOLDERS WELDON

DIN 1835-2

PAG. 159

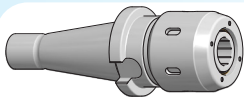

**MANDRINI A FORTE SERRAGGIO**  
POWER MILLING CHUCKS

PAG. 160

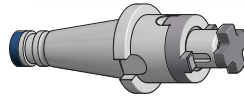

**MANDRINI PORTAFRESA COMBI**  
COMBI SHELL MILL HOLDERS

DIN 6358

PAG. 162

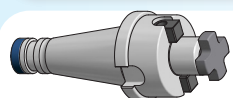

**MANDRINI PORTAFRESA FISSI**  
SHELL MILL HOLDERS

DIN 6357

PAG. 163

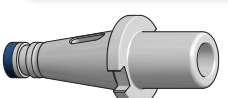

**RIDUZIONI A CONO MORSE  
PER PUNTE**  
MORSE TAPER ADAPTERS  
FOR DRILLS

DIN 6383

PAG. 164

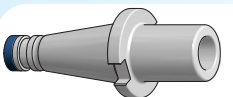

**RIDUZIONI A CONO MORSE  
PER FRESE**  
MORSE TAPER ADAPTERS FOR  
THREADED MILLS

DIN 6364

PAG. 164

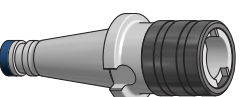

**PORTAMASCHI**  
TAPPING CHUCKS

PAG. 165

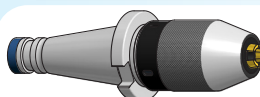

**MANDRINI PORTAPUNTA**  
DRILL CHUCKS

PAG. 166

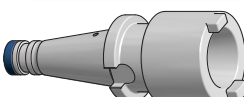

**RIDUZIONI**  
ADAPTERS

PAG. 168



**MANDRINI  
CON STELO LAVORABILE**  
BLANK ARBORS

PAG. 169





**MANDRINI PORTAPINZA ER**  
ER COLLET CHUCKS

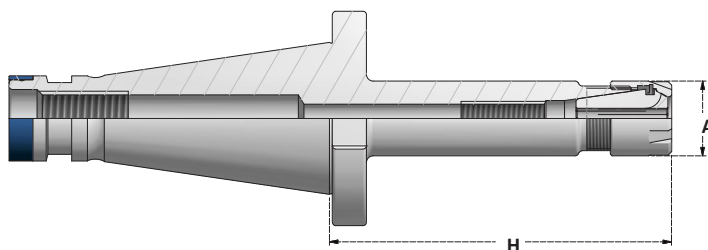

SCHEDA TECNICA  
TECHNICAL DATA  
ERC | P. 338

Articolo	H
<b>ISO30.H100.ERC16M</b>	100
<b>ISO30.H100.ERC20M</b>	100
<b>ISO30.H100.ERC25M</b>	100

	A	Collets Range	Ghiera Nut
<b>...ERC11M</b>	16	1÷7	G11M
<b>...ERC16M</b>	22	1÷10	G16M
<b>...ERC20M</b>	28	1÷14	G20M
<b>...ERC25M</b>	35	1÷20	G25M

Articolo	H
<b>ISO40.H100.ERC11M</b>	100
<b>ISO40.H100.ERC16M</b>	100
<b>ISO40.H100.ERC20M</b>	100
<b>ISO40.H100.ERC25M</b>	100



**ACCESSORI - ACCESSORIES**

 <b>P. 250</b> PINZE COLLETS	 <b>P. 280</b> GHIERE NUTS
 <b>P. 310</b> SUPPORTI DI MONTAGGIO ASSEMBLY DEVICES	 <b>P. 288</b> CHIAVI WRENCHES

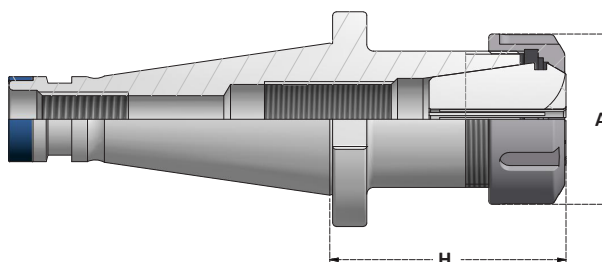

**MANDRINI PORTAPINZA ER**  
ER COLLET CHUCKSSCHEDA TECNICA  
TECHNICAL DATA  
ERC | P. 338

	A	Collets Range	Ghiera Nut
...ERC16	28	1÷10	G16SE
...ERC20	34	1÷14	G20SE



	A	Collets Range	Ghiera Nut
...ERC25	42	1÷20	G25S
...ERC32	50	2÷22	G32S
...ERC40	63	3÷30	G40S
...ERC50	78	6÷34	G50S
...ERC60	83	10÷40	G60C

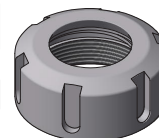

Articolo	H
ISO30.H50.ERC16	50
ISO30.H70.ERC16	70
ISO30.H100.ERC16	100
ISO30.H50.ERC20	50
ISO30.H70.ERC20	70
ISO30.H100.ERC20	100
ISO30.H50.ERC25	50
ISO30.H70.ERC25	70
ISO30.H100.ERC25	100
ISO30.H50.ERC32	50
ISO30.H70.ERC32	70
ISO30.H100.ERC32	100
ISO30.H70.ERC40	70
ISO30.H84.ERC40	84
ISO30.H100.ERC40	100

Articolo	H
ISO40.H50.ERC16	50
ISO40.H70.ERC16	70
ISO40.H100.ERC16	100
ISO40.H50.ERC20	50
ISO40.H70.ERC20	70
ISO40.H100.ERC20	100
ISO40.H50.ERC25	50
ISO40.H70.ERC25	70
ISO40.H100.ERC25	100
ISO40.H130.ERC25	130
ISO40.H50.ERC32	50
ISO40.H70.ERC32	70
ISO40.H100.ERC32	100
ISO40.H130.ERC32	130
ISO40.H160.ERC32	160
ISO40.H56.ERC40	56
ISO40.H70.ERC40	70
ISO40.H100.ERC40	100
ISO40.H130.ERC40	130
ISO40.H160.ERC40	160
ISO40.H200.ERC40	200
ISO40.H100.ERC50	100

Articolo	H
ISO50.H70.ERC16	70
ISO50.H130.ERC16	130
ISO50.H100.ERC20	100
ISO50.H130.ERC20	130
ISO50.H70.ERC25	70
ISO50.H100.ERC25	100
ISO50.H130.ERC25	130
ISO50.H160.ERC25	160
ISO50.H70.ERC32	70
ISO50.H100.ERC32	100
ISO50.H130.ERC32	130
ISO50.H160.ERC32	160
ISO50.H200.ERC32	200
ISO50.H70.ERC40	70
ISO50.H100.ERC40	100
ISO50.H130.ERC40	130
ISO50.H160.ERC40	160
ISO50.H200.ERC40	200
ISO50.H67.ERC50	67
ISO50.H83.ERC60	83

**KIT - MANDRINO, CHIAVE E PINZE**

KIT - TOOLHOLDER, WRENCH AND COLLETS

Articolo	Pinze Collets	Mandrino Toolholder	Chiave Wrench
<b>BX.ISO40.ERC32-6</b>	ERC32.D6-D8-D10-D12-D16-D20	ISO40.H70.ERC32	CH32S
<b>BX.ISO40.ERC40-7</b>	ERC40.D6-D8-D10-D12-D16-D20-D25	ISO40.H70.ERC40	CH40S

Articolo	Pinze Collets	Ø Pinze Collets	Mandrino Toolholder	Chiave Wrench
<b>BX.ISO30.ERC25</b>	ERC25	D2÷16	ISO30.H70.ERC25	CH25S
<b>BX.ISO30.ERC32</b>	ERC32	D3÷20	ISO30.H70.ERC32	CH32S
<b>BX.ISO30.ERC40</b>	ERC40	D4÷26	ISO30.H70.ERC40	CH40S
<b>BX.ISO40.ERC25</b>	ERC25	D2÷16	ISO40.H70.ERC25	CH25S
<b>BX.ISO40.ERC32</b>	ERC32	D3÷20	ISO40.H70.ERC32	CH32S
<b>BX.ISO40.ERC40</b>	ERC40	D4÷26	ISO40.H70.ERC40	CH40S
<b>BX.ISO50.ERC25</b>	ERC25	D2÷16	ISO50.H70.ERC25	CH25S
<b>BX.ISO50.ERC32</b>	ERC32	D3÷20	ISO50.H70.ERC32	CH32S
<b>BX.ISO50.ERC40</b>	ERC40	D4÷26	ISO50.H70.ERC40	CH40S

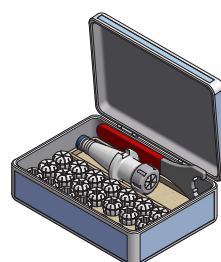
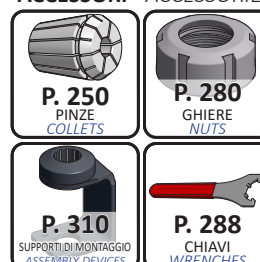
**ACCESSORI - ACCESSORIES**

**MANDRINI PORTAPINZA EOC**  
*EOC COLLET CHUCKS***G6,3**

8000r.p.m.

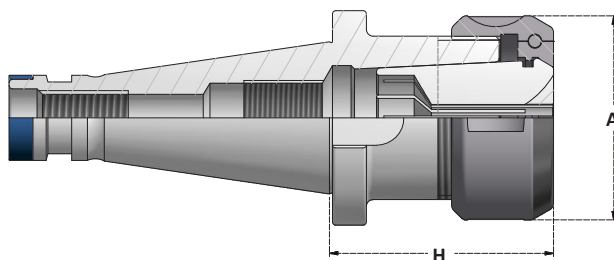

Articolo	H
<b>ISO40.H55.EOC16</b>	55
<b>ISO40.H66.EOC25</b>	66
<b>ISO40.H95.EOC32</b>	95

	A	Collets Range	Ghiera Nut
<b>...EOC16</b>	43	2÷16	G16OCC
<b>...EOC25</b>	60	2÷25	G25OCC
<b>...EOC32</b>	72	3÷32	G32OCC

Articolo	H
<b>ISO50.H57.EOC25</b>	57
<b>ISO50.H73.EOC32</b>	73

**ACCESSORI - ACCESSORIES**

**MANDRINI PORTAFRESA WELDON**  
END MILL HOLDERS WELDON**G6,3**  
8000r.p.m.

Fig.1

SCHEDA TECNICA  
TECHNICAL DATA  
WE P. 347WE6 ÷ WE20  
1 Grano  
1 ScrewWE25 ÷ WE50  
2 Grani  
2 Screws

Articolo	H	Fig
ISO30.H40.WE6	40	1
ISO30.H40.WE8	40	1
ISO30.H40.WE10	40	1
ISO30.H40.WE12	40	1
ISO30.H40.WE14	40	1
ISO30.H50.WE16	50	1
ISO30.H50.WE18	50	1
ISO30.H63.WE20	63	1
ISO30.H85.WE25	85	1

Articolo	H	Fig
ISO40.H50.WE6	50	1
ISO40.H50.WE8	50	1
ISO40.H50.WE10	50	1
ISO40.H50.WE12	50	1
ISO40.H50.WE14	50	1
ISO40.H60.WE16	60	1
ISO40.H65.WE18	65	1
ISO40.H65.WE20	65	1
ISO40.H80.WE25	80	1
ISO40.H80.WE32	80	1
ISO40.H90.WE40	90	1

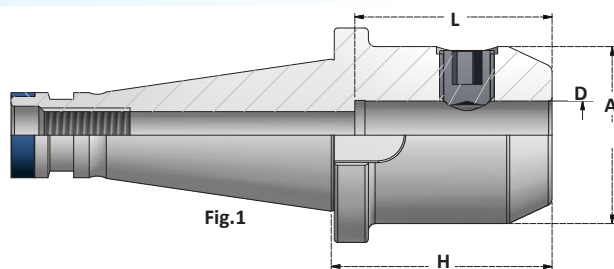
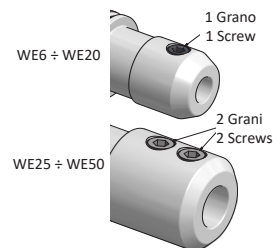
Articolo	H	Fig
ISO50.H63.WE6	63	1
ISO50.H63.WE8	63	1
ISO50.H63.WE10	63	1
ISO50.H63.WE12	63	1
ISO50.H63.WE14	63	1
ISO50.H63.WE16	63	1
ISO50.H63.WE18	63	1
ISO50.H63.WE20	63	1
ISO50.H80.WE25	80	1
ISO50.H80.WE32	80	1
ISO50.H90.WE40	90	1
ISO50.H110.WE50	110	1

	D	L1	A	Grano Screw
...WE6	6	37	25	GR.WE6
...WE8	8	37	28	GR.WE8
...WE10	10	41	35	GR.WE10
...WE12	12	46	42	GR.WE12-14
...WE14	14	46	44	GR.WE12-14
...WE16	16	49	48	GR.WE16-18
...WE18	18	49	50	GR.WE16-18
...WE20	20	51	52	GR.WE20

	D	L1	A	Grani Screws
..WE25	25	59	65	2x GR.WE25
..WE32	32	63	72	2x GR.WE32-40
..WE40	40	73	80	2x GR.WE32-40
..WE50	50	83	100	2x GR.WE50

**MANDRINI PORTAFRESA WELDON - EXTRACORTI**  
END MILL HOLDERS WELDON - STUB LENGTH

Articolo	H	Grano Screw	Fig
ISO40.H22.WE16	22	GR.WEC16	2
ISO40.H22.WE20	22	GR.WEC20	2
ISO40.H22.WE25	22	GR.WEC20	2

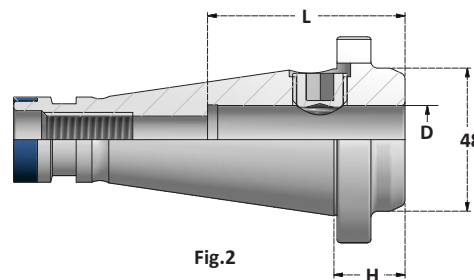

Fig.2

## ACCESSORI - ACCESSORIES





### MANDRINI A FORTE SERRAGGIO POWER MILLING CHUCKS

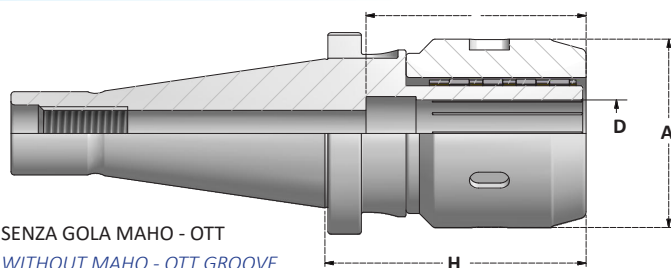

SENZA GOLA MAHO - OTT  
WITHOUT MAHO - OTT GROOVE

SCHEDA TECNICA  
TECHNICAL DATA  
FS P. 344

Articolo	D	H	A
<b>ISO40.H100.FS32</b>	32	100	69
<b>ISO50.H100.FS32</b>	32	100	69



**G6,3**

12000 r.p.m.



0,005



CANALINI  
CHANNELS



CHIAVE INCLUSA  
WRENCH INCLUDED

	D	A	L1
<b>...FS32</b>	32	69	71,7

Forza di serraggio  
Clamping force

**FS32 1000Nm**

### DISCHI DI TENUTA PER MANDRINI A FORTE SERRAGGIO SEALED CAPS FOR POWER MILLING CHUCKS



A TENUTA  
SEALED

#### DISCHI DI TENUTA PER DIAMETRO NOMINALE SEALED CAPS FOR NOMINAL DIAMETER

Articolo	D
<b>CFS32.D32</b>	32

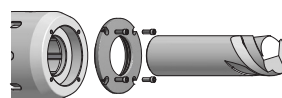

SCHEDA TECNICA  
TECHNICAL DATA  
FS P. 344

#### DISCHI DI TENUTA PER L'UTILIZZO DELLE PINZE DI RIDUZIONE SEALED CAPS FOR REDUCTION COLLETSE USING

Articolo	D	RG Range
<b>CFS32.RG</b>	RG40	D6÷D25

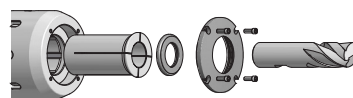

**P. 284**  
DISCHETTI RG  
RG SEALED DISCS

#### KIT - MANDRINO, CHIAVE E PINZE

KIT - TOOLHOLDER, WRENCH AND COLLETS

Articolo	Pinze Collets	Ø Pinze Ø Collets	Mandrino con chiave Toolholder with wrench
<b>BX.ISO40.FS32</b>	4SR32	D6 D8 D10 D12 D16 D20 D25	ISO40.H100.FS32
<b>BX.ISO50.FS32</b>	4SR32	D6 D8 D10 D12 D16 D20 D25	ISO50.H100.FS32

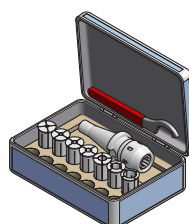

#### ACCESSORI - ACCESSORIES



**P. 276**  
PINZE  
COLLETS



**P. 289**  
CHIAVI  
WRENCHES



**P. 310**  
SUPPORTI DI MONTAGGIO  
ASSEMBLY DEVICES



**P. 234**  
TIRANTI  
PULL STUDS





### MANDRINI A FORTE SERRAGGIO - ECO LINE

POWER MILLING CHUCKS - ECO LINE

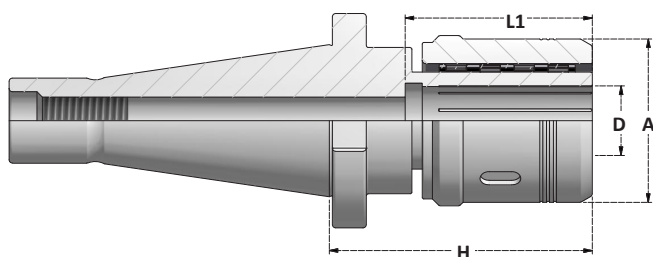

**G6,3**

12000 r.p.m.



0,010



Articolo	H
<b>ISO40.H105.MC20</b>	105
<b>ISO40.H105.MC32</b>	105

	D	A	L1	Momento torcente consigliato Recommended tightening torque
...MC20	20	58	65	60Nm
...MC32	32	73	80	70Nm

Articolo	H
<b>ISO50.H110.MC20</b>	110
<b>ISO50.H110.MC32</b>	110

Forza di serraggio  
Clamping force

MC20	<b>350Nm</b>
MC32	<b>450Nm</b>

#### ACCESSORI - ACCESSORIES



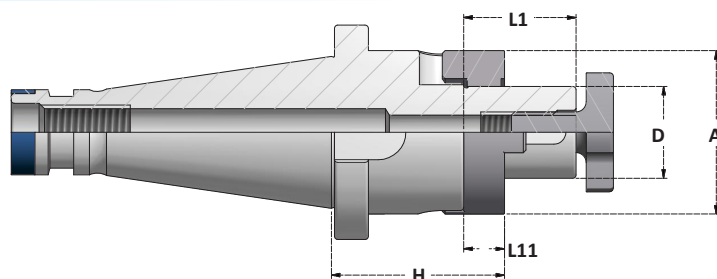

**MANDRINI PORTAFRESA COMBINATI**  
*COMBI SHELL MILL HOLDERS*

SCHEDA TECNICA
TECHNICAL DATA
D C   P. 348



Articolo	H
<b>ISO30.H50.D16C</b>	50
<b>ISO30.H50.D22C</b>	50
<b>ISO30.H50.D27C</b>	50
<b>ISO30.H50.D32C</b>	50

Articolo	H
<b>ISO40.H52.D16C</b>	52
<b>ISO40.H100.D16C</b>	100
<b>ISO40.H52.D22C</b>	52
<b>ISO40.H100.D22C</b>	100
<b>ISO40.H52.D27C</b>	52
<b>ISO40.H100.D27C</b>	100
<b>ISO40.H52.D32C</b>	52
<b>ISO40.H100.D32C</b>	100
<b>ISO40.H52.D40C</b>	52
<b>ISO40.H100.D40C</b>	100

Articolo	H
<b>ISO50.H55.D16C</b>	55
<b>ISO50.H100.D16C</b>	100
<b>ISO50.H125.D16C</b>	125
<b>ISO50.H55.D22C</b>	55
<b>ISO50.H100.D22C</b>	100
<b>ISO50.H125.D22C</b>	125
<b>ISO50.H55.D27C</b>	55
<b>ISO50.H100.D27C</b>	100
<b>ISO50.H125.D27C</b>	125
<b>ISO50.H55.D32C</b>	55
<b>ISO50.H100.D32C</b>	100
<b>ISO50.H125.D32C</b>	125
<b>ISO50.H55.D40C</b>	55
<b>ISO50.H100.D40C</b>	100
<b>ISO50.H125.D40C</b>	125

	D	A	L1	L11	ATR	VTC	CHV
<b>D16C</b>	16	32	27	10	ATR.D16	VTC.D16	CHV.D16
<b>D22C</b>	22	40	31	12	ATR.D22	VTC.D22	CHV.D22
<b>D27C</b>	27	48	33	12	ATR.D27	VTC.D27	CHV.D27
<b>D32C</b>	32	58	38	14	ATR.D32	VTC.D32	CHV.D32
<b>D40C</b>	40	70	41	14	ATR.D40	VTC.D40	CHV.D40

**ACCESSORI - ACCESSORIES**

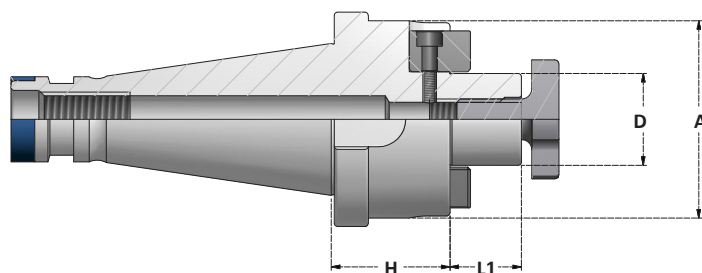
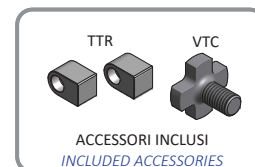
**MANDRINI PORTAFRESA FISSI**  
SHELL MILL HOLDERS**G6,3**  
8000r.p.m.SCHEDA TECNICA  
TECHNICAL DATA  
D S | P. 349ACCESSORI INCLUSI  
INCLUDED ACCESSORIES

Articolo	H
ISO30.H35.D16S	35
ISO30.H35.D22S	35
ISO30.H35.D27S	35
ISO30.H35.D32S	35

	D	A	L1	TTR	VTC
...D16S	16	38	17	TTR.D16	VTC.D16
...D22S	22	48	19	TTR.D22	VTC.D22
...D27S	27	58	21	TTR.D27	VTC.D27
...D32S	32	78	24	TTR.D32	VTC.D32
...D40S	40	88	27	TTR.D40	VTC.D40
...D60S	60	29	40	TTR.D60	VTC.D60

Articolo	H
ISO40.H30.D16S	30
ISO40.H52.D16S	52
ISO40.H100.D16S	100
ISO40.H35.D22S	35
ISO40.H52.D22S	52
ISO40.H100.D22S	100
ISO40.H35.D27S	35
ISO40.H52.D27S	52
ISO40.H100.D27S	100
ISO40.H35.D32S	35
ISO40.H52.D32S	52
ISO40.H100.D32S	100
ISO40.H35.D40S	35
ISO40.H52.D40S	52
ISO40.H100.D40S	100

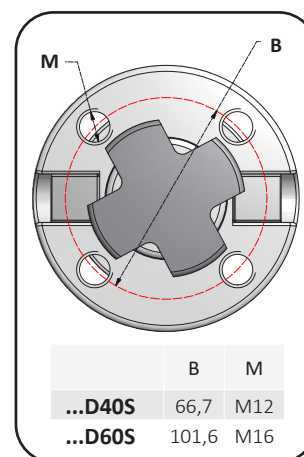

	B	M
...D40S	66,7	M12
...D60S	101,6	M16

Articolo	H
ISO50.H45.D16S	45
ISO50.H100.D16S	100
ISO50.H125.D16S	125
ISO50.H45.D22S	45
ISO50.H100.D22S	100
ISO50.H125.D22S	125
ISO50.H45.D27S	45
ISO50.H100.D27S	100
ISO50.H125.D27S	125
ISO50.H45.D32S	45
ISO50.H100.D32S	100
ISO50.H125.D32S	125
ISO50.H45.D40S	45
ISO50.H100.D40S	100
ISO50.H125.D40S	125
ISO50.H55.D60S	55

## ACCESSORI - ACCESSORIES

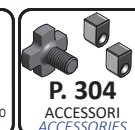
**P. 310**SUPPORTI DI MONTAGGIO  
ASSEMBLY DEVICES**P. 304**ACCESSORI  
ACCESSORIES

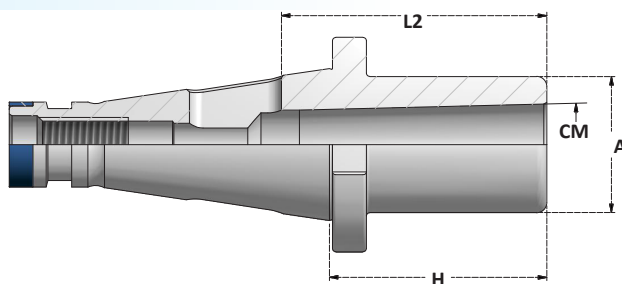
**MANDRINI DI RIDUZIONE CONO MORSE PER PUNTE**  
*MORSE TAPER ADAPTERS FOR DRILLS*SCHEDA TECNICA  
TECHNICAL DATA  
CM P | P. 350**PER UTENSILI DIN228B  
CON TENONE***FOR TOOLS DIN228B  
WITH TANG*

Articolo	H
ISO30.H50.CM1P	50
ISO30.H50.CM2P	50
ISO30.H72.CM3P	72

Articolo	H
ISO40.H50.CM1P	50
ISO40.H50.CM2P	50
ISO40.H65.CM3P	65
ISO40.H129.CM3P	129
ISO40.H95.CM4P	95
ISO40.H152.CM4P	152

Articolo	H
ISO50.H45.CM1P	45
ISO50.H100.CM1P	100
ISO50.H60.CM2P	60
ISO50.H113.CM2P	113
ISO50.H65.CM3P	65
ISO50.H133.CM3P	133
ISO50.H70.CM4P	70
ISO50.H163.CM4P	163
ISO50.H105.CM5P	105
ISO50.H193.CM5P	193

	CM	A	L2
...CM1P	1	25	56
...CM2P	2	32	67
...CM3P	3	40	84
...CM4P	4	48	107
...CM5P	5	63	135

ACCESSORI - ACCESSORIES

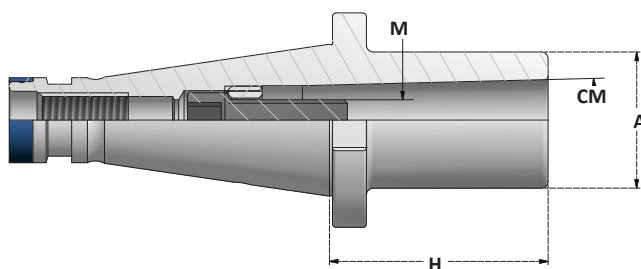
**MANDRINI DI RIDUZIONE CONO MORSE PER FRESE**  
*MORSE TAPER ADAPTERS FOR THREADED MILLS*SCHEDA TECNICA  
TECHNICAL DATA  
CMFV | P. 351**PER UTENSILI DIN228A  
CON FILETTO***FOR TOOLS DIN228A  
WITH THREAD*

Articolo	H
ISO30.H50.CM1FV	50
ISO30.H50.CM2FV	50
ISO30.H78.CM3FV	78

Articolo	H
ISO40.H50.CM1FV	50
ISO40.H50.CM2FV	50
ISO40.H65.CM3FV	65
ISO40.H95.CM4FV	95

Articolo	H
ISO50.H60.CM1FV	60
ISO50.H60.CM2FV	60
ISO50.H115.CM2FV	115
ISO50.H165.CM2FV	165
ISO50.H65.CM3FV	65
ISO50.H165.CM3FV	165
ISO50.H65.CM4FV	65
ISO50.H165.CM4FV	165
ISO50.H120.CM5FV	120

	CM	A	M
...CM1FV	1	25	M6
...CM2FV	2	32	M10
...CM3FV	3	40	M12
...CM4FV	4	48	M16
...CM5FV	5	63	M20

ACCESSORI - ACCESSORIES

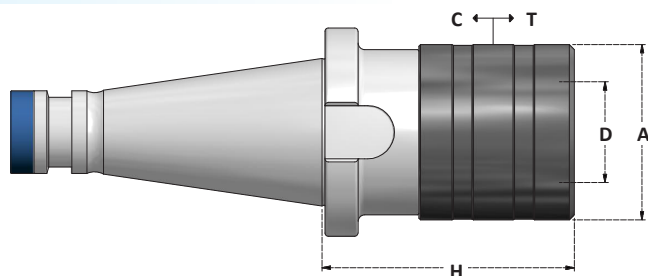

**MASCHIATORI A CAMBIO RAPIDO CON COMPENSAZIONE ASSIALE**  
*QUICK CHANGE TAPPING CHUCKS WITH AXIAL COMPENSATION*

SCHEDA TECNICA  
TECHNICAL DATA  
MCR | P. 352

Corsa di compressione: **C**  
*Compression stroke:*

Corsa di trazione: **T**  
*Extension stroke:*

Articolo	H
<b>ISO40.MCR1TC</b>	50
<b>ISO40.MCR2TC</b>	78
<b>ISO40.MCR3TC</b>	143

Articolo	H
<b>ISO50.MCR2TC</b>	80
<b>ISO50.MCR3TC</b>	130

	Bussola Adapter	D	Tapping Range	A	T	C
<b>..MCR1TC</b>	B1 / BF1	19	M2÷M14	36	7,5	7,5
<b>..MCR2TC</b>	B2 / BF2	31	M6÷M27	53	12,5	12,5
<b>..MCR3TC</b>	B3 / BF3	48	M14÷M45	78	20	20
<b>..MCR4TC</b>	BF4	60	M22÷M45	96	22,5	22,5

**ACCESSORI - ACCESSORIES**



**MANDRINI PORTAPUNTA CON PASSAGGIO DEL REFRIGERANTE**  
**ROTAZIONE DESTRA E SINISTRA**

*DRILL CHUCKS WITH COOLANT THROUGH - RIGHT AND LEFT ROTATION*

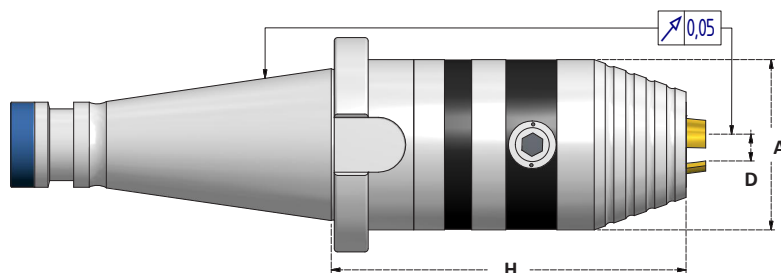
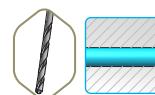

Articolo	H
<b>ISO40.H71.CP8S</b>	71
<b>ISO40.H105.CP13S</b>	105
<b>ISO40.H110.CP16S</b>	110

Articolo	H
<b>ISO50.H98.CP13S</b>	98
<b>ISO50.H103.CP16S</b>	103

**GRIFFE RIVESTITE  
IN TITANIO**  
  
*TITANIUM  
COATED JAWS*

	D	A	Chiave Wrench
<b>...CP8</b>	0,5 - 8	37,5	CH.EX4
<b>...CP13</b>	1 - 13	50,5	CH.EX6
<b>...CP16</b>	2,5 - 16	57	CH.EX6

**ACCESSORI - ACCESSORIES**

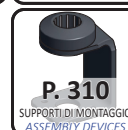

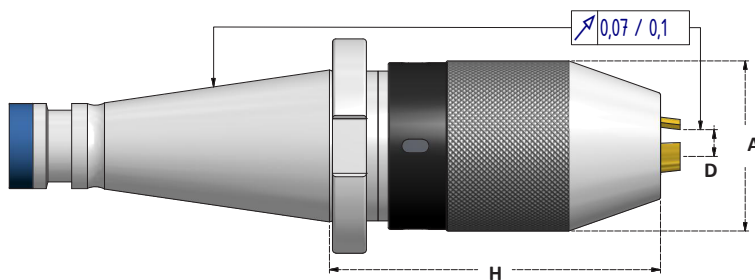
**MANDRINI PORTAPUNTA AUTOSERRANTI - ROTAZIONE DESTRA**  
*DRILL CHUCKS - RIGHT ROTATION*

Articolo	H
<b>ISO40.H70.DCK8S</b>	70
<b>ISO40.H88.DCK13S</b>	88
<b>ISO40.H100.DCK16S</b>	100

Articolo	H
<b>ISO50.H80.DCK13S</b>	80
<b>ISO50.H90.DCK16S</b>	90

**GRIFFE RIVESTITE  
IN TITANIO****TITANIUM  
COATED JAWS**

	D	A	Chiave Wrench
<b>...DCK8</b>	0,5 - 8	37,5	CH.DC8
<b>...DCK13</b>	1 - 13	50,5	CH.DC13
<b>...DCK16</b>	2,5 - 16	57	CH.DC16

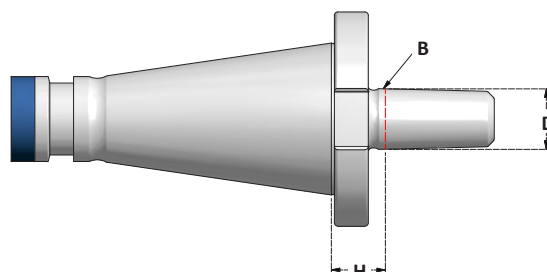
**ACCESSORI - ACCESSORIES****ATTACCHI PER MANDRINI AUTOSERRANTI**  
*DRILL CHUCKS ARBORS*

Articolo	H
<b>ISO30.H15.B12</b>	15
<b>ISO30.H15.B16</b>	15

Articolo	H
<b>ISO40.H17.B12</b>	17
<b>ISO40.H17.B16</b>	17
<b>ISO40.H17.B18</b>	17

Articolo	H
<b>ISO50.H20.B16</b>	20
<b>ISO50.H20.B18</b>	20

B	D
<b>...B12</b>	12,065
<b>...B16</b>	15,733
<b>...B18</b>	17,78

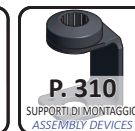
**ACCESSORI - ACCESSORIES**

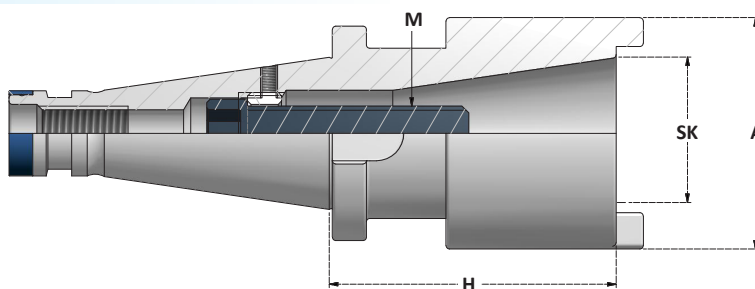
**MANDRINI DI RIDUZIONE TC-BT-ISO***TC-BT-ISO REDUCTION SLEEVES*

**TC** DIN ISO 7388 (DIN69871)  
**BT** MAS 403 (JIS B 6339)  
**ISO** DIN 2080

Articolo	H	A	M	SK
<b>ISO40.H50.TB30</b>	50	50	12	TC30 / BT30
<b>ISO40.H85.TB40</b>	85	70	16	TC40 / BT40

Articolo	H	A	M	SK
<b>ISO40.H50.ISO30</b>	50	50	12	ISO30
<b>ISO40.H85.ISO40</b>	85	70	16	ISO40

Articolo	H	A	M	SK
<b>ISO50.H60.TB40</b>	60	70	16	TC40 / BT40
<b>ISO50.H115.TB50</b>	115	90	24	TC50 / BT50

Articolo	H	A	M	SK
<b>ISO50.H60.ISO40</b>	60	70	16	ISO40
<b>ISO50.H115.ISO50</b>	115	90	24	ISO50

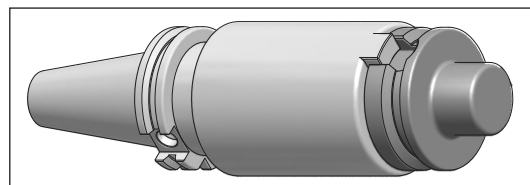

**FORNITI CON VITE SENZA  
FORO PER IL PASSAGGIO DEL  
REFRIGERANTE**

*SUPPLIED WITH SCREW WITHOUT  
COOLANT THROUGH*

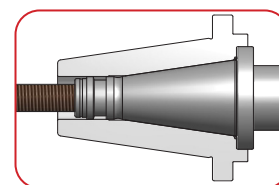
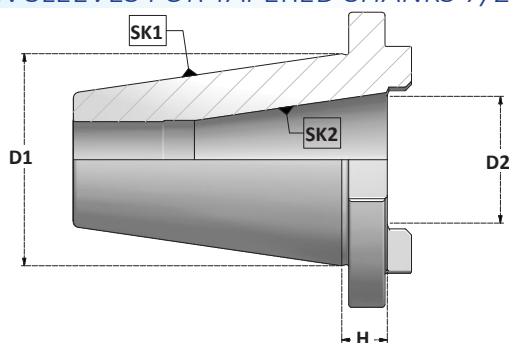
**BUSSE DI RIDUZIONE PER ATTACCHI CONICI 7/24 (8°17'50")***REDUCTION SLEEVES FOR TAPERED SHANKS 7/24 (8°17'50")*

Articolo	H	SK1	D1	SK2	D2
<b>ISO40.H13.SK30</b>	13	ISO40	44,45	ISO30	31,75
<b>ISO50.H16.SK30</b>	16	ISO50	69,85	ISO30	31,75
<b>ISO50.H16.SK40</b>	16	ISO50	69,85	ISO40	44,45

ACCESSORI - ACCESSORIES

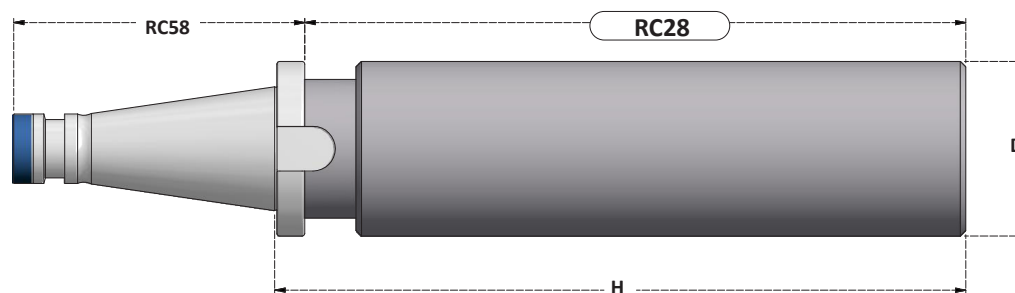

**MANDRINI CON STELO LAVORABILE***BLANK ARBORS*

Articolo	D	H
ISO40.H250.D40BL	40	250
ISO40.H160.D63BL	63	160
ISO40.H250.D63BL	63	250
ISO40.H270.D80BL	80	270

Articolo	D	H
ISO50.H330.D50BL	50	330
ISO50.H250.D63BL	63	250
ISO50.H330.D80BL	80	330
ISO50.H315.D97BL	97	315

