

MANDRINI ISO
ISO TOOLHOLDERS

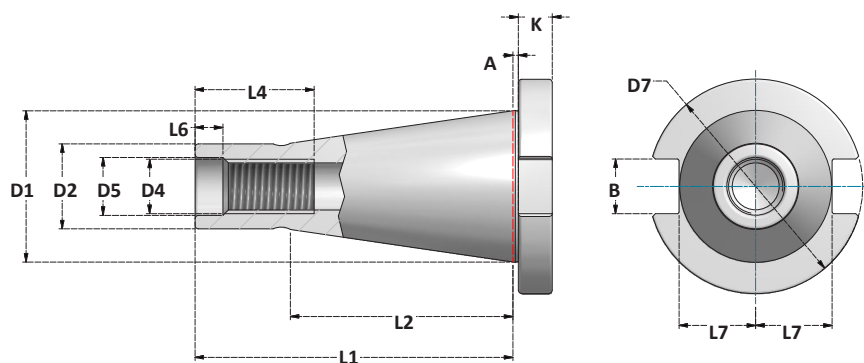

DIMENSIONI CONO
TAPER DIMENSIONS

CONO / TAPER	A	B	D1	D2	D4	D5	D7	L1	L2	L4	L6	L7	K	
	±0,2	H12					$\begin{matrix} 0 \\ -0,4 \end{matrix}$				$\begin{matrix} +0,5 \\ 0 \end{matrix}$	max	±0,15	
30	1,6	16,1	31,75	17,4	M12	13	50	68,4	48,4	24	5,5	16,2	8	
40	1,6	16,1	44,45	25,3	M16	17	63	93,4	65,4	32	8,2	22,5	10	OTT
50	3,2	25,7	69,85	39,6	M24	26	97,5	126,8	101,8	47	11,5	35,3	12	

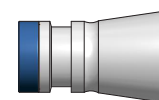

GOLA MAHO - OTT
MAHO - OTT GROOVE

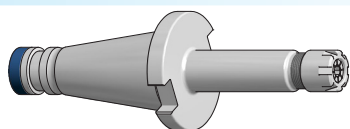

MANDRINI PORTAPINZA ER - GHIERE MINI
COLLET CHUCKS ER - MINI NUTS

DIN ISO 15488 (DIN6499)

PAG. 168

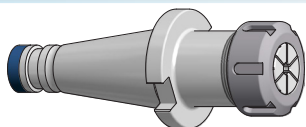

MANDRINI PORTAPINZA ER - GHIERE STANDARD
COLLET CHUCKS ER - STANDARD NUTS

DIN ISO 15488 (DIN6499)

PAG. 169

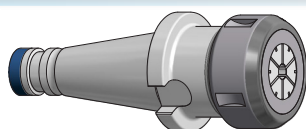

MANDRINI PORTAPINZA EOC
COLLET CHUCKS EOC

DIN ISO 10897 (DIN6388)

PAG. 171

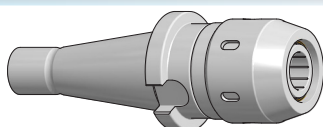

MANDRINI A FORTE SERRAGGIO
POWER MILLING CHUCKS

PAG. 172

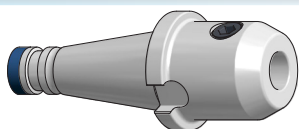

MANDRINI PORTAFRESA WELDON
END MILL HOLDERS WELDON

DIN 1835-2

PAG. 173

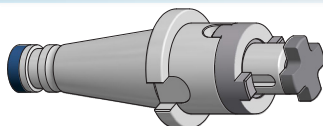

MANDRINI PORTAFRESA COMBI
COMBI SHELL MILL HOLDERS

DIN 6358

PAG. 174

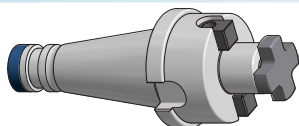

MANDRINI PORTAFRESA FISSI
SHELL MILL HOLDERS

DIN 6357

PAG. 175

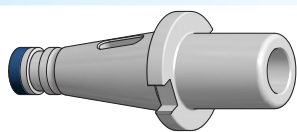
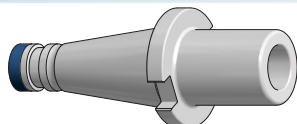
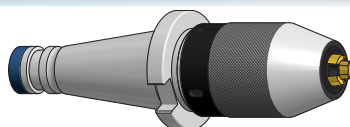
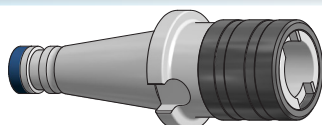
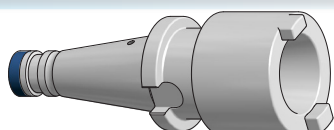
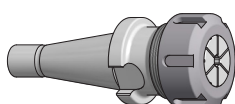
**RIDUZIONI A CONO MORSE PER PUNTE**
*MORSE TAPER ADAPTERS FOR DRILLS***DIN 6383***PAG. 177***RIDUZIONI A CONO MORSE PER FRESE**
*MORSE TAPER ADAPTERS FOR THREADED MILLS***DIN 6364***PAG. 178***MANDRINI DA TRAPANO**
*DRILL CHUCKS**PAG. 179***PORTAMASCHI**
*TAPPING CHUCKS**PAG. 183***RIDUZIONI**
*ADAPTERS**PAG. 185***MANDRINI CON STELO LAVORABILE**
*BLANK ARBORS**PAG. 186***BARRE DI COLLAUDO**
*TEST ARBORS**PAG. 187***MANDRINI NMTB PORTAPINZA ER**
*NMTB ER COLLET CHUCKS***ANSI B5.18 / USA***PAG. 188*

MANDRINI PORTAPINZA ER
ER COLLET CHUCKS

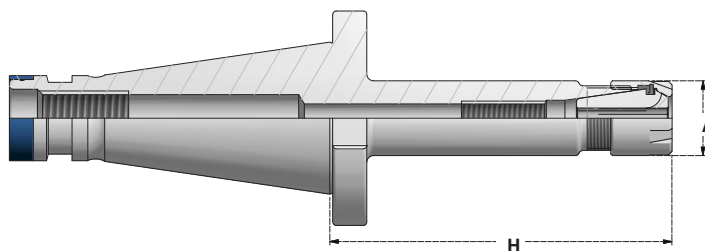

G6,3
8000 r.p.m.

Articolo	H	A	Collets Range	Ghiera Nut
ISO30.H100.ERC8M	100	12	1÷5	G8M
ISO30.H100.ERC11M	100	16	1÷7	G11M
ISO30.H100.ERC16M	100	22	1÷10	G16M
ISO30.H100.ERC20M	100	28	1÷14	G20M
ISO30.H100.ERC25M	100	35	1÷20	G25M



G6,3
8000 r.p.m.

Articolo	H	A	Collets Range	Ghiera Nut
ISO40.H100.ERC11M	100	16	1÷7	G11M
ISO40.H100.ERC16M	100	22	1÷10	G16M
ISO40.H100.ERC20M	100	28	1÷14	G20M
ISO40.H100.ERC25M	100	35	1÷20	G25M

ACCESSORI - ACCESSORIES

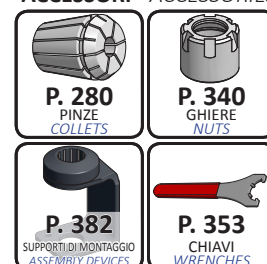

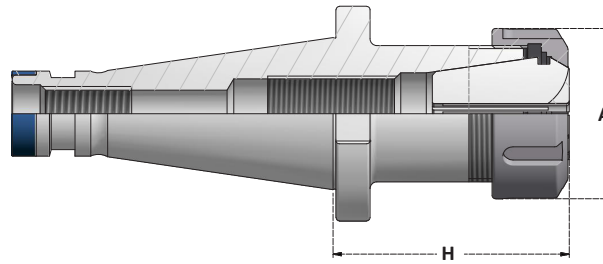
MANDRINI PORTAPINZA ER
ER COLLET CHUCKS

G6,3
 8000rp.m.

Articolo	H	A	Collets Range	Ghiera Nut
ISO30.H50.ERC16	50	28	1÷10	G16SE
ISO30.H70.ERC16	70	28	1÷10	G16SE
ISO30.H100.ERC16	100	28	1÷10	G16SE
ISO30.H50.ERC20	50	34	1÷14	G20SE
ISO30.H70.ERC20	70	34	1÷14	G20SE
ISO30.H100.ERC20	100	34	1÷14	G20SE
ISO30.H50.ERC25	50	42	1÷20	G25S
ISO30.H70.ERC25	70	42	1÷20	G25S
ISO30.H100.ERC25	100	42	1÷20	G25S
ISO30.H50.ERC32	50	50	2÷22	G32S
ISO30.H70.ERC32	70	50	2÷22	G32S
ISO30.H100.ERC32	100	50	2÷22	G32S
ISO30.H70.ERC40	70	63	3÷30	G40S
ISO30.H84.ERC40	84	63	3÷30	G40S
ISO30.H100.ERC40	100	63	3÷30	G40S

G6,3
 8000rp.m.

Articolo	H	A	Collets Range	Ghiera Nut
ISO40.H50.ERC16	50	28	1÷10	G16SE
ISO40.H70.ERC16	70	28	1÷10	G16SE
ISO40.H100.ERC16	100	28	1÷10	G16SE
ISO40.H50.ERC20	50	34	1÷14	G20SE
ISO40.H70.ERC20	70	34	1÷14	G20SE
ISO40.H100.ERC20	100	34	1÷14	G20SE
ISO40.H50.ERC25	50	42	1÷20	G25S
ISO40.H70.ERC25	70	42	1÷20	G25S
ISO40.H100.ERC25	100	42	1÷20	G25S
ISO40.H130.ERC25	130	42	1÷20	G25S
ISO40.H50.ERC32	50	50	2÷22	G32S
ISO40.H70.ERC32	70	50	2÷22	G32S
ISO40.H100.ERC32	100	50	2÷22	G32S
ISO40.H130.ERC32	130	50	2÷22	G32S
ISO40.H160.ERC32	160	50	2÷22	G32S
ISO40.H56.ERC40	56	63	3÷30	G40S
ISO40.H70.ERC40	70	63	3÷30	G40S
ISO40.H100.ERC40	100	63	3÷30	G40S
ISO40.H130.ERC40	130	63	3÷30	G40S
ISO40.H160.ERC40	160	63	3÷30	G40S
ISO40.H200.ERC40	200	63	3÷30	G40S
ISO40.H100.ERC50	100	78	6÷34	G50S

SE

 GHIERE **STANDARD** ESAGONALI
*HEXAGONAL **STANDARD** NUTS*

S

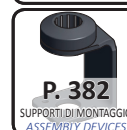
 GHIERE **STANDARD** CON TACCHE
***STANDARD** NUTS WITH SLOTS*
ACCESSORI - ACCESSORIES

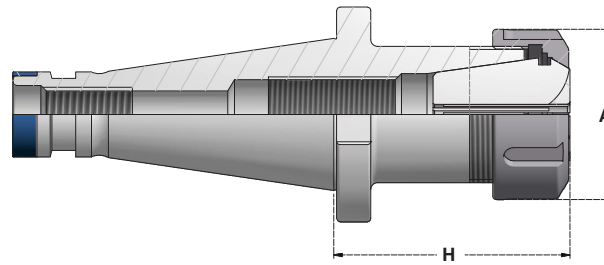
MANDRINI PORTAPINZA ER
ER COLLET CHUCKS

G6,3
8000rp.m.

Articolo	H	A	Collets Range	Ghiera Nut
ISO50.H70.ERC16	70	28	1÷10	G16SE
ISO50.H100.ERC16	100	28	1÷10	G16SE
ISO50.H130.ERC16	130	28	1÷10	G16SE
ISO50.H70.ERC20	70	34	1÷14	G20SE
ISO50.H100.ERC20	100	34	1÷14	G20SE
ISO50.H130.ERC20	130	34	1÷14	G20SE
ISO50.H70.ERC25	70	42	1÷20	G25S
ISO50.H100.ERC25	100	42	1÷20	G25S
ISO50.H130.ERC25	130	42	1÷20	G25S
ISO50.H160.ERC25	160	42	1÷20	G25S
ISO50.H70.ERC32	70	50	2÷22	G32S
ISO50.H100.ERC32	100	50	2÷22	G32S
ISO50.H130.ERC32	130	50	2÷22	G32S
ISO50.H160.ERC32	160	50	2÷22	G32S
ISO50.H200.ERC32	200	50	2÷22	G32S
ISO50.H70.ERC40	70	63	3÷30	G40S
ISO50.H100.ERC40	100	63	3÷30	G40S
ISO50.H130.ERC40	130	63	3÷30	G40S
ISO50.H160.ERC40	160	63	3÷30	G40S
ISO50.H200.ERC40	200	63	3÷30	G40S
ISO50.H67.ERC50	67	78	6÷34	G50S
ISO50.H83.ERC60	83	83	10÷40	G60C

SE

 GHIERE **STANDARD** ESAGONALI
HEXAGONAL STANDARD NUTS
S

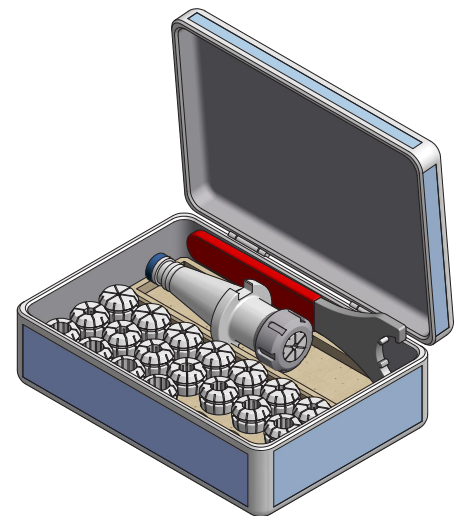
 GHIERE **STANDARD** CON TACCHE
STANDARD NUTS WITH SLOTS
C

 GHIERE A SFERE CON TACCHE
FRICTION BEARING NUTS WITH SLOTS

KIT - MANDRINO, CHIAVE E PINZE
KIT - TOOLHOLDER, WRENCH AND COLLETS

Articolo	Pinze Collets	Mandrino Toolholder	Chiave Wrench
BX.ISO30.ERC32	ERC32.D3÷20 x 1,0mm	ISO30.H70.ERC32	CH32S
BX.ISO40.ERC32	ERC32.D3÷20 x 1,0mm	ISO40.H70.ERC32	CH32S
BX.ISO50.ERC32	ERC32.D3÷20 x 1,0mm	ISO50.H70.ERC32	CH32S
BX.ISO30.ERC40	ERC40.D4÷26 x 1,0mm	ISO30.H70.ERC40	CH40S
BX.ISO40.ERC40	ERC40.D4÷26 x 1,0mm	ISO40.H70.ERC40	CH40S
BX.ISO50.ERC40	ERC40.D4÷26 x 1,0mm	ISO50.H70.ERC40	CH40S

ALTRI A RICHIESTA
OTHERS ON REQUEST
ACCESSORI - ACCESSORIES

P. 280
PINZE
COLLETS

P. 341
GHIERE
NUTS

P. 382
SUPPORTI DI MONTAGGIO
ASSEMBLY DEVICES

P. 353
CHIAVI
WRENCHES

MANDRINI PORTAPINZA EOC

EOC COLLET CHUCKS

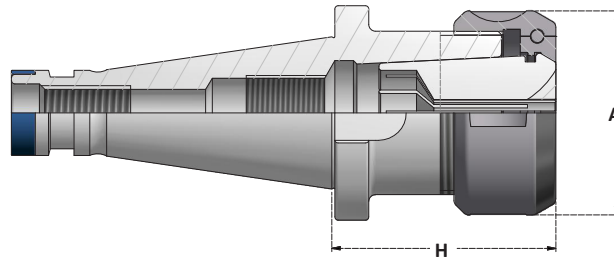

G6,3 8000 r.p.m.	Articolo	H	A	Collets Range	Ghiera Nut
	ISO40.H55.EOC16	55	43	2÷16	G16OCC
	ISO40.H66.EOC25	66	60	2÷25	G25OCC
	ISO40.H95.EOC32	95	72	3÷32	G32OCC

G6,3 8000 r.p.m.	Articolo	H	A	Collets Range	Ghiera Nut
	ISO50.H57.EOC25	57	60	2÷25	G25OCC
	ISO50.H73.EOC32	73	72	3÷32	G32OCC

ACCESSORI - ACCESSORIES

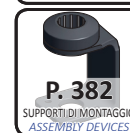

MANDRINI A FORTE SERRAGGIO

POWER MILLING CHUCKS

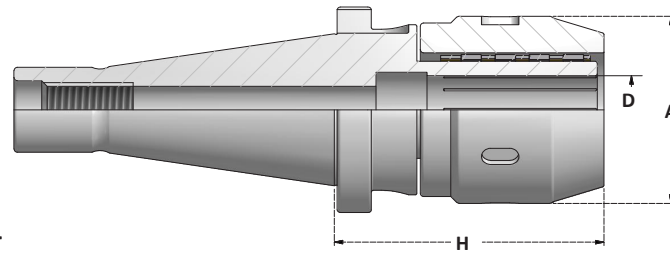

SENZA GOLA MAHO - OTT

WITHOUT MAHO - OTT GROOVE

G6,3 12000 r.p.m.	Articolo	D	H	A
	ISO40.H100.FS32	32	100	69
	ISO50.H100.FS32	32	100	69

I TAGLI LONGITUDINALI PER TUTTA LA LUNGHEZZA DELLA SEDE PORTAUTENSILE AUMENTANO LA FORZA DI SERRAGGIO MA NON PERMETTONO LA TOTALE TENUTA DEL LIQUIDO REFRIGERANTE.

LONGITUDINAL CUTS ALL ALONG THE SEAT OF THE TOOL INCREASE THE CLAMPING FORCE BUT DO NOT ALLOW TOTAL SEALING.

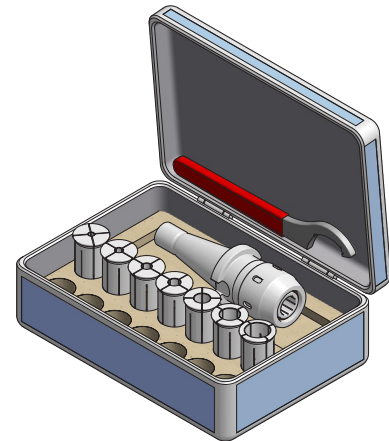

KIT - MANDRINO, CHIAVE E PINZE

KIT - TOOLHOLDER, WRENCH AND COLLETS

Articolo	Pinze Collets	Mandrino con chiave Toolholder with wrench
BX.ISO40.FS32	4SR32.D6-D8-D10-D12-D16-D20-D25	ISO40.H100.FS32
BX.ISO50.FS32	4SR32.D6-D8-D10-D12-D16-D20-D25	ISO50.H100.FS32

ACCESSORI - ACCESSORIES

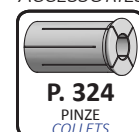

MANDRINI PORTAFRESA WELDON

END MILL HOLDERS WELDON

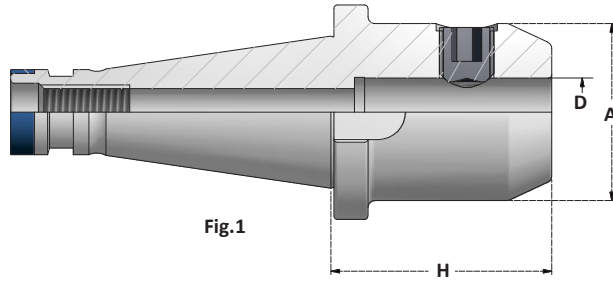

Fig.1

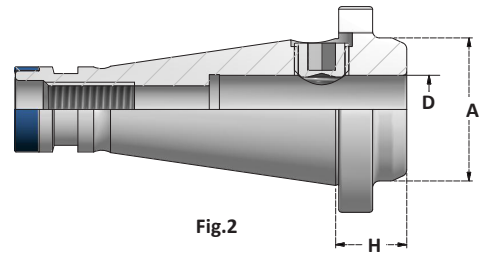
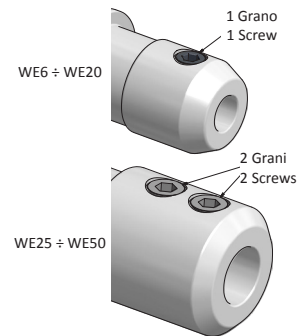

Fig.2

G6,3 8000 r.p.m.	Articolo	D	H	A	Grano Screw	Fig
	ISO30.H40.WE6	6	40	25	GR.WE6	1
	ISO30.H40.WE8	8	40	28	GR.WE8	1
	ISO30.H40.WE10	10	40	35	GR.WE10	1
	ISO30.H40.WE12	12	40	42	GR.WE12-14	1
	ISO30.H40.WE14	14	40	44	GR.WE12-14	1
	ISO30.H50.WE16	16	50	48	GR.WE16-18	1
	ISO30.H50.WE18	18	50	50	GR.WE16-18	1
	ISO30.H63.WE20	20	63	52	GR.WE20	1
ISO30.H85.WE25	25	85	65	GR.WE25	1	

G6,3 8000 r.p.m.	Articolo	D	H	A	Grano Screw	Fig
	ISO40.H50.WE6	6	50	25	GR.WE6	1
	ISO40.H50.WE8	8	50	28	GR.WE8	1
	ISO40.H50.WE10	10	50	35	GR.WE10	1
	ISO40.H50.WE12	12	50	42	GR.WE12-14	1
	ISO40.H50.WE14	14	50	44	GR.WE12-14	1
	ISO40.H60.WE16	16	60	48	GR.WE16-18	1
	ISO40.H65.WE18	18	65	50	GR.WE16-18	1
	ISO40.H65.WE20	20	65	52	GR.WE20	1
	ISO40.H80.WE25	25	80	65	GR.WE25	1
	ISO40.H80.WE32	32	80	72	GR.WE32-40	1
ISO40.H90.WE40	40	90	80	GR.WE32-40	1	

G6,3 8000 r.p.m.	Articolo	D	H	A	Grano Screw	Fig
	ISO50.H63.WE6	6	63	25	GR.WE6	1
	ISO50.H63.WE8	8	63	28	GR.WE8	1
	ISO50.H63.WE10	10	63	35	GR.WE10	1
	ISO50.H63.WE12	12	63	42	GR.WE12-14	1
	ISO50.H63.WE14	14	63	44	GR.WE12-14	1
	ISO50.H63.WE16	16	63	48	GR.WE16-18	1
	ISO50.H63.WE18	18	63	50	GR.WE16-18	1
	ISO50.H63.WE20	20	63	52	GR.WE20	1
	ISO50.H80.WE25	25	80	65	GR.WE25	1
	ISO50.H80.WE32	32	80	72	GR.WE32-40	1
	ISO50.H90.WE40	40	90	80	GR.WE32-40	1
	ISO50.H110.WE50	50	110	100	GR.WE50	1



MANDRINI PORTAFRESA WELDON - EXTRACORTI

END MILL HOLDERS WELDON - STUB LENGTH

G6,3 8000 r.p.m.	Articolo	D	H	A	Grano Screw	Fig
	ISO40.H22.WE16	16	22	48	GR.WEC16	2
	ISO40.H22.WE20	20	22	48	GR.WEC20	2
	ISO40.H22.WE25	25	22	48	GR.WEC20	2

ACCESSORI - ACCESSORIES

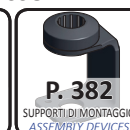

MANDRINI PORTAFRESA COMBINATI

COMBI SHELL MILL HOLDERS

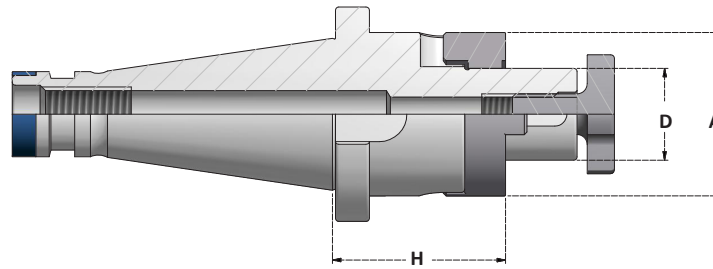

G6,3
8000 r.p.m.

Articolo	D	H	A	ATR	VTC	CHV
ISO30.H50.D16C	16	50	32	ATR.D16	VTC.D16	CHV.D16
ISO30.H50.D22C	22	50	40	ATR.D22	VTC.D22	CHV.D22
ISO30.H50.D27C	27	50	48	ATR.D27	VTC.D27	CHV.D27
ISO30.H50.D32C	32	50	58	ATR.D32	VTC.D32	CHV.D32

G6,3
8000 r.p.m.

Articolo	D	H	A	ATR	VTC	CHV
ISO40.H52.D16C	16	52	32	ATR.D16	VTC.D16	CHV.D16
ISO40.H100.D16C	16	100	32	ATR.D16	VTC.D16	CHV.D16
ISO40.H52.D22C	22	52	40	ATR.D22	VTC.D22	CHV.D22
ISO40.H100.D22C	22	100	40	ATR.D22	VTC.D22	CHV.D22
ISO40.H52.D27C	27	52	48	ATR.D27	VTC.D27	CHV.D27
ISO40.H100.D27C	27	100	48	ATR.D27	VTC.D27	CHV.D27
ISO40.H52.D32C	32	52	58	ATR.D32	VTC.D32	CHV.D32
ISO40.H100.D32C	32	100	58	ATR.D32	VTC.D32	CHV.D32
ISO40.H52.D40C	40	52	70	ATR.D40	VTC.D40	CHV.D40
ISO40.H100.D40C	40	100	70	ATR.D40	VTC.D40	CHV.D40

G6,3
8000 r.p.m.

Articolo	D	H	A	ATR	VTC	CHV
ISO50.H55.D16C	16	55	32	ATR.D16	VTC.D16	CHV.D16
ISO50.H100.D16C	16	100	32	ATR.D16	VTC.D16	CHV.D16
ISO50.H125.D16C	16	125	32	ATR.D16	VTC.D16	CHV.D16
ISO50.H55.D22C	22	55	40	ATR.D22	VTC.D22	CHV.D22
ISO50.H100.D22C	22	100	40	ATR.D22	VTC.D22	CHV.D22
ISO50.H125.D22C	22	125	40	ATR.D22	VTC.D22	CHV.D22
ISO50.H55.D27C	27	55	48	ATR.D27	VTC.D27	CHV.D27
ISO50.H100.D27C	27	100	48	ATR.D27	VTC.D27	CHV.D27
ISO50.H125.D27C	27	125	48	ATR.D27	VTC.D27	CHV.D27
ISO50.H55.D32C	32	55	58	ATR.D32	VTC.D32	CHV.D32
ISO50.H100.D32C	32	100	58	ATR.D32	VTC.D32	CHV.D32
ISO50.H125.D32C	32	125	58	ATR.D32	VTC.D32	CHV.D32
ISO50.H55.D40C	40	55	70	ATR.D40	VTC.D40	CHV.D40
ISO50.H100.D40C	40	100	70	ATR.D40	VTC.D40	CHV.D40
ISO50.H125.D40C	40	125	70	ATR.D40	VTC.D40	CHV.D40

ACCESSORI - ACCESSORIES



MANDRINI PORTAFRESA FISSI

SHELL MILL HOLDERS

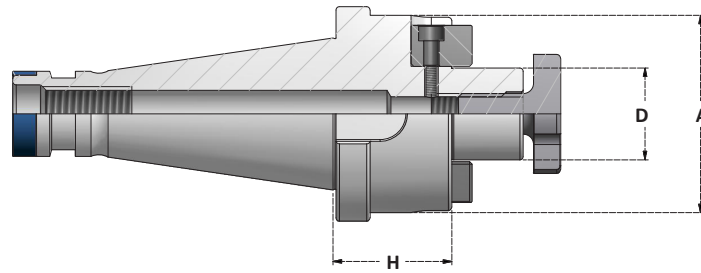

G6,3 8000 r.p.m.	Articolo	D	H	A	TTR	VTC
	ISO30.H35.D16S	16	35	38	TTR.D16	VTC.D16
	ISO30.H35.D22S	22	35	48	TTR.D22	VTC.D22
	ISO30.H35.D27S	27	35	58	TTR.D27	VTC.D27
	ISO30.H35.D32S	32	35	78	TTR.D32	VTC.D32

G6,3 8000 r.p.m.	Articolo	D	H	A	TTR	VTC
	ISO40.H30.D16S	16	30	38	TTR.D16	VTC.D16
	ISO40.H52.D16S	16	52	38	TTR.D16	VTC.D16
	ISO40.H100.D16S	16	100	38	TTR.D16	VTC.D16
	ISO40.H35.D22S	22	35	48	TTR.D22	VTC.D22
	ISO40.H52.D22S	22	52	48	TTR.D22	VTC.D22
	ISO40.H100.D22S	22	100	48	TTR.D22	VTC.D22
	ISO40.H35.D27S	27	35	58	TTR.D27	VTC.D27
	ISO40.H52.D27S	27	52	58	TTR.D27	VTC.D27
	ISO40.H100.D27S	27	100	58	TTR.D27	VTC.D27
	ISO40.H35.D32S	32	35	78	TTR.D32	VTC.D32
	ISO40.H52.D32S	32	52	78	TTR.D32	VTC.D32
	ISO40.H100.D32S	32	100	78	TTR.D32	VTC.D32
	ISO40.H35.D40S	40	35	88	TTR.D40	VTC.D40
	ISO40.H52.D40S	40	52	88	TTR.D40	VTC.D40
ISO40.H100.D40S	40	100	88	TTR.D40	VTC.D40	

MANDRINI PER FRESE A SPIANARE CON 4 FORI

FACE MILL HOLDERS WITH 4 HOLES

Articolo	D	H	A	M	B	TTR	VTC
ISO40.H35.D40FM	40	35	88	M12	66,7	TTR.D40	VTC.D40

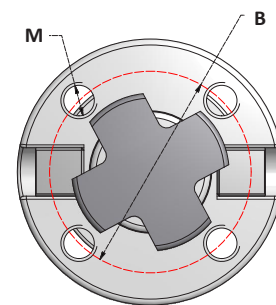

ACCESSORI - ACCESSORIES



MANDRINI PORTAFRESA FISSI

SHELL MILL HOLDERS

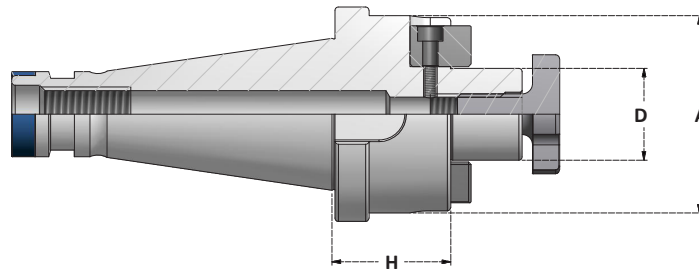

G6,3
8000 r.p.m.

Articolo	D	H	A	TTR	VTC
ISO50.H45.D16S	16	45	38	TTR.D16	VTC.D16
ISO50.H100.D16S	16	100	38	TTR.D16	VTC.D16
ISO50.H125.D16S	16	125	38	TTR.D16	VTC.D16
ISO50.H45.D22S	22	45	48	TTR.D22	VTC.D22
ISO50.H100.D22S	22	100	48	TTR.D22	VTC.D22
ISO50.H125.D22S	22	125	48	TTR.D22	VTC.D22
ISO50.H45.D27S	27	45	58	TTR.D27	VTC.D27
ISO50.H100.D27S	27	100	58	TTR.D27	VTC.D27
ISO50.H125.D27S	27	125	58	TTR.D27	VTC.D27
ISO50.H45.D32S	32	45	78	TTR.D32	VTC.D32
ISO50.H100.D32S	32	100	78	TTR.D32	VTC.D32
ISO50.H125.D32S	32	125	78	TTR.D32	VTC.D32
ISO50.H45.D40S	40	45	88	TTR.D40	VTC.D40
ISO50.H100.D40S	40	100	88	TTR.D40	VTC.D40
ISO50.H125.D40S	40	125	88	TTR.D40	VTC.D40

MANDRINI PER FRESE A SPIANARE CON 4 FORI

FACE MILL HOLDERS WITH 4 HOLES

Articolo	D	H	A	M	B	TTR	VTC
ISO50.H45.D40FM	40	45	88	M12	66,7	TTR.D40	VTC.D40
ISO50.H55.D60FM	60	55	129	M16	101,6	TTR.D60	VTC.D60

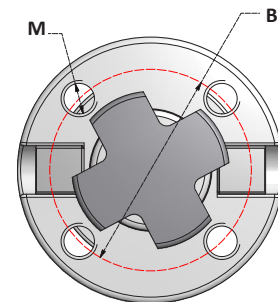

ACCESSORI - ACCESSORIES

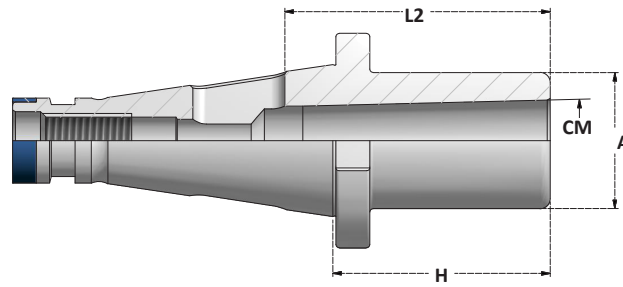

MANDRINI DI RIDUZIONE CONO MORSE PER PUNTE
MORSE TAPER ADAPTERS FOR DRILLS

G6,3 8000 r.p.m.	Articolo	CM	H	A	L2
	ISO30.H50.CM1P	CM1	50	25	56
	ISO30.H50.CM2P	CM2	50	32	67
	ISO30.H72.CM3P	CM3	72	40	84

G6,3 8000 r.p.m.	Articolo	CM	H	A	L2
	ISO40.H50.CM1P	CM1	50	25	56
	ISO40.H92.CM1P	CM1	92	25	56
	ISO40.H50.CM2P	CM2	50	32	67
	ISO40.H109.CM2P	CM2	109	32	67
	ISO40.H65.CM3P	CM3	65	40	84
	ISO40.H129.CMP	CM3	129	40	84
	ISO40.H95.CM4P	CM4	95	48	107
ISO40.H152.CM4P	CM4	152	48	107	

G6,3 8000 r.p.m.	Articolo	CM	H	A	L2
	ISO50.H45.CM1P	CM1	45	25	56
	ISO50.H100.CM1P	CM1	100	25	56
	ISO50.H60.CM2P	CM2	60	32	67
	ISO50.H113.CM2P	CM2	113	32	67
	ISO50.H65.CM3P	CM3	65	40	84
	ISO50.H133.CM3P	CM3	133	40	84
	ISO50.H70.CM4P	CM4	70	48	107
	ISO50.H163.CM4P	CM4	163	48	107
	ISO50.H105.CM5P	CM5	105	63	135
ISO50.H193.CM5P	CM5	193	63	135	

**PER UTENSILI DIN228B
CON TENONE**

*FOR TOOLS DIN228B
WITH TANG*

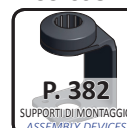
ACCESSORI - ACCESSORIES

MANDRINI DI RIDUZIONE CONO MORSE PER FRESE
MORSE TAPER ADAPTERS FOR THREADED MILLS

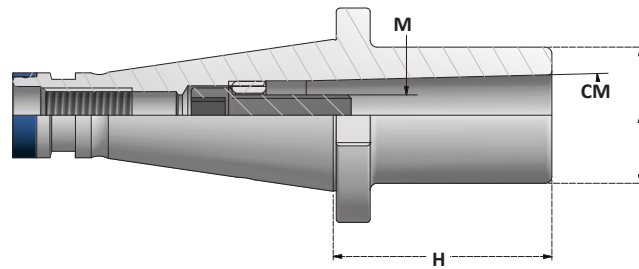

G6,3 8000 r.p.m.	Articolo	CM	H	A	M
	ISO30.H50.CM1FV	CM1	50	25	M6
	ISO30.H50.CM2FV	CM2	50	32	M10
	ISO30.H78.CM3FV	CM3	78	40	M12

G6,3 8000 r.p.m.	Articolo	CM	H	A	M
	ISO40.H50.CM1FV	CM1	50	25	M6
	ISO40.H50.CM2FV	CM2	50	32	M10
	ISO40.H65.CM3FV	CM3	65	40	M12
	ISO40.H95.CM4FV	CM4	95	48	M16

Articolo	CM	H	A	M
ISO50.H60.CM1FV	CM1	60	25	M6
ISO50.H60.CM2FV	CM2	60	32	M10
ISO50.H115.CM2FV	CM2	115	32	M10
ISO50.H165.CM2FV	CM2	165	32	M10
ISO50.H65.CM3FV	CM3	65	40	M12
ISO50.H165.CM3FV	CM3	165	40	M12
ISO50.H65.CM4FV	CM4	65	48	M16
ISO50.H165.CM4FV	CM4	165	48	M16
ISO50.H120.CM5FV	CM5	120	63	M20

G6,3 8000 r.p.m.	Articolo	CM	H	A	M
	ISO50.H60.CM1FV	CM1	60	25	M6
	ISO50.H60.CM2FV	CM2	60	32	M10
	ISO50.H115.CM2FV	CM2	115	32	M10
	ISO50.H165.CM2FV	CM2	165	32	M10
	ISO50.H65.CM3FV	CM3	65	40	M12
	ISO50.H165.CM3FV	CM3	165	40	M12
	ISO50.H65.CM4FV	CM4	65	48	M16
	ISO50.H165.CM4FV	CM4	165	48	M16
ISO50.H120.CM5FV	CM5	120	63	M20	

**PER UTENSILI DIN228A
CON FILETTO**
*FOR TOOLS DIN228A
WITH THREAD*

ACCESSORI - ACCESSORIES



ATTACCO PER MANDRINI PORTAPUNTE
DRILL CHUCKS ADAPTERS

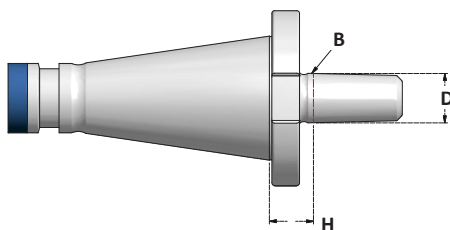

Articolo	B	H	D
ISO30.H15.B12	B12	15	12,065
ISO30.H15.B16	B16	15	15,733

Articolo	B	H	D
ISO40.H17.B12	B12	17	12,065
ISO40.H17.B16	B16	17	15,733
ISO40.H17.B18	B18	17	17,78

Articolo	B	H	D
ISO50.H20.B16	B16	20	15,733
ISO50.H20.B18	B18	20	17,78

ACCESSORI - ACCESSORIES

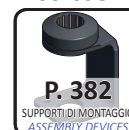

MANDRINI PORTAPUNTA AUTOSERRANTI - ROTAZIONE DESTRA
DRILL CHUCKS - RIGHT ROTATION

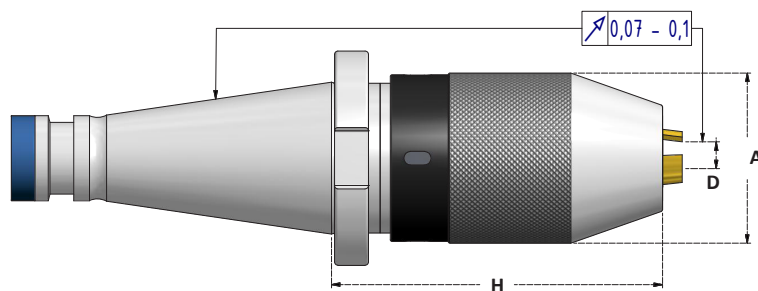

Articolo	D	H	A	Chiave Wrench
ISO40.H70.DCK8S	0,5 - 8	70	37,5	CH.DC8
ISO40.H88.DCK13S	1 - 13	88	50,5	CH.DC13
ISO40.H100.DCK16S	2,5 - 16	100	57	CH.DC16

**GRIFFE RIVESTITE
IN TITANIO**

**TITANIUM
COATED JAWS**

Articolo	D	H	A	Chiave Wrench
ISO50.H80.DCK13S	1 - 13	80	50,5	CH.DC13
ISO50.H90.DCK16S	2,5 - 16	90	57	CH.DC16

ACCESSORI - ACCESSORIES



MANDRINI PORTAPUNTA AUTOSERRANTI - ROTAZIONE DESTRA E SINISTRA
DRILL CHUCKS - RIGHT AND LEFT ROTATION

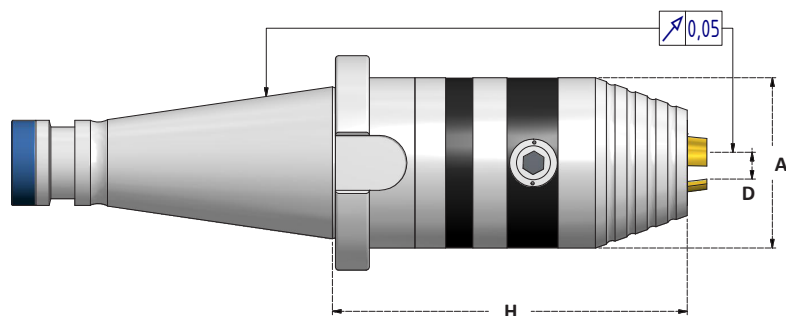

Articolo	D	H	A	Chiave Wrench
ISO40.H71.CP8S	0,5 - 8	71	37,5	CH.CP8
ISO40.H105.CP13S	1 - 13	105	50,5	CH.CP13-16
ISO40.H110.CP16S	2,5 - 16	110	57	CH.CP13-16

Articolo	D	H	A	Chiave Wrench
ISO50.H98.CP13S	1 - 13	98	50,5	CH.CP13-16
ISO50.H103.CP16S	2,5 - 16	103	57	CH.CP13-16

**GRIFFE RIVESTITE
IN TITANIO**

**TITANIUM
COATED JAWS**

ACCESSORI - ACCESSORIES

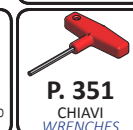

MANDRINI PORTAPUNTA AUTOSERRANTI - ROTAZIONE DESTRA E SINISTRA
DRILL CHUCKS - RIGHT AND LEFT ROTATION

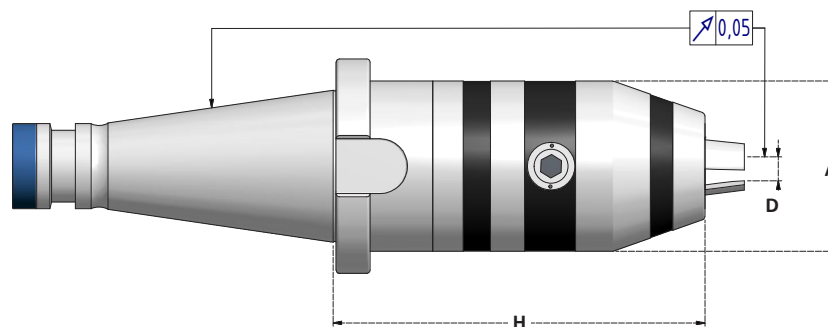

Articolo	D	H	A	Chiave Wrench
ISO40.H62.HD8	0,5- 8	62	36	CH.HD8
ISO40.H82.HD13	0,5-13	82	50	CH.HD13-16
ISO40.H87.HD16	2,5-13	87	50	CH.HD13-16

Articolo	D	H	A	Chiave Wrench
ISO50.H86.HD13	0,5-13	86	50	CH.HD13-16
ISO50.H91.HD16	2,5-13	91	50	CH.HD13-16

ACCESSORI - ACCESSORIES

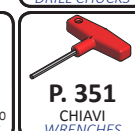

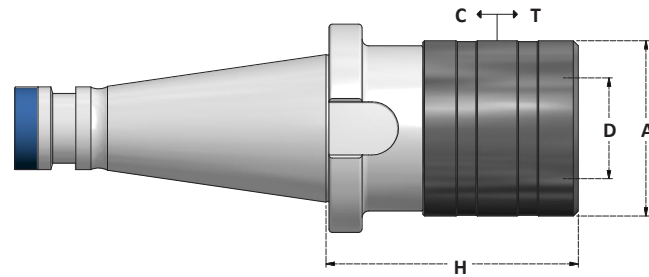
**MASCHIATORI A CAMBIO RAPIDO
CON COMPENSAZIONE ASSIALE A TRAZIONE E COMPRESIONE**
QUICK CHANGE TAPPING CHUCKS WITH AXIAL COMPENSATION

Articolo	Bussola Adapter	D	Tapping Range	A	H	T	C
ISO40.MCR1TC	B1 / BF1	19	M3÷M12	36	50	7,5	7,5
ISO40.MCR2TC	B2 / BF2	31	M6÷M20	53	78	12,5	12,5
ISO40.MCR3TC	B3 / BF3	48	M14÷M33	78	143	20	20

Articolo	Bussola Adapter	D	Tapping Range	A	H	T	C
ISO50.MCR2TC	B2 / BF2	31	M6÷M20	53	80	12,5	12,5
ISO50.MCR3TC	B3 / BF3	48	M14÷M33	78	130	20	20

ACCESSORI - ACCESSORIES

MANDRINI DI RIDUZIONE TC-BT-ISO

TC-BT-ISO REDUCTION SLEEVES

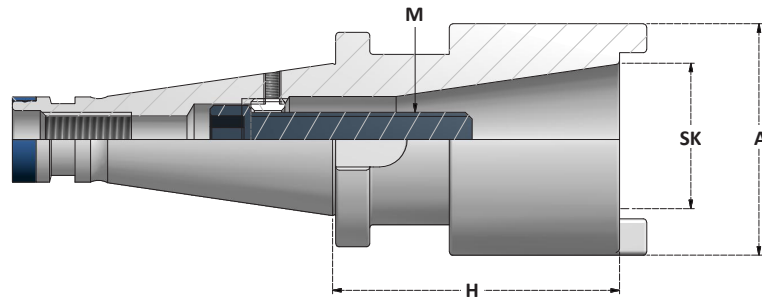

Articolo	H	A	M	SK
ISO40.H50.TB30	50	50	12	TC30 / BT30
ISO40.H85.TB40	85	70	16	TC40 / BT40

Articolo	H	A	M	SK
ISO40.H50.ISO30	50	50	12	ISO30
ISO40.H85.ISO40	85	70	16	ISO40

Articolo	H	A	M	SK
ISO50.H60.TB40	60	70	16	TC40 / BT40
ISO50.H115.TB50	115	90	24	TC50 / BT50

Articolo	H	A	M	SK
ISO50.H60.ISO40	60	70	16	ISO40
ISO50.H115.ISO50	115	90	24	ISO50

MANDRINI DI RIDUZIONE - EXTRACORTI

REDUCTION SLEEVES - STUB LENGTH

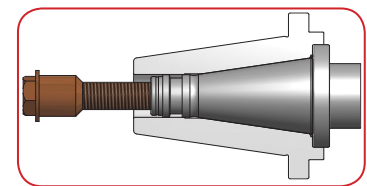
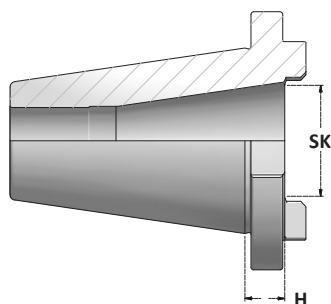

Articolo	H	SK
ISO40.H13.SK30	13	ISO30
ISO50.H16.SK30	16	ISO40
ISO50.H16.SK40	16	ISO50

VITE NON INCLUSA
SCREW NOT INCLUDED

ACCESSORI - ACCESSORIES



MANDRINI MODULARI TIPO VARILOCK
MODULAR TOOLHOLDERS VARILOCK TYPE

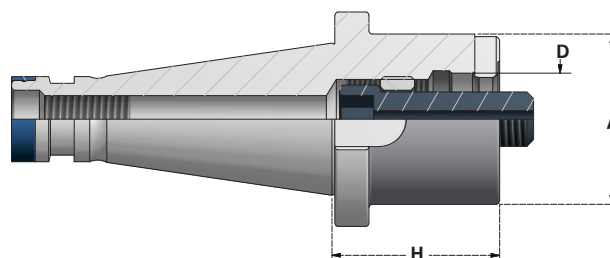

Articolo	A	H	D	Attacco
ISO40.H50.MD50	50	50	27,3 / 27	MD50
ISO40.H50.MD63	63	50	32,3 / 32	MD63

Articolo	A	H	D	Attacco
ISO50.H27.MD50	50	27	27,3 / 27	MD50
ISO50.H50.MD50	50	50	27,3 / 27	MD50
ISO50.H27.MD63	63	27	32,3 / 32	MD63
ISO50.H50.MD63	63	50	32,3 / 32	MD63
ISO50.H27.MD80	80	27	32,3 / 32	MD80
ISO50.H50.MD80	80	50	32,3 / 32	MD80

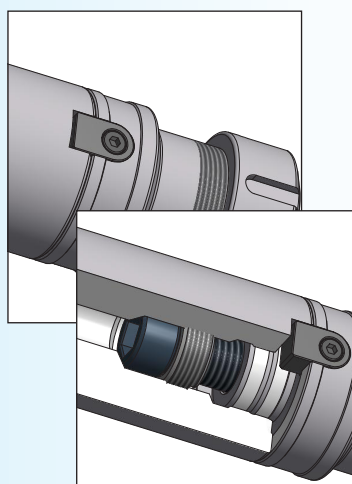

ACCESSORI - ACCESSORIES

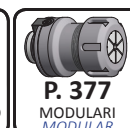

MANDRINI CON STELO LAVORABILE

BLANK ARBORS

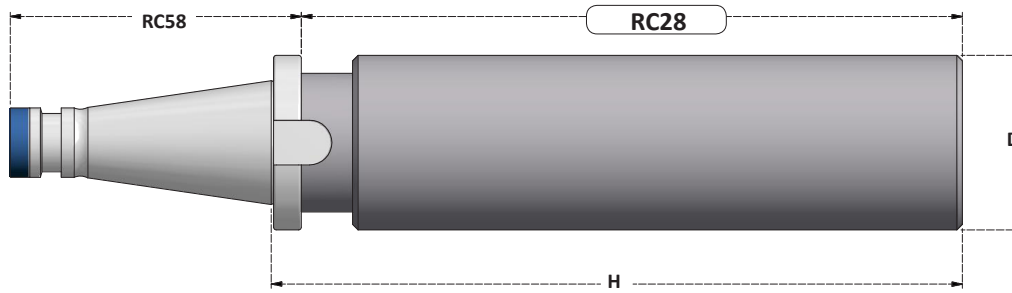

Articolo	D	H
ISO40.H250.D40BL	40	250
ISO40.H160.D63BL	63	160
ISO40.H250.D63BL	63	250
ISO40.H270.D80BL	80	270

Articolo	D	H
ISO50.H330.D50BL	50	330
ISO50.H250.D63BL	63	250
ISO50.H330.D80BL	80	330
ISO50.H315.D97BL	97	315

MANDRINI DI COLLAUDO

TEST ARBORS

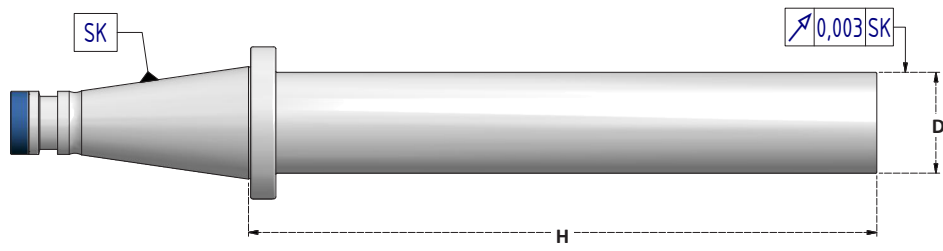

Articolo	D	H
ISO40.H300.CK40	40	300
ISO50.H300.CK50	50	300

**FORNITI CON BOX
E CERTIFICATO DI COLLAUDO**

*SUPPLIED IN BOX
AND WITH TESTING REPORT*

MANDRINI NMTB PORTAPINZA ER

NMTB ER COLLET CHUCKS

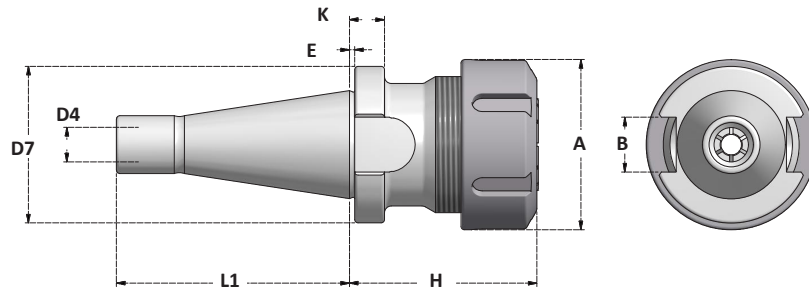

DIMENSIONI IN POLLICI
INCH DIMENSIONS

G6,3
8000 p.p.m.

Articolo	B	D4	D7	L1	E	K	H	A	Collets Range	Ghiera Nut
NMTB30-H3.30-ERC40	.635	1/2- 13	1.81	2.692	.078	.344	3.30	2.48	.118 ÷ 1.18	G40S
NMTB40-H2.20-ERC40	.635	5/8- 11	2.50	3.677	.078	.314	2.20	2.48	.118 ÷ 1.18	G40S
NMTB50-H2.75-ERC40	1.013	1"- 8	3.50	4.992	.179	.455	2.75	2.48	.118 ÷ 1.18	G40S

**PER MACCHINE
TIPO ERICKSON**
*SUITABLE FOR ERICKSON
MACHINES*



ACCESSORI - ACCESSORIES

