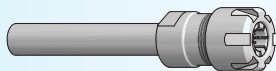
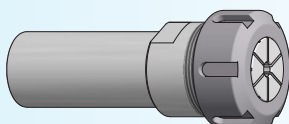
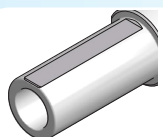
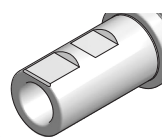
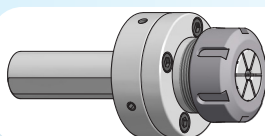
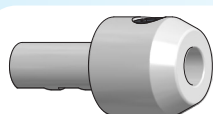
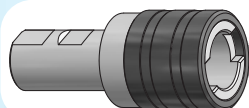
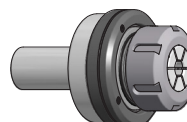
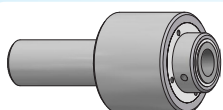
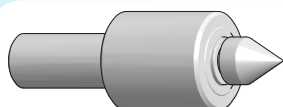
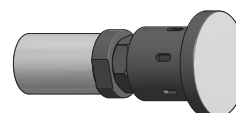


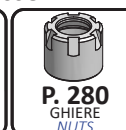
**MANDRINI A GAMBO CILINDRICO***CYLINDRICAL SHANK TOOLHOLDERS***MANDRINI CILINDRICI PORTAPINZA ER
CON GHIERA MINI**
*CYLINDRICAL ER COLLET CHUCKS
WITH MINI NUT***ERC8M***PAG. 208***ERC11M***PAG. 209***ERC16M***PAG. 210***ERC20M***PAG. 211***ERC25M***PAG. 212***MANDRINI CILINDRICI PORTAPINZA ER
CON GHIERA STANDARD**
*CYLINDRICAL ER COLLET CHUCKS
WITH STANDARD NUT***ERC16***PAG. 213***ERC20***PAG. 213***ERC25***PAG. 214***ERC32***PAG. 215***ERC40***PAG. 216***ERC50***PAG. 216***MANDRINI CILINDRICI PORTAPINZA ER
- CON PIANO**
*CYLINDRICAL ER COLLET CHUCKS
- WITH FLAT**PAG. 218***MANDRINI CILINDRICI PORTAPINZA ER
- CON PIANI WELDON**
*CYLINDRICAL ER COLLET CHUCKS
- WITH DIN1835 FLATS**PAG. 218***MANDRINI CILINDRICI
PORTAPINZA ER - REGISTRABILI**
*CYLINDRICAL ER COLLET CHUCKS
- ADJUSTABLE**PAG. 219***MANDRINI CILINDRICI PORTAPINZA ER - BILATERALI**
*CYLINDRICAL ER COLLET CHUCKS - DOUBLE**PAG. 220***PROLUNGHE PORTAPINZA SLC**
SLC COLLET CHUCK EXTENSIONS*PAG. 221***ADATTATORI PER PORTAFRESE FILETTATE**
SCREW IN MILL EXTENSIONS*PAG. 222***PROLUNGHE HM PER FRESE FILETTATE**
HSS SCREW IN MILL EXTENSIONS*PAG. 223***PROLUNGHE A CALETTAMENTO**
SHRINK EXTENSIONS*PAG. 224***RIDUZIONI WELDON**
*END MILL WELDON SHANK ADAPTERS**PAG. 225***MANDRINI PORTAPUNTA**
*DRILL CHUCKS**PAG. 226***PORTAMASCHI**
*TAPPING CHUCKS**PAG. 227***PORTA ALESATORI**
*REAMER HOLDERS**PAG. 230***BROCCIATORI**
*BROACH TOOLHOLDERS**PAG. 231***PORTASEGHE CIRCOLARI**
*ADAPTERS FOR SAW BLADES**PAG. 232***CONTROPUNTE ROTANTI**
*LIVE CENTRES**PAG. 233***FERMI BARRA**
*SHOCK ABSORBERS**PAG. 233*

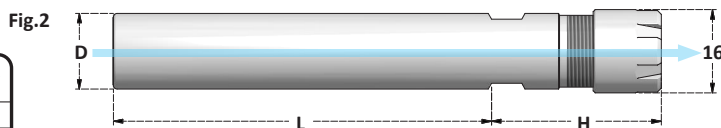
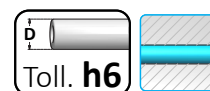
**PROLUNGHE CILINDRICHE PORTAPINZA ER CON GHIERA MINI**
CYLINDRICAL SHANK ER COLLET CHUCKS WITH MINI NUTSCHEDA TECNICA
TECHNICAL DATA
ERC P. 338DIAMETRI DELLE PINZE
COLLETS RANGE **1+5**GHIERA MONTATA
MOUNTED NUT **G8M**

| Articolo | | D | L | H | FIG |
|----------------|---|----|-----|------|-----|
| D6.L45.ERC8M | * | 6 | 45 | 22,5 | 1 |
| D6.L60.ERC8M | * | 6 | 60 | 22,5 | 1 |
| D6.L80.ERC8M | * | 6 | 80 | 22,5 | 1 |
| D6.L100.ERC8M | * | 6 | 100 | 22,5 | 1 |
| D8.L45.ERC8M | * | 8 | 45 | 22,5 | 1 |
| D8.L60.ERC8M | * | 8 | 60 | 22,5 | 1 |
| D8.L80.ERC8M | * | 8 | 80 | 22,5 | 1 |
| D8.L100.ERC8M | * | 8 | 100 | 22,5 | 1 |
| D8.L130.ERC8M | * | 8 | 130 | 22,5 | 1 |
| D10.L45.ERC8M | * | 10 | 45 | 25,5 | 2 |
| D10.L60.ERC8M | * | 10 | 60 | 25,5 | 2 |
| D10.L80.ERC8M | * | 10 | 80 | 25,5 | 2 |
| D10.L100.ERC8M | * | 10 | 100 | 25,5 | 2 |
| D10.L130.ERC8M | * | 10 | 130 | 25,5 | 2 |
| D10.L160.ERC8M | * | 10 | 160 | 25,5 | 2 |
| D12.L45.ERC8M | * | 12 | 45 | 25,5 | 2 |
| D12.L60.ERC8M | * | 12 | 60 | 25,5 | 2 |
| D12.L80.ERC8M | * | 12 | 80 | 25,5 | 2 |
| D12.L100.ERC8M | * | 12 | 100 | 25,5 | 2 |
| D12.L130.ERC8M | * | 12 | 130 | 25,5 | 2 |
| D12.L160.ERC8M | * | 12 | 160 | 25,5 | 2 |
| D12.L200.ERC8M | * | 12 | 200 | 25,5 | 2 |

* SENZA PASSAGGIO DEL REFRIGERANTE
WITHOUT COOLANT BORE**P. 217**
KIT

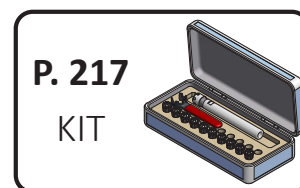
ACCESSORI - ACCESSORIES

**P. 250**
PINZE
COLLETS**P. 280**
GHIERE
NUTS**P. 288**
CHIAVI
WRENCHES

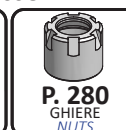
**PROLUNGHE CILINDRICHE PORTAPINZA ER CON GHIERA MINI**
CYLINDRICAL SHANK ER COLLET CHUCKS WITH MINI NUTSCHEDA TECNICA
TECHNICAL DATA
ERC P. 338DIAMETRI DELLE PINZE
COLLETS RANGE **1÷7**GHIERA MONTATA
MOUNTED NUT **G11M**

| Articolo | D | L | H | FIG |
|-----------------|------|-----|----|-----|
| D6.L45.ERC11M | * 6 | 45 | 27 | 1 |
| D6.L60.ERC11M | * 6 | 60 | 27 | 1 |
| D6.L80.ERC11M | * 6 | 80 | 27 | 1 |
| D6.L100.ERC11M | * 6 | 100 | 27 | 1 |
| D8.L45.ERC11M | * 8 | 45 | 30 | 1 |
| D8.L60.ERC11M | * 8 | 60 | 30 | 1 |
| D8.L80.ERC11M | * 8 | 80 | 26 | 1 |
| D8.L100.ERC11M | * 8 | 100 | 26 | 1 |
| D8.L130.ERC11M | * 8 | 130 | 26 | 1 |
| D10.L45.ERC11M | * 10 | 45 | 26 | 1 |
| D10.L60.ERC11M | * 10 | 60 | 26 | 1 |
| D10.L80.ERC11M | * 10 | 80 | 26 | 1 |
| D10.L100.ERC11M | * 10 | 100 | 26 | 1 |
| D10.L130.ERC11M | * 10 | 130 | 26 | 1 |
| D10.L160.ERC11M | * 10 | 160 | 26 | 1 |
| D12.L45.ERC11M | 12 | 45 | 26 | 1 |
| D12.L60.ERC11M | 12 | 60 | 26 | 1 |
| D12.L80.ERC11M | 12 | 80 | 26 | 1 |
| D12.L100.ERC11M | * 12 | 100 | 26 | 1 |
| D12.L130.ERC11M | * 12 | 130 | 26 | 1 |
| D12.L160.ERC11M | * 12 | 160 | 26 | 1 |
| D12.L200.ERC11M | * 12 | 200 | 26 | 1 |
| D16.L45.ERC11M | 16 | 45 | 33 | 2 |
| D16.L60.ERC11M | 16 | 60 | 33 | 2 |
| D16.L80.ERC11M | 16 | 80 | 33 | 2 |
| D16.L100.ERC11M | 16 | 100 | 33 | 2 |
| D16.L130.ERC11M | 16 | 130 | 33 | 2 |
| D16.L160.ERC11M | 16 | 160 | 33 | 2 |
| D16.L200.ERC11M | * 16 | 200 | 33 | 2 |
| D16.L250.ERC11M | * 16 | 250 | 33 | 2 |
| D16.L300.ERC11M | * 16 | 300 | 33 | 2 |
| D20.L60.ERC11M | 20 | 60 | 35 | 2 |
| D20.L80.ERC11M | 20 | 80 | 35 | 2 |
| D20.L100.ERC11M | 20 | 100 | 35 | 2 |
| D20.L130.ERC11M | 20 | 130 | 35 | 2 |
| D20.L160.ERC11M | 20 | 160 | 35 | 2 |
| D20.L200.ERC11M | 20 | 200 | 35 | 2 |
| D20.L250.ERC11M | 20 | 250 | 35 | 2 |
| D20.L300.ERC11M | * 20 | 300 | 35 | 2 |
| D25.L60.ERC11M | 25 | 60 | 35 | 2 |
| D25.L80.ERC11M | 25 | 80 | 35 | 2 |
| D25.L100.ERC11M | 25 | 100 | 35 | 2 |
| D25.L130.ERC11M | 25 | 130 | 35 | 2 |

| Articolo | D | L | H | FIG |
|-------------------|--------|-------|----|-----|
| D1/2-L2.36-ERC11M | 12,7 | 59,9 | 26 | 1 |
| D5/8-L5.11-ERC11M | 15,875 | 129,8 | 33 | 2 |
| D5/8-L6.29-ERC11M | 15,875 | 159,9 | 33 | 2 |
| D3/4-L2.36-ERC11M | 19,05 | 59,9 | 35 | 2 |
| D3/4-L3.93-ERC11M | 19,05 | 99,8 | 35 | 2 |

* SENZA PASSAGGIO DEL REFRIGERANTE
WITHOUT COOLANT BORE

ACCESSORI - ACCESSORIES

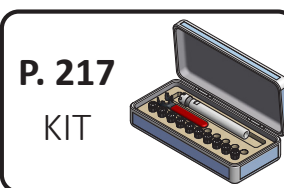


**PROLUNGHE CILINDRICHE PORTAPINZA ER CON GHIERA MINI**
CYLINDRICAL SHANK ER COLLET CHUCKS WITH MINI NUTSCHEDA TECNICA
TECHNICAL DATA
ERC P. 338DIAMETRI DELLE PINZE
COLLETS RANGE **1÷10**GHIERA MONTATA
MOUNTED NUT **G16M**

| Articolo | D | L | H | FIG |
|-----------------|----|-----|----|-----|
| D10.L60.ERC16M | 10 | 60 | 38 | 1 |
| D10.L80.ERC16M | 10 | 80 | 38 | 1 |
| D10.L100.ERC16M | * | 100 | 38 | 1 |
| D10.L130.ERC16M | * | 130 | 38 | 1 |
| D10.L160.ERC16M | * | 160 | 38 | 1 |
| D12.L60.ERC16M | 12 | 60 | 38 | 1 |
| D12.L80.ERC16M | 12 | 80 | 38 | 1 |
| D12.L100.ERC16M | 12 | 100 | 38 | 1 |
| D12.L130.ERC16M | * | 130 | 38 | 1 |
| D12.L160.ERC16M | * | 160 | 38 | 1 |
| D12.L200.ERC16M | * | 200 | 38 | 1 |
| D16.L60.ERC16M | 16 | 60 | 38 | 1 |
| D16.L80.ERC16M | 16 | 80 | 38 | 1 |
| D16.L100.ERC16M | 16 | 100 | 38 | 1 |
| D16.L130.ERC16M | 16 | 130 | 38 | 1 |
| D16.L160.ERC16M | 16 | 160 | 38 | 1 |
| D16.L200.ERC16M | * | 200 | 38 | 1 |
| D16.L250.ERC16M | * | 250 | 38 | 1 |
| D16.L300.ERC16M | * | 300 | 38 | 1 |
| D20.L60.ERC16M | 20 | 60 | 40 | 2 |
| D20.L80.ERC16M | 20 | 80 | 40 | 2 |
| D20.L100.ERC16M | 20 | 100 | 40 | 2 |
| D20.L130.ERC16M | 20 | 130 | 40 | 2 |
| D20.L160.ERC16M | 20 | 160 | 40 | 2 |
| D20.L200.ERC16M | 20 | 200 | 40 | 2 |
| D20.L250.ERC16M | 20 | 250 | 40 | 2 |
| D20.L300.ERC16M | * | 300 | 40 | 2 |
| D25.L60.ERC16M | 25 | 60 | 40 | 2 |
| D25.L80.ERC16M | 25 | 80 | 40 | 2 |
| D25.L100.ERC16M | 25 | 100 | 40 | 2 |
| D25.L130.ERC16M | 25 | 130 | 40 | 2 |
| D25.L160.ERC16M | 25 | 160 | 40 | 2 |
| D25.L200.ERC16M | 25 | 200 | 40 | 2 |
| D25.L250.ERC16M | 25 | 250 | 40 | 2 |
| D25.L300.ERC16M | 25 | 300 | 40 | 2 |

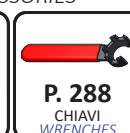
* SENZA PASSAGGIO DEL REFRIGERANTE
WITHOUT COOLANT BORE

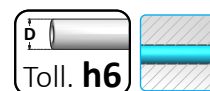
| Articolo | D | L | H | FIG |
|-------------------|--------|-------|----|-----|
| D1/2-L2.36-ERC16M | 12,7 | 59,9 | 38 | 1 |
| D1/2-L6.29-ERC16M | * | 159,8 | 38 | 1 |
| D5/8-L5.11-ERC16M | 15,875 | 129,8 | 38 | 1 |
| D5/8-L6.29-ERC16M | 15,875 | 159,8 | 38 | 1 |
| D3/4-L2.36-ERC16M | 19,05 | 59,9 | 40 | 2 |
| D3/4-L3.93-ERC16M | 19,05 | 99,8 | 40 | 2 |
| D3/4-L5.11-ERC16M | 19,05 | 129,8 | 40 | 2 |
| D3/4-L6.29-ERC16M | 19,05 | 159,8 | 40 | 2 |
| D1"-L2.36-ERC16M | 25,4 | 59,9 | 40 | 2 |
| D1"-L3.93-ERC16M | 25,4 | 99,8 | 40 | 2 |
| D1"-L5.11-ERC16M | 25,4 | 129,8 | 40 | 2 |
| D1"-L6.29-ERC16M | 25,4 | 159,8 | 40 | 2 |

* SENZA PASSAGGIO DEL REFRIGERANTE
WITHOUT COOLANT BORE**P. 217**

KIT

ACCESSORI - ACCESSORIES

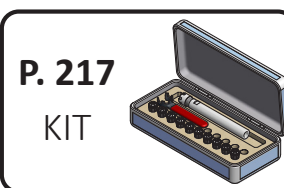
**P. 250**
PINZE
COLLETS**P. 280**
GHIERE
NUTS**P. 288**
CHIAVI
WRENCHES

**PROLUNGHE CILINDRICHE PORTAPINZA ER CON GHIERA MINI**
CYLINDRICAL SHANK ER COLLET CHUCKS WITH MINI NUTSCHEDA TECNICA
TECHNICAL DATA
ERC P. 338DIAMETRI DELLE PINZE
COLLETS RANGE **1÷14**GHIERA MONTATA
MOUNTED NUT **G20M**

| Articolo | D | L | H | FIG |
|-----------------|----|-----|------|-----|
| D16.L60.ERC20M | 16 | 60 | 41,5 | 1 |
| D16.L80.ERC20M | 16 | 80 | 41,5 | 1 |
| D16.L100.ERC20M | 16 | 100 | 41,5 | 1 |
| D16.L130.ERC20M | 16 | 130 | 41,5 | 1 |
| D16.L160.ERC20M | 16 | 160 | 41,5 | 1 |
| D16.L200.ERC20M | * | 16 | 200 | 3 |
| D16.L250.ERC20M | * | 16 | 250 | 3 |
| D16.L300.ERC20M | * | 16 | 300 | 3 |
| D20.L60.ERC20M | 20 | 60 | 36,5 | 1 |
| D20.L80.ERC20M | 20 | 80 | 36,5 | 1 |
| D20.L100.ERC20M | 20 | 100 | 36,5 | 1 |
| D20.L130.ERC20M | 20 | 130 | 36,5 | 1 |
| D20.L160.ERC20M | 20 | 160 | 36,5 | 1 |
| D20.L200.ERC20M | 20 | 200 | 36,5 | 1 |
| D20.L250.ERC20M | 20 | 250 | 36,5 | 1 |
| D20.L300.ERC20M | * | 20 | 300 | 3 |
| D25.L60.ERC20M | 25 | 60 | 44,5 | 2 |
| D25.L80.ERC20M | 25 | 80 | 44,5 | 2 |
| D25.L100.ERC20M | 25 | 100 | 44,5 | 2 |
| D25.L130.ERC20M | 25 | 130 | 44,5 | 2 |
| D25.L160.ERC20M | 25 | 160 | 44,5 | 2 |
| D25.L200.ERC20M | 25 | 200 | 44,5 | 2 |
| D25.L250.ERC20M | 25 | 250 | 44,5 | 2 |
| D25.L300.ERC20M | 25 | 300 | 44,5 | 2 |

* SENZA PASSAGGIO DEL REFRIGERANTE
WITHOUT COOLANT BORE

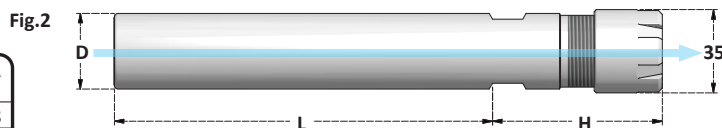
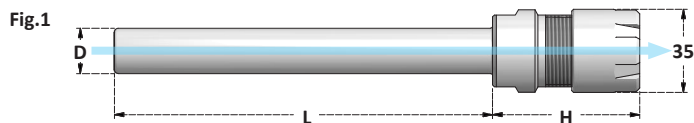
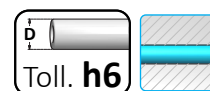
| Articolo | D | L | H | FIG |
|-------------------|-------|-------|------|-----|
| D1/2-L2.36-ERC20M | 12,7 | 59,9 | 41,5 | 1 |
| D1/2-L3.93-ERC20M | 12,7 | 99,8 | 41,5 | 1 |
| D1/2-L5.11-ERC20M | 12,7 | 129,8 | 41,5 | 1 |
| D3/4-L2.36-ERC20M | 19,05 | 59,9 | 36,5 | 1 |
| D3/4-L3.93-ERC20M | 19,05 | 99,8 | 36,5 | 1 |
| D1"-L2.36-ERC20M | 25,4 | 59,9 | 44,5 | 2 |
| D1"-L3.93-ERC20M | 25,4 | 99,8 | 44,5 | 2 |
| D1"-L5.11-ERC20M | 25,4 | 129,8 | 44,5 | 2 |

**P. 217**

KIT

ACCESSORI - ACCESSORIES

**P. 250**
PINZE
COLLETS**P. 280**
GHIERE
NUTS**P. 288**
CHIAVI
WRENCHES

**PROLUNGHE CILINDRICHE PORTAPINZA ER CON GHIERA MINI**
CYLINDRICAL SHANK ER COLLET CHUCKS WITH MINI NUTSCHEDA TECNICA
TECHNICAL DATA
ERC P. 338DIAMETRI DELLE PINZE
COLLETS RANGE **1÷20**GHIERA MONTATA
MOUNTED NUT **G25M**

| Articolo | D | L | H | FIG | |
|-----------------|----|-----|-----|-----|---|
| D20.L60.ERC25M | 20 | 60 | 46 | 1 | |
| D20.L80.ERC25M | 20 | 80 | 46 | 1 | |
| D20.L100.ERC25M | 20 | 100 | 46 | 1 | |
| D20.L130.ERC25M | 20 | 130 | 46 | 1 | |
| D20.L160.ERC25M | 20 | 160 | 46 | 1 | |
| D20.L200.ERC25M | 20 | 200 | 46 | 1 | |
| D20.L250.ERC25M | 20 | 250 | 46 | 2 | |
| D20.L300.ERC25M | * | 20 | 300 | 46 | 2 |
| D25.L60.ERC25M | 25 | 60 | 40 | 1 | |
| D25.L80.ERC25M | 25 | 80 | 40 | 1 | |
| D25.L100.ERC25M | 25 | 100 | 40 | 1 | |
| D25.L130.ERC25M | 25 | 130 | 40 | 1 | |
| D25.L160.ERC25M | 25 | 160 | 40 | 1 | |
| D25.L200.ERC25M | 25 | 200 | 40 | 1 | |
| D25.L250.ERC25M | 25 | 250 | 40 | 1 | |
| D25.L300.ERC25M | 25 | 300 | 40 | 1 | |

* SENZA PASSAGGIO DEL REFRIGERANTE
WITHOUT COOLANT BORE

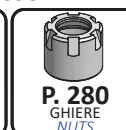
| Articolo | D | L | H |
|-------------------|-------|-------|----|
| D3/4-L2.36-ERC25M | 19,05 | 59,9 | 46 |
| D1"-L2.36-ERC25M | 25,4 | 59,9 | 40 |
| D1"-L3.93-ERC25M | 25,4 | 99,8 | 40 |
| D1"-L5.11-ERC25M | 25,4 | 129,8 | 40 |
| D1"-L6.29-ERC25M | 25,4 | 159,8 | 40 |

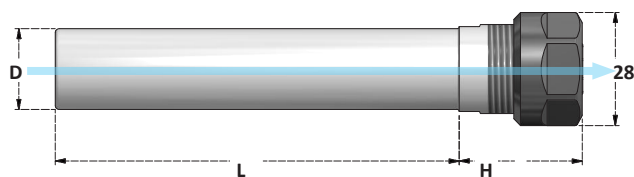
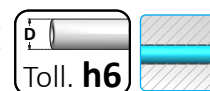


P. 217

KIT

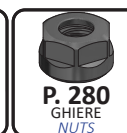
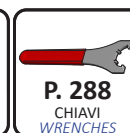
ACCESSORI - ACCESSORIES

P. 250
PINZE
COLLETSP. 280
GHIERE
NUTSP. 288
CHIAVI
WRENCHES

**PROLUNGHE CILINDRICHE PORTAPINZA ER CON GHIERA ESAGONALE**
CYLINDRICAL SHANK ER COLLET CHUCKS WITH HEXAGONAL NUTSCHEDA TECNICA
TECHNICAL DATA
ERC P. 338DIAMETRI DELLE PINZE
COLLETS RANGE **1÷10**GHIERA MONTATA
MOUNTED NUT **G16SE**

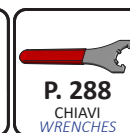
| Articolo | D | L | H |
|-----------------------|----|-----|----|
| D16.L60.ERC16 | 16 | 60 | 31 |
| D16.L80.ERC16 | 16 | 80 | 31 |
| D16.L100.ERC16 | 16 | 100 | 31 |
| D16.L130.ERC16 | 16 | 130 | 31 |
| D16.L160.ERC16 | 16 | 160 | 31 |
| D20.L60.ERC16 | 20 | 60 | 31 |
| D20.L80.ERC16 | 20 | 80 | 31 |
| D20.L100.ERC16 | 20 | 100 | 31 |
| D20.L130.ERC16 | 20 | 130 | 31 |
| D20.L160.ERC16 | 20 | 160 | 31 |

ACCESSORI - ACCESSORIES

P. 250
PINZE
COLLETSP. 280
GHIERE
NUTSP. 288
CHIAVI
WRENCHES**PROLUNGHE CILINDRICHE PORTAPINZA ER CON GHIERA ESAGONALE**
CYLINDRICAL SHANK ER COLLET CHUCKS WITH HEXAGONAL NUTSCHEDA TECNICA
TECHNICAL DATA
ERC P. 338DIAMETRI DELLE PINZE
COLLETS RANGE **1÷14**GHIERA MONTATA
MOUNTED NUT **G20SE**

| Articolo | D | L | H |
|-----------------------|----|-----|------|
| D20.L60.ERC20 | 20 | 60 | 36,5 |
| D20.L80.ERC20 | 20 | 80 | 36,5 |
| D20.L100.ERC20 | 20 | 100 | 36,5 |
| D20.L130.ERC20 | 20 | 130 | 36,5 |
| D20.L160.ERC20 | 20 | 160 | 36,5 |
| D25.L60.ERC20 | 25 | 60 | 44,5 |
| D25.L80.ERC20 | 25 | 80 | 44,5 |
| D25.L100.ERC20 | 25 | 100 | 44,5 |
| D25.L130.ERC20 | 25 | 130 | 44,5 |
| D25.L160.ERC20 | 25 | 160 | 44,5 |

ACCESSORI - ACCESSORIES

P. 250
PINZE
COLLETSP. 280
GHIERE
NUTSP. 288
CHIAVI
WRENCHES

**PROLUNGHE CILINDRICHE PORTAPINZA ER CON GHIERA STANDARD**
CYLINDRICAL SHANK ER COLLET CHUCKS WITH STANDARD NUT

Fig.1

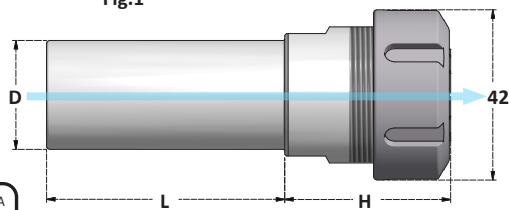
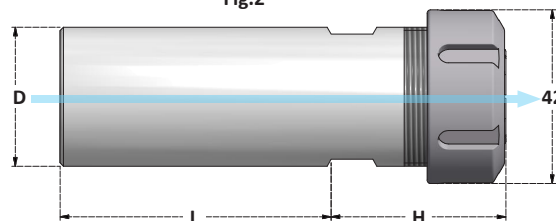
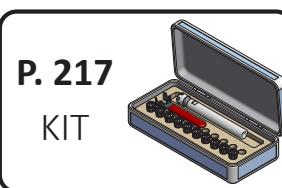


Fig.2

SCHEDA TECNICA
TECHNICAL DATA
ERC P. 338DIAMETRI DELLE PINZE
COLLETS RANGE **1÷20**GHIERA MONTATA
MOUNTED NUT **G25S**

| Articolo | D | L | H | FIG |
|----------------|----|-----|----|-----|
| D20.L60.ERC25 | 20 | 60 | 46 | 1 |
| D20.L80.ERC25 | 20 | 80 | 46 | 1 |
| D20.L100.ERC25 | 20 | 100 | 46 | 1 |
| D20.L130.ERC25 | 20 | 130 | 46 | 1 |
| D20.L160.ERC25 | 20 | 160 | 46 | 1 |
| D25.L60.ERC25 | 25 | 60 | 40 | 1 |
| D25.L80.ERC25 | 25 | 80 | 40 | 1 |
| D25.L100.ERC25 | 25 | 100 | 40 | 1 |
| D25.L130.ERC25 | 25 | 130 | 40 | 1 |
| D25.L160.ERC25 | 25 | 160 | 40 | 1 |
| D32.L60.ERC25 | 32 | 60 | 44 | 2 |
| D32.L80.ERC25 | 32 | 80 | 44 | 2 |
| D32.L100.ERC25 | 32 | 100 | 44 | 2 |
| D32.L130.ERC25 | 32 | 130 | 44 | 2 |
| D32.L160.ERC25 | 32 | 160 | 44 | 2 |
| D40.L60.ERC25 | 40 | 60 | 49 | 2 |
| D40.L80.ERC25 | 40 | 80 | 49 | 2 |
| D40.L100.ERC25 | 40 | 100 | 49 | 2 |
| D40.L130.ERC25 | 40 | 130 | 49 | 2 |
| D40.L160.ERC25 | 40 | 160 | 49 | 2 |

| Articolo | D | L | H | FIG |
|-----------------|------|-------|----|-----|
| D1"-L2.36-ERC25 | 25,4 | 59,9 | 40 | 1 |
| D1"-L3.93-ERC25 | 25,4 | 99,8 | 40 | 1 |
| D1"-L5.11-ERC25 | 25,4 | 129,8 | 40 | 1 |

**P. 217**
KIT

ACCESSORI - ACCESSORIES

**P. 250**
PINZE
COLLETS**P. 280**
GHIERE
NUTS**P. 288**
CHIAVI
WRENCHES

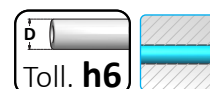
**PROLUNGHE CILINDRICHE PORTAPINZA ER CON GHIERA STANDARD**
CYLINDRICAL SHANK ER COLLET CHUCKS WITH STANDARD NUT

Fig.1

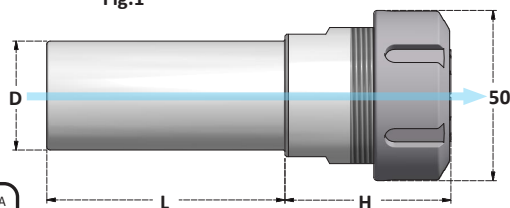
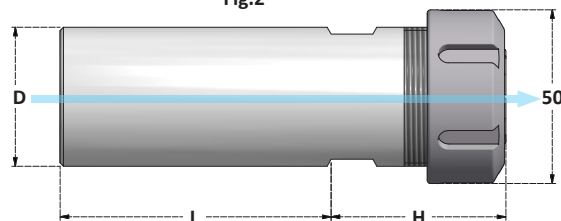
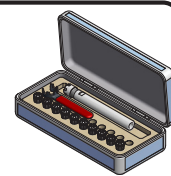


Fig.2

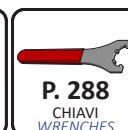
SCHEDA TECNICA
TECHNICAL DATA
ERC P. 338DIAMETRI DELLE PINZE
COLLETS RANGE **2÷22**GHIERA MONTATA
MOUNTED NUT **G32S**

| Articolo | D | L | H | FIG |
|----------------|----|-----|----|-----|
| D20.L60.ERC32 | 20 | 60 | 53 | 1 |
| D20.L80.ERC32 | 20 | 80 | 53 | 1 |
| D20.L100.ERC32 | 20 | 100 | 53 | 1 |
| D20.L130.ERC32 | 20 | 130 | 53 | 1 |
| D20.L160.ERC32 | 20 | 160 | 53 | 1 |
| D25.L60.ERC32 | 25 | 60 | 53 | 1 |
| D25.L80.ERC32 | 25 | 80 | 53 | 1 |
| D25.L100.ERC32 | 25 | 100 | 53 | 1 |
| D25.L130.ERC32 | 25 | 130 | 53 | 1 |
| D25.L160.ERC32 | 25 | 160 | 53 | 1 |
| D32.L60.ERC32 | 32 | 60 | 48 | 1 |
| D32.L80.ERC32 | 32 | 80 | 48 | 1 |
| D32.L100.ERC32 | 32 | 100 | 48 | 1 |
| D32.L130.ERC32 | 32 | 130 | 48 | 1 |
| D32.L160.ERC32 | 32 | 160 | 48 | 1 |
| D40.L60.ERC32 | 40 | 60 | 50 | 2 |
| D40.L80.ERC32 | 40 | 80 | 50 | 2 |
| D40.L100.ERC32 | 40 | 100 | 50 | 2 |
| D40.L130.ERC32 | 40 | 130 | 50 | 2 |
| D40.L160.ERC32 | 40 | 160 | 50 | 2 |
| D50.L130.ERC32 | 50 | 130 | 47 | 2 |
| D50.L160.ERC32 | 50 | 160 | 47 | 2 |

| Articolo | D | L | H | FIG |
|--------------------|-------|-------|----|-----|
| D3/4-L2.36-ERC32 | 19,05 | 59,9 | 53 | 1 |
| D1"-L2.36-ERC32 | 25,4 | 59,9 | 53 | 1 |
| D1"-L3.93-ERC32 | 25,4 | 99,8 | 53 | 1 |
| D1"-L5.11-ERC32 | 25,4 | 129,8 | 53 | 1 |
| D1-1/4-L2.36-ERC32 | 31,75 | 59,9 | 48 | 1 |
| D1-1/4-L3.93-ERC32 | 31,75 | 99,8 | 48 | 1 |
| D1-3/4-L5.11-ERC32 | 44,45 | 129,8 | 50 | 2 |

P. 217
KIT

ACCESSORI - ACCESSORIES



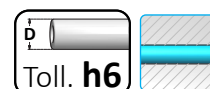
**PROLUNGHE CILINDRICHE PORTAPINZA ER CON GHIERA STANDARD**
CYLINDRICAL SHANK ER COLLET CHUCKS WITH STANDARD NUT

Fig.1

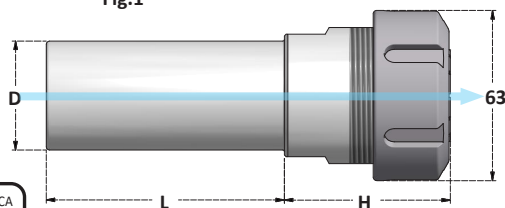
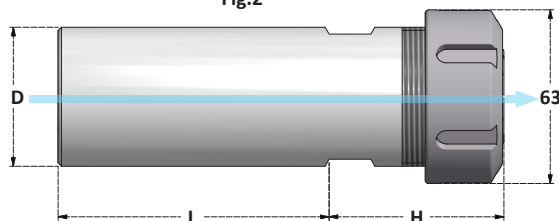
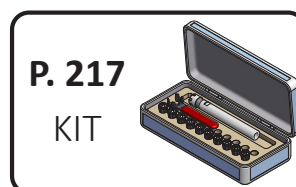


Fig.2

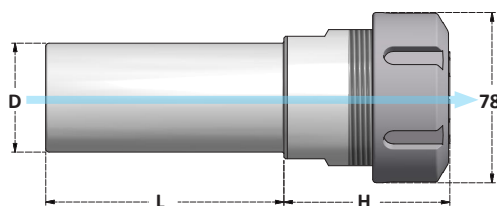
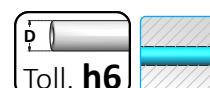
SCHEDA TECNICA
TECHNICAL DATA
ERC P. 338DIAMETRI DELLE PINZE
COLLETS RANGE **3÷30**GHIERA MONTATA
MOUNTED NUT **G40S**

| Articolo | D | L | H | FIG |
|----------------|----|-----|----|-----|
| D25.L60.ERC40 | 25 | 60 | 61 | 1 |
| D25.L80.ERC40 | 25 | 80 | 61 | 1 |
| D25.L100.ERC40 | 25 | 100 | 61 | 1 |
| D25.L130.ERC40 | 25 | 130 | 61 | 1 |
| D25.L160.ERC40 | 25 | 160 | 61 | 1 |
| D32.L60.ERC40 | 32 | 60 | 61 | 1 |
| D32.L80.ERC40 | 32 | 80 | 61 | 1 |
| D32.L100.ERC40 | 32 | 100 | 61 | 1 |
| D32.L130.ERC40 | 32 | 130 | 61 | 1 |
| D32.L160.ERC40 | 32 | 160 | 61 | 1 |
| D40.L80.ERC40 | 40 | 80 | 65 | 1 |
| D40.L100.ERC40 | 40 | 100 | 65 | 1 |
| D40.L130.ERC40 | 40 | 130 | 65 | 1 |
| D40.L160.ERC40 | 40 | 160 | 65 | 1 |
| D50.L120.ERC40 | 50 | 120 | 59 | 2 |
| D50.L160.ERC40 | 50 | 160 | 59 | 2 |
| D60.L160.ERC40 | 60 | 160 | 59 | 2 |

| Articolo | D | L | H | FIG |
|--------------------|-------|-------|----|-----|
| D1"-L2.36-ERC40 | 25,4 | 59,9 | 61 | 1 |
| D1"-L3.93-ERC40 | 25,4 | 99,8 | 61 | 1 |
| D1-1/4-L2.36-ERC40 | 31,75 | 59,9 | 61 | 1 |
| D2"-L6.29-ERC40 | 50,8 | 159,8 | 65 | 2 |

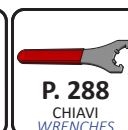


ACCESSORI - ACCESSORIES

P. 250
PINZE
COLLETSP. 280
GHIERE
NUTSP. 288
CHIAVI
WRENCHES**PROLUNGHE CILINDRICHE PORTAPINZA ER CON GHIERA STANDARD**
CYLINDRICAL SHANK ER COLLET CHUCKS WITH STANDARD NUTSCHEDA TECNICA
TECHNICAL DATA
ERC P. 338DIAMETRI DELLE PINZE
COLLETS RANGE **6÷34**GHIERA MONTATA
MOUNTED NUT **G50S**

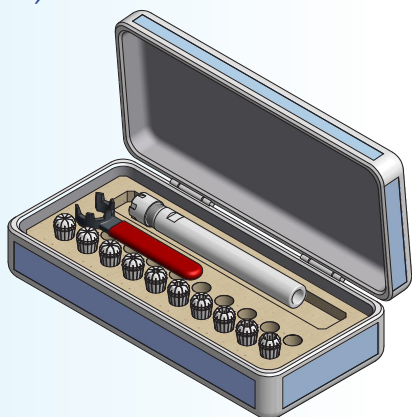
| Articolo | D | L | H |
|----------------|----|-----|----|
| D40.L160.ERC50 | 40 | 160 | 65 |
| D50.L170.ERC50 | 50 | 170 | 65 |
| D60.L170.ERC50 | 60 | 170 | 65 |

ACCESSORI - ACCESSORIES

P. 250
PINZE
COLLETSP. 280
GHIERE
NUTSP. 288
CHIAVI
WRENCHES

**KIT - MANDRINO, CHIAVE E PINZE**

KIT - TOOLHOLDER, WRENCH AND COLLETS



| |
|----------------|
| SCHEDA TECNICA |
| TECHNICAL DATA |
| ERC P. 338 |

| KIT | Pinze Collets | Ø Pinze Ø Collets | Chiave Wrench |
|--------|------------------|----------------------|------------------|
| ...8M | ERC8 | 1÷5 x 0,5mm | CH8M |
| ...11M | ERC11 | 1÷7 x 0,5mm | CH11M |
| ...16M | ERC16 | 1÷10 x 1mm | CH16M |
| ...20M | ERC20 | 1÷13 x 1mm | CH20M |
| ...25M | ERC25 | 2÷16 x 1mm | CH25M |
| ...25 | ERC25 | 2÷16 x 1mm | CH25S |
| ...32 | ERC32 | 3÷20 x 1mm | CH32S |
| ...40 | ERC40 | 4÷26 x 1mm | CH40S |

| KIT | Pinze Collets | Ø Pinze Ø Collets | Chiave Wrench |
|---------|------------------|---------------------------|------------------|
| ...32-6 | ERC25 | D6-D8-D10-D12-D16-D20 | CH32S |
| ...40-7 | ERC32 | D6-D8-D10-D12-D16-D20-D25 | CH40S |

| Articolo | Mandrino Chuck |
|-----------------------|-------------------|
| BX.D10.L100.8M | D10.L100.ERC8M |
| BX.D10.L130.8M | D10.L130.ERC8M |
| BX.D10.L160.8M | D10.L160.ERC8M |
| BX.D12.L100.8M | D12.L100.ERC8M |
| BX.D12.L130.8M | D12.L130.ERC8M |
| BX.D12.L160.8M | D12.L160.ERC8M |

| Articolo | Mandrino Chuck |
|------------------------|-------------------|
| BX.D12.L100.11M | D12.L100.ERC11M |
| BX.D12.L130.11M | D12.L130.ERC11M |
| BX.D12.L160.11M | D12.L160.ERC11M |
| BX.D16.L100.11M | D16.L100.ERC11M |
| BX.D16.L130.11M | D16.L130.ERC11M |
| BX.D16.L160.11M | D16.L160.ERC11M |

| Articolo | Mandrino Chuck |
|------------------------|-------------------|
| BX.D16.L100.16M | D16.L100.ERC16M |
| BX.D16.L130.16M | D16.L130.ERC16M |
| BX.D16.L160.16M | D16.L160.ERC16M |
| BX.D16.L200.16M | D16.L200.ERC16M |
| BX.D20.L100.16M | D20.L100.ERC16M |
| BX.D20.L130.16M | D20.L130.ERC16M |
| BX.D20.L160.16M | D20.L160.ERC16M |
| BX.D20.L200.16M | D20.L200.ERC16M |

| Articolo | Mandrino Chuck |
|------------------------|-------------------|
| BX.D16.L100.20M | D16.L100.ERC20M |
| BX.D16.L130.20M | D16.L130.ERC20M |
| BX.D16.L160.20M | D16.L160.ERC20M |
| BX.D16.L200.20M | D16.L200.ERC20M |
| BX.D20.L100.20M | D20.L100.ERC20M |
| BX.D20.L130.20M | D20.L130.ERC20M |
| BX.D20.L160.20M | D20.L160.ERC20M |
| BX.D20.L200.20M | D20.L200.ERC20M |

| Articolo | Mandrino Chuck |
|------------------------|-------------------|
| BX.D20.L100.25M | D20.L100.ERC25M |
| BX.D20.L130.25M | D20.L130.ERC25M |
| BX.D20.L160.25M | D20.L160.ERC25M |
| BX.D20.L200.25M | D20.L200.ERC25M |
| BX.D25.L100.25M | D25.L100.ERC25M |
| BX.D25.L130.25M | D25.L130.ERC25M |
| BX.D25.L160.25M | D25.L160.ERC25M |
| BX.D25.L200.25M | D25.L200.ERC25M |

| Articolo | Mandrino Chuck |
|-----------------------|-------------------|
| BX.D20.L80.25 | D20.L80.ERC25 |
| BX.D20.L100.25 | D20.L100.ERC25 |
| BX.D25.L80.25 | D25.L80.ERC25 |
| BX.D25.L100.25 | D25.L100.ERC25 |
| BX.D32.L80.25 | D32.L80.ERC25 |
| BX.D32.L100.25 | D32.L100.ERC25 |
| BX.D40.L80.25 | D40.L80.ERC25 |
| BX.D40.L100.25 | D40.L100.ERC25 |

| Articolo | Mandrino Chuck |
|-------------------------|-------------------|
| BX.D20.L80.32-6 | D20.L80.ERC32 |
| BX.D20.L100.32-6 | D20.L100.ERC32 |
| BX.D25.L80.32-6 | D25.L80.ERC32 |
| BX.D25.L100.32-6 | D25.L100.ERC32 |
| BX.D32.L80.32-6 | D32.L80.ERC32 |
| BX.D32.L100.32-6 | D32.L100.ERC32 |
| BX.D40.L80.32-6 | D40.L80.ERC32 |
| BX.D40.L100.32-6 | D40.L100.ERC32 |

| Articolo | Mandrino Chuck |
|-----------------------|-------------------|
| BX.D20.L80.32 | D20.L80.ERC32 |
| BX.D20.L100.32 | D20.L100.ERC32 |
| BX.D25.L80.32 | D25.L80.ERC32 |
| BX.D25.L100.32 | D25.L100.ERC32 |
| BX.D32.L80.32 | D32.L80.ERC32 |
| BX.D32.L100.32 | D32.L100.ERC32 |
| BX.D40.L80.32 | D40.L80.ERC32 |
| BX.D40.L100.32 | D40.L100.ERC32 |

| Articolo | Mandrino Chuck |
|-------------------------|-------------------|
| BX.D25.L80.40-7 | D25.L80.ERC40 |
| BX.D25.L100.40-7 | D25.L100.ERC40 |
| BX.D32.L80.40-7 | D32.L80.ERC40 |
| BX.D32.L100.40-7 | D32.L100.ERC40 |
| BX.D40.L80.40-7 | D40.L80.ERC40 |
| BX.D40.L100.40-7 | D40.L100.ERC40 |

| Articolo | Mandrino Chuck |
|-----------------------|-------------------|
| BX.D25.L80.40 | D25.L80.ERC40 |
| BX.D25.L100.40 | D25.L100.ERC40 |
| BX.D32.L80.40 | D32.L80.ERC40 |
| BX.D32.L100.40 | D32.L100.ERC40 |
| BX.D40.L80.40 | D40.L80.ERC40 |
| BX.D40.L100.40 | D40.L100.ERC40 |



**PROLUNGHE CILINDRICHE PORTAPINZA ER CON PIANO**
CYLINDRICAL SHANK ER COLLET CHUCKS WITH FLAT

Fig.1

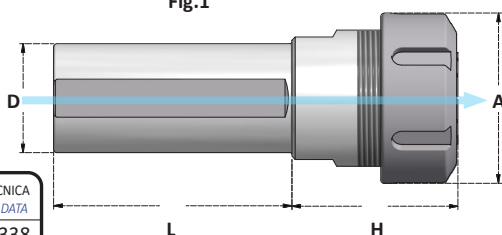
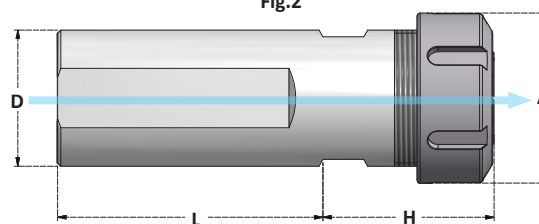


Fig.2

SCHEDA TECNICA
TECHNICAL DATA
ERC | P. 338

| Articolo | D | L | H | FIG |
|----------------|----|----|----|-----|
| D20P.L80.ERC25 | 20 | 80 | 46 | 1 |
| D25P.L80.ERC25 | 25 | 80 | 40 | 1 |
| D32P.L80.ERC25 | 32 | 80 | 44 | 2 |
| D40P.L80.ERC25 | 40 | 80 | 49 | 2 |
| D20P.L80.ERC32 | 20 | 80 | 53 | 1 |
| D25P.L80.ERC32 | 25 | 80 | 53 | 1 |
| D32P.L80.ERC32 | 32 | 80 | 48 | 1 |
| D40P.L80.ERC32 | 40 | 80 | 50 | 2 |
| D25P.L80.ERC40 | 25 | 80 | 61 | 1 |
| D32P.L80.ERC40 | 32 | 80 | 61 | 1 |
| D40P.L80.ERC40 | 40 | 80 | 61 | 1 |

| | A | Collets Range | Ghiera Nut |
|----------|----|---------------|------------|
| ...ERC25 | 42 | 1÷20 | G25S |
| ...ERC32 | 50 | 2÷22 | G32S |
| ...ERC40 | 63 | 3÷30 | G40S |

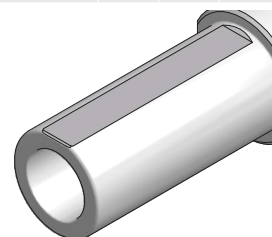
**DIN 1835-1 Form B****PROLUNGHE CILINDRICHE PORTAPINZA CON PIANI WELDON**
CYLINDRICAL SHANK ER COLLET CHUCKS WITH DIN1835 FLATS

Fig.1

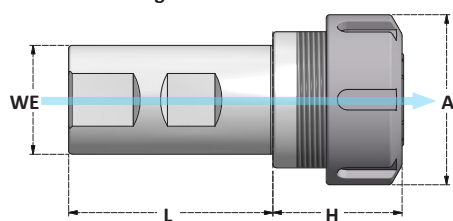
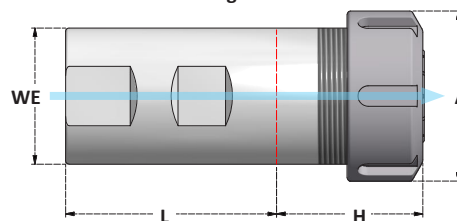
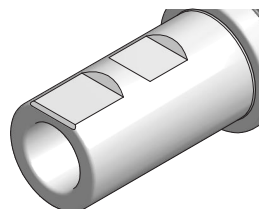


Fig.2

SCHEDA TECNICA
TECHNICAL DATA
ERC | P. 338

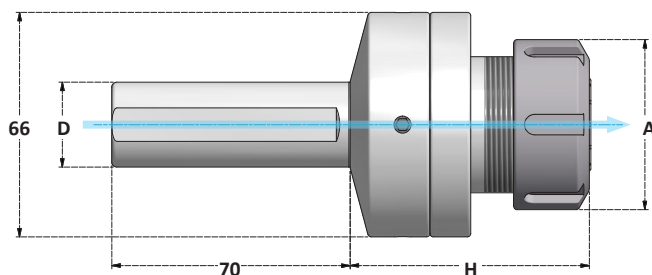
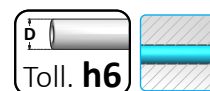
| Articolo | WE | L | H | FIG |
|----------------|----|----|----|-----|
| WE20.L50.ERC16 | 20 | 50 | 31 | 2 |
| WE20.L50.ERC25 | 20 | 50 | 46 | 2 |
| WE25.L56.ERC25 | 25 | 56 | 40 | 2 |
| WE32.L60.ERC25 | 32 | 60 | 44 | 1 |
| WE25.L56.ERC32 | 25 | 56 | 53 | 2 |
| WE32.L60.ERC32 | 32 | 60 | 38 | 2 |
| WE40.L74.ERC32 | 40 | 74 | 31 | 1 |
| WE32.L60.ERC40 | 32 | 60 | 61 | 2 |
| WE50.L80.ERC40 | 50 | 80 | 37 | 1 |

| | A | Collets Range | Ghiera Nut |
|----------|----|---------------|------------|
| ...ERC16 | 28 | 1÷10 | G16SE |
| ...ERC25 | 42 | 1÷20 | G25S |
| ...ERC32 | 50 | 2÷22 | G32S |
| ...ERC40 | 63 | 3÷30 | G40S |



ACCESSORI - ACCESSORIES



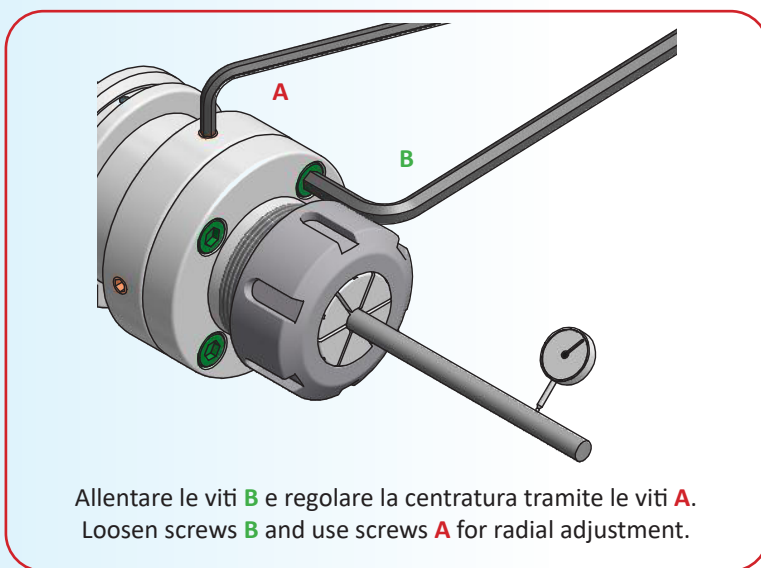
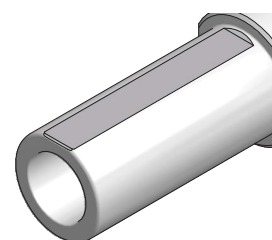
**MANDRINI PORTAPINZA ER A CENTRATURA REGOLABILE**
RUNOUT ADJUSTABLE ER COLLET CHUCKS

±0,1mm Centrat^ora regolabile
Adjustable runout

SCHEDA TECNICA
TECHNICAL DATA
ERC P. 338

| Articolo | D | H |
|------------------|----|-----|
| D25P.L70.ERC16RG | 25 | 66 |
| D25P.L70.ERC20RG | 25 | 68 |
| D25P.L70.ERC25RG | 25 | 69 |
| D25P.L70.ERC32RG | 25 | 70 |
| D25P.L70.ERC40RG | 25 | 104 |
| D32P.L70.ERC16RG | 32 | 66 |
| D32P.L70.ERC20RG | 32 | 68 |
| D32P.L70.ERC25RG | 32 | 69 |
| D32P.L70.ERC32RG | 32 | 70 |
| D32P.L70.ERC40RG | 32 | 104 |
| D40P.L70.ERC16RG | 40 | 64 |
| D40P.L70.ERC20RG | 40 | 66 |
| D40P.L70.ERC25RG | 40 | 67 |
| D40P.L70.ERC32RG | 40 | 68 |
| D40P.L70.ERC40RG | 40 | 102 |

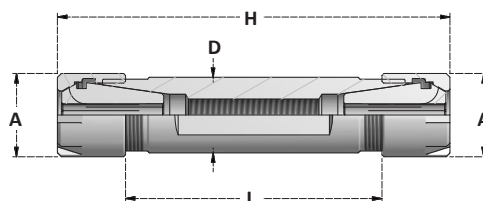
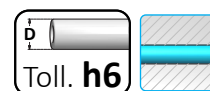
| | A | Collets Range | Ghiera Nut |
|----------|----|---------------|------------|
| ...ERC16 | 28 | 1÷10 | G16SE |
| ...ERC20 | 34 | 1÷14 | G20SE |
| ...ERC25 | 42 | 1÷20 | G25S |
| ...ERC32 | 50 | 2÷22 | G32S |
| ...ERC40 | 63 | 3÷30 | G40S |



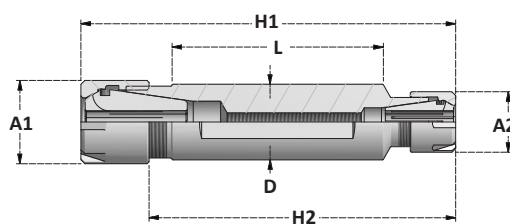
Allentare le viti **B** e regolare la centratura tramite le viti **A**.
Loosen screws **B** and use screws **A** for radial adjustment.

ACCESSORI - ACCESSORIES



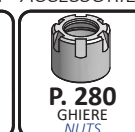
**MANDRINI PORTAPINZA ER CON GHIERA MINI DOPPI**
DOUBLE ER COLLET CHUCKS WITH MINI NUTSCHEDA TECNICA
TECHNICAL DATA
ERC | P. 338

| Articolo | D | A | L | H | Collets Range | Ghiera Nut |
|----------------------|----|----|-----|-----|---------------|------------|
| D16P.L40.ERC11M-11M | 16 | 16 | 40 | 71 | 1÷7 | G11M |
| D20P.L42.ERC11M-11M | 20 | 16 | 42 | 70 | 1÷7 | G11M |
| D20P.L52.ERC11M-11M | 20 | 16 | 52 | 80 | 1÷7 | G11M |
| D20P.L62.ERC11M-11M | 20 | 16 | 62 | 90 | 1÷7 | G11M |
| D20P.L37.ERC16M-16M | 20 | 22 | 37 | 80 | 1÷10 | G16M |
| D20P.L57.ERC16M-16M | 20 | 22 | 57 | 100 | 1÷10 | G16M |
| D20P.L67.ERC16M-16M | 20 | 22 | 67 | 110 | 1÷10 | G16M |
| D20P.L122.ERC16M-16M | 20 | 22 | 122 | 165 | 1÷10 | G16M |
| D22P.L27.ERC16M-16M | 22 | 22 | 27 | 70 | 1÷10 | G16M |
| D22P.L47.ERC16M-16M | 22 | 22 | 47 | 90 | 1÷10 | G16M |
| D22P.L67.ERC16M-16M | 22 | 22 | 67 | 110 | 1÷10 | G16M |
| D22P.L102.ERC16M-16M | 22 | 22 | 102 | 145 | 1÷10 | G16M |
| D22P.L122.ERC16M-16M | 22 | 22 | 122 | 165 | 1÷10 | G16M |
| D25P.L27.ERC16M-16M | 25 | 22 | 27 | 70 | 1÷10 | G16M |
| D25P.L47.ERC16M-16M | 25 | 22 | 47 | 90 | 1÷10 | G16M |
| D25P.L67.ERC16M-16M | 25 | 22 | 67 | 110 | 1÷10 | G16M |
| D25P.L82.ERC20M-20M | 25 | 28 | 82 | 130 | 1÷14 | G20M |
| D32P.L57.ERC20M-20M | 32 | 28 | 57 | 105 | 1÷14 | G20M |
| D32P.L82.ERC20M-20M | 32 | 28 | 82 | 130 | 1÷14 | G20M |

SCHEDA TECNICA
TECHNICAL DATA
ERC | P. 338

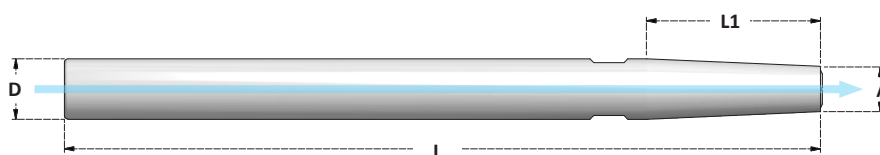
| Articolo | D | A1 | A2 | L | H1 | H2 | Collets Range | Ghiera Nut | Collets Range | Ghiera Nut |
|---------------------|----|----|----|----|-----|----|---------------|------------|---------------|------------|
| D20P.L50.ERC16M-11M | 20 | 22 | 16 | 50 | 85 | 68 | 1÷10 | G16M | 1÷7 | G11M |
| D20P.L50.ERC20M-11M | 20 | 28 | 16 | 50 | 91 | 72 | 1÷14 | G20M | 1÷7 | G11M |
| D22P.L45.ERC20M-16M | 22 | 28 | 22 | 45 | 90 | 71 | 1÷14 | G20M | 1÷10 | G16M |
| D22P.L60.ERC20M-16M | 22 | 28 | 22 | 60 | 105 | 86 | 1÷14 | G20M | 1÷10 | G16M |
| D25P.L45.ERC20M-16M | 25 | 28 | 22 | 45 | 90 | 71 | 1÷14 | G20M | 1÷10 | G16M |
| D25P.L60.ERC20M-16M | 25 | 28 | 22 | 60 | 105 | 86 | 1÷14 | G20M | 1÷10 | G16M |
| D25P.L45.ERC25M-16M | 25 | 35 | 22 | 45 | 91 | 71 | 1÷20 | G25M | 1÷10 | G16M |
| D32P.L60.ERC25M-20M | 32 | 35 | 28 | 60 | 108 | 88 | 1÷20 | G25M | 1÷14 | G20M |

ACCESSORI - ACCESSORIES

P. 250
PINZE
COLLETSP. 280
GHIERE
NUTSP. 288
CHIAVI
WRENCHES



PROLUNGHE CILINDRICHE PORTAPINZA SLC CYLINDRICAL EXTENSIONS SLC COLLET CHUCKS



| Articolo | D | A | L | L1 | |
|----------------------|---|----|----|-----|------|
| D12.L120.SLC6 | * | 12 | 12 | 120 | - |
| D12.L150.SLC6 | * | 12 | 12 | 150 | - |
| D16.L120.SLC6 | | 16 | 12 | 120 | 48 |
| D16.L150.SLC6 | | 16 | 12 | 150 | 48 |
| D16.L200.SLC6 | | 16 | 12 | 200 | 48 |
| D20.L120.SLC6 | | 20 | 12 | 120 | 76,5 |
| D20.L150.SLC6 | | 20 | 12 | 150 | 86 |
| D20.L200.SLC6 | | 20 | 12 | 200 | 76,5 |



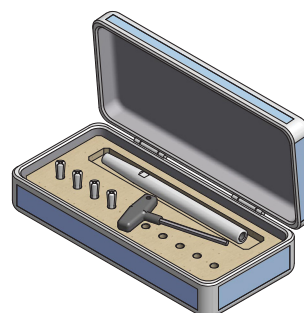
| Articolo | D | A | L | L1 | |
|-----------------------|---|----|----|-----|----|
| D25.L120.SLC12 | | 25 | 22 | 120 | 50 |
| D25.L150.SLC12 | | 25 | 22 | 150 | 50 |
| D25.L200.SLC12 | | 25 | 22 | 200 | 50 |

*** FORNITI CON VITE ESAGONALE PER IL SERRAGGIO E L'ESTRAZIONE DELLA PINZA. VA RIMOSSA UNA VOLTA SERRATO L'UTENSILE.**
*** SUPPLIED WITH HEXAGONAL SCREW FOR COLLET'S TIGHTENING AND EXTRACTION. IT MUST BE REMOVED ONCE THE TOOL IS TIGHTENED.**

KIT - MANDRINO, CHIAVE E PINZE

KIT - TOOLHOLDER, WRENCH AND COLLETS

| Articolo | Pinze Collets | Mandrino con chiave Toolholder with wrench |
|-------------------------|---------------------|--|
| BX.D12.L120.SLC6 | SLC6.D3- D4- D5- D6 | D12.L120.SLC6 |
| BX.D12.L150.SLC6 | SLC6.D3- D4- D5- D6 | D12.L150.SLC6 |
| BX.D16.L120.SLC6 | SLC6.D3- D4- D5- D6 | D16.L120.SLC6 |
| BX.D16.L150.SLC6 | SLC6.D3- D4- D5- D6 | D16.L150.SLC6 |
| BX.D16.L200.SLC6 | SLC6.D3- D4- D5- D6 | D16.L200.SLC6 |
| BX.D20.L120.SLC6 | SLC6.D3- D4- D5- D6 | D20.L120.SLC6 |
| BX.D20.L150.SLC6 | SLC6.D3- D4- D5- D6 | D20.L150.SLC6 |
| BX.D20.L200.SLC6 | SLC6.D3- D4- D5- D6 | D20.L200.SLC6 |



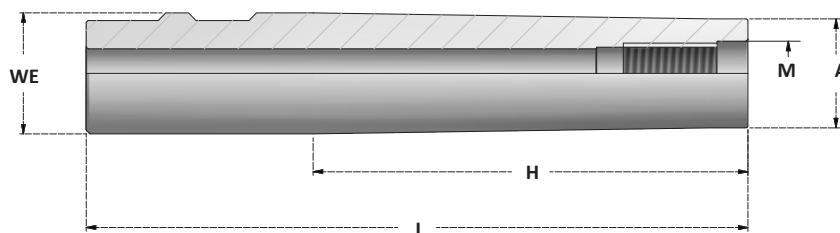
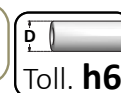
| Articolo | Pinze Collets | Mandrino con chiave Toolholder with wrench |
|--------------------------|----------------------------|--|
| BX.D25.L120.SLC12 | SLC12.D4- D6- D8- D10- D12 | D25.L120.SLC12 |
| BX.D25.L150.SLC12 | SLC12.D4- D6- D8- D10- D12 | D25.L150.SLC12 |
| BX.D25.L200.SLC12 | SLC12.D4- D6- D8- D10- D12 | D25.L200.SLC12 |

ACCESSORI - ACCESSORIES



**PROLUNGHE CON PIANI WELDON
PER FRESE CON ATTACCO FILETTATO**

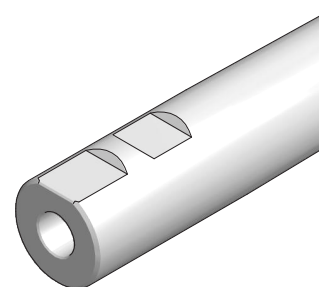
SCREW IN MILL EXTENSIONS WITH DIN1835 FLATS

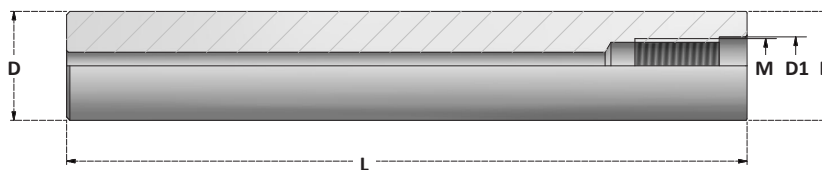


| Articolo | WE | L | H |
|-------------------------|----|-----|-----|
| WE20.L75.M8CPY | 20 | 75 | 25 |
| WE20.L100.M8CPY | 20 | 100 | 50 |
| WE20.L125.M8CPY | 20 | 125 | 75 |
| WE20.L150.M8CPY | 20 | 150 | 100 |
| WE20.L175.M8CPY | 20 | 175 | 125 |
| WE20.L200.M8CPY | 20 | 200 | 150 |
| WE20.L75.M10CPY | 20 | 75 | 25 |
| WE20.L100.M10CPY | 20 | 100 | 50 |
| WE20.L125.M10CPY | 20 | 125 | 75 |
| WE20.L150.M10CPY | 20 | 150 | 100 |
| WE20.L175.M10CPY | 20 | 175 | 125 |
| WE20.L200.M10CPY | 20 | 200 | 150 |
| WE25.L75.M12CPY | 25 | 75 | 19 |
| WE25.L100.M12CPY | 25 | 100 | 44 |
| WE25.L125.M12CPY | 25 | 125 | 69 |
| WE25.L150.M12CPY | 25 | 150 | 94 |
| WE25.L175.M12CPY | 25 | 175 | 119 |
| WE25.L200.M12CPY | 25 | 200 | 104 |
| WE32.L75.M16CPY | 32 | 75 | 15 |
| WE32.L100.M16CPY | 32 | 100 | 40 |
| WE32.L125.M16CPY | 32 | 125 | 65 |
| WE32.L150.M16CPY | 32 | 150 | 90 |
| WE32.L175.M16CPY | 32 | 175 | 115 |
| WE32.L200.M16CPY | 32 | 200 | 140 |

| | M | A | MT |
|---------------|-----|------|------|
| M8CPY | M8 | 12,8 | 25Nm |
| M10CPY | M10 | 17,8 | 40Nm |
| M12CPY | M12 | 20,8 | 60Nm |
| M16CPY | M16 | 28,8 | 80Nm |

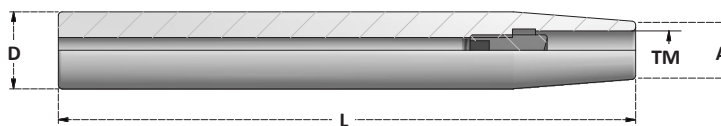
Momento torcente consigliato: **MT**
Recommended tightening torque:



**PROLUNGHE HM PER FRESE CON ATTACCO FILETTATO**
HM SCREW IN MILL EXTENSIONS

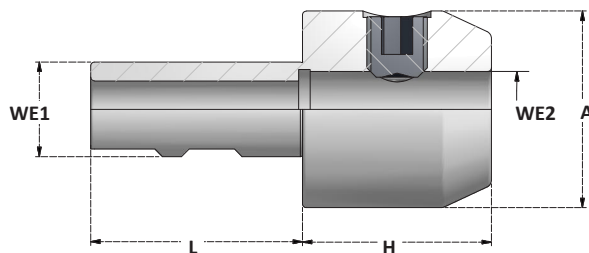
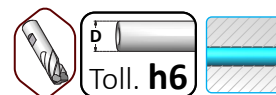
| Articolo | D | L | D1 | M |
|---------------------|----|-----|------|-----|
| D10.L100.M6 | 10 | 100 | 6,5 | M6 |
| D10.L125.M6 | 10 | 125 | 6,5 | M6 |
| D10.L150.M6 | 10 | 150 | 6,5 | M6 |
| D12.L100.M6 | 12 | 100 | 6,5 | M6 |
| D12.L125.M6 | 12 | 125 | 6,5 | M6 |
| D12.L150.M6 | 12 | 150 | 6,5 | M6 |
| D16.L100.M8 | 16 | 100 | 8,5 | M8 |
| D16.L150.M8 | 16 | 150 | 8,5 | M8 |
| D16.L200.M8 | 16 | 200 | 8,5 | M8 |
| D20.L100.M10 | 20 | 100 | 10,5 | M10 |
| D20.L150.M10 | 20 | 150 | 10,5 | M10 |
| D20.L200.M10 | 20 | 200 | 10,5 | M10 |
| D20.L250.M10 | 20 | 250 | 10,5 | M10 |
| D20.L300.M10 | 20 | 300 | 10,5 | M10 |
| D25.L100.M12 | 25 | 100 | 12,5 | M12 |
| D25.L150.M12 | 25 | 150 | 12,5 | M12 |
| D25.L200.M12 | 25 | 200 | 12,5 | M12 |
| D25.L250.M12 | 25 | 250 | 12,5 | M12 |
| D25.L300.M12 | 25 | 300 | 12,5 | M12 |
| D32.L150.M16 | 32 | 150 | 17 | M16 |
| D32.L200.M16 | 32 | 200 | 17 | M16 |
| D32.L250.M16 | 32 | 250 | 17 | M16 |
| D32.L300.M16 | 32 | 300 | 17 | M16 |

IL MATERIALE DI COSTRUZIONE SMORZA LE VIBRAZIONI
CONSTRUCTION MATERIAL DAMPENS VIBRATIONS

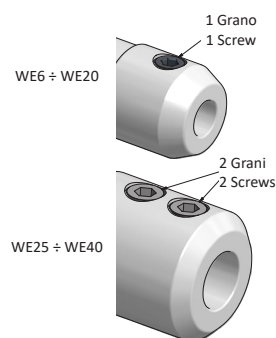
**PROLUNGHE CILINDRICHE PER CALETTAMENTO A CALDO**
CYLINDRICAL SHRINK FIT EXTENSIONS

| Articolo | D | TM | A | L |
|----------------------|----|----|----|-----|
| D12.L80.TM3 | 12 | 3 | 9 | 80 |
| D12.L120.TM3 | 12 | 3 | 9 | 120 |
| D12.L160.TM3 | 12 | 3 | 9 | 160 |
| D12.L80.TM4 | 12 | 4 | 10 | 80 |
| D12.L120.TM4 | 12 | 4 | 10 | 120 |
| D12.L160.TM4 | 12 | 4 | 10 | 160 |
| D16.L80.TM3 | 16 | 3 | 9 | 80 |
| D16.L120.TM3 | 16 | 3 | 9 | 120 |
| D16.L160.TM3 | 16 | 3 | 9 | 160 |
| D16.L80.TM4 | 16 | 4 | 10 | 80 |
| D16.L120.TM4 | 16 | 4 | 10 | 120 |
| D16.L160.TM4 | 16 | 4 | 10 | 160 |
| D16.L80.TM5 | 16 | 5 | 11 | 80 |
| D16.L120.TM5 | 16 | 5 | 11 | 120 |
| D16.L160.TM5 | 16 | 5 | 11 | 160 |
| D16.L80.TM6 | 16 | 6 | 12 | 80 |
| D16.L120.TM6 | 16 | 6 | 12 | 120 |
| D16.L160.TM6 | 16 | 6 | 12 | 160 |
| D20.L120.TM6 | 20 | 6 | 12 | 120 |
| D20.L160.TM6 | 20 | 6 | 12 | 160 |
| D20.L200.TM6 | 20 | 6 | 12 | 200 |
| D20.L120.TM8 | 20 | 8 | 16 | 120 |
| D20.L160.TM8 | 20 | 8 | 16 | 160 |
| D20.L200.TM8 | 20 | 8 | 16 | 200 |
| D20.L120.TM10 | 20 | 10 | 16 | 120 |
| D20.L160.TM10 | 20 | 10 | 16 | 160 |
| D20.L200.TM10 | 20 | 10 | 16 | 200 |
| D20.L120.TM12 | 20 | 12 | 18 | 120 |
| D20.L160.TM12 | 20 | 12 | 18 | 160 |
| D20.L200.TM12 | 20 | 12 | 18 | 200 |
| D25.L120.TM12 | 25 | 12 | 18 | 120 |
| D25.L160.TM12 | 25 | 12 | 18 | 160 |
| D25.L200.TM12 | 25 | 12 | 18 | 200 |
| D25.L120.TM14 | 25 | 14 | 20 | 120 |
| D25.L160.TM14 | 25 | 14 | 20 | 160 |
| D25.L200.TM14 | 25 | 14 | 20 | 200 |
| D25.L120.TM16 | 25 | 16 | 25 | 120 |
| D25.L160.TM16 | 25 | 16 | 25 | 160 |
| D25.L200.TM16 | 25 | 16 | 25 | 200 |



**RIDUZIONI WELDON**
END MILL SHANK ADAPTERSSCHEDA TECNICA
TECHNICAL DATA
WE P. 347

| Articolo | WE1 | WE2 | A | L | H |
|---------------|-----|-----|----|----|----|
| WE20.H30.WE6 | 20 | 6 | 25 | 50 | 30 |
| WE20.H30.WE8 | 20 | 8 | 28 | 50 | 30 |
| WE20.H30.WE10 | 20 | 10 | 35 | 50 | 30 |
| WE20.H35.WE12 | 20 | 12 | 42 | 50 | 35 |
| WE20.H59.WE14 | 20 | 14 | 44 | 50 | 59 |
| WE20.H59.WE16 | 20 | 16 | 48 | 50 | 59 |
| WE25.H25.WE6 | 25 | 6 | 25 | 56 | 25 |
| WE25.H27.WE8 | 25 | 8 | 28 | 56 | 27 |
| WE25.H35.WE14 | 25 | 14 | 44 | 56 | 35 |
| WE25.H38.WE16 | 25 | 16 | 48 | 56 | 38 |
| WE32.H25.WE6 | 32 | 6 | 25 | 60 | 25 |
| WE32.H25.WE8 | 32 | 8 | 28 | 60 | 25 |
| WE32.H30.WE10 | 32 | 10 | 35 | 60 | 30 |
| WE32.H35.WE12 | 32 | 12 | 42 | 60 | 35 |
| WE32.H35.WE14 | 32 | 14 | 44 | 60 | 35 |
| WE32.H40.WE16 | 32 | 16 | 48 | 60 | 40 |
| WE32.H40.WE18 | 32 | 18 | 50 | 60 | 40 |
| WE32.H40.WE20 | 32 | 20 | 52 | 60 | 40 |
| WE32.H65.WE25 | 32 | 25 | 65 | 60 | 65 |

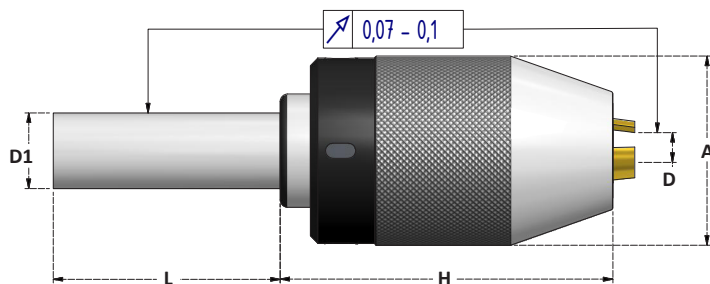


ACCESSORI - ACCESSORIES





MANDRINI PORTAPUNTA AUTOSERRANTI - ROTAZIONE DESTRA
DRILL CHUCKS - RIGHT ROTATION



| Articolo | Range D | D1 | H | L | A | Chiave Wrench |
|-----------------------|----------|----|----|----|------|---------------|
| D20.L60.DCK8S | 0,5 - 8 | 20 | 61 | 60 | 37,5 | CH.DC8 |
| D20.L60.DCK13S | 1 - 13 | 20 | 81 | 60 | 50,5 | CH.DC13 |
| D20.L60.DCK16S | 2,5 - 16 | 20 | 85 | 60 | 57 | CH.DC16 |
| D25.L79.DCK13S | 1 - 13 | 25 | 81 | 79 | 50,5 | CH.DC13 |
| D25.L80.DCK16S | 2,5 - 16 | 25 | 85 | 80 | 57 | CH.DC16 |
| D32.L81.DCK13S | 1 - 13 | 32 | 81 | 81 | 50,5 | CH.DC13 |
| D32.L82.DCK16S | 2,5 - 16 | 32 | 85 | 82 | 57 | CH.DC16 |

**GRIFFE RIVESTITE
IN TITANIO**

**TITANIUM
COATED JAWS**

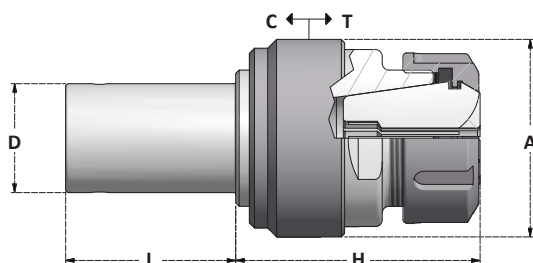
ACCESSORI - ACCESSORIES



**MANDRINI PORTAMASCHI**
TAPPING CHUCKS**PM-ERC PORTAPINZA ER PER MASCHIATURA CON COMPENSAZIONE A TRAZIONE E COMPRESSIONE**Pag. 231 *TENSION AND COMPRESSION ER COLLET TAP HOLDERS***PMT-ERC PORTAMASCHI CON COMPENSAZIONE ASSIALE SOLO A TRAZIONE**Pag. 232 *TENSION ONLY ER COLLETS TAP HOLDERS***SY MANDRINI PER MASCHIATURA SINCRONIZZATA**Pag. 233 *TAPPING CHUCKS FOR SYNCHRONIZED TAPPING***MCR-TC MASCHIATORI A CAMBIO RAPIDO CON COMPENSAZIONE ASSIALE**Pag. 233 *QUICK CHANGE TAPPING CHUCKS WITH AXIAL COMPENSATION*

D PM

ERC

DIN ISO 15488 (DIN6499)**PORTAPINZA ER PER MASCHIATURA CON COMPENSAZIONE A TRAZIONE E COMPRESSIONE**
TENSION AND COMPRESSION ER COLLET TAP HOLDERSCorsa di compressione: **C**
*Compression stroke:*Corsa di trazione: **T**
Extension stroke:

| Articolo | D | L | H |
|------------------------|----|----|----|
| D16PM.L32.ERC11 | 16 | 32 | 36 |
| D20PM.L32.ERC11 | 20 | 32 | 36 |

| Articolo | D | L | H |
|------------------------|----|----|----|
| D16PM.L32.ERC16 | 16 | 32 | 48 |
| D20PM.L32.ERC16 | 20 | 32 | 48 |

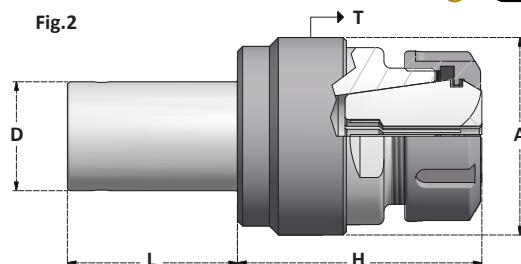
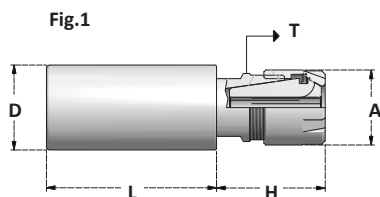
| Articolo | D | L | H |
|------------------------|----|----|----|
| D20PM.L46.ERC20 | 20 | 46 | 59 |
| D25PM.L46.ERC20 | 25 | 46 | 59 |

| Articolo | D | L | H |
|------------------------|----|----|----|
| D20PM.L46.ERC25 | 20 | 46 | 73 |
| D25PM.L50.ERC25 | 25 | 50 | 68 |
| D25PM.L80.ERC25 | 25 | 80 | 68 |
| D32PM.L50.ERC25 | 32 | 50 | 68 |
| D40PM.L85.ERC25 | 40 | 85 | 68 |

| Articolo | D | L | H |
|------------------------|----|----|----|
| D25PM.L50.ERC32 | 25 | 50 | 70 |
| D25PM.L80.ERC32 | 25 | 80 | 70 |
| D32PM.L50.ERC32 | 32 | 50 | 70 |
| D40PM.L85.ERC32 | 40 | 85 | 70 |

| Articolo | A | C | T | Tapping Range | Collets Range | Ghiera Nut |
|------------------------|----|-----|-----|---------------|---------------|------------|
| ...PM...ERC11 | 29 | 2,5 | 5,5 | M3 ÷ M10 | 1÷7 | G11SE |
| ...PM...ERC16 | 29 | 2,5 | 5,5 | M3 ÷ M12 | 3,5 ÷ 10 | G16SE |
| ...PM...ERC20 | 44 | 3 | 9 | M3 ÷ M16 | 3,5 ÷ 12 | G20SE |
| D20PM.L46.ERC25 | 44 | 3 | 9 | M3 ÷ M20 | 3,5 ÷ 16 | G25S |
| ...PM...ERC25 | 58 | 4 | 12 | M3 ÷ M20 | 3,5 ÷ 16 | G25S |
| ...PM...ERC32 | 58 | 4 | 12 | M3 ÷ M27 | 3,5 ÷ 20 | G32S |

ACCESSORI - ACCESSORIES

**PORTAPINZA ER PER MASCHIATURA CON COMPENSAZIONE SOLO A TRAZIONE**
TENSION ONLY ER COLLETS TAP HOLDERS

| Articolo | D | L | H | Fig |
|--------------------|----|-----|----|-----|
| D16PMT.L40.ERC11M | 16 | 40 | 21 | 1 |
| D20PMT.L40.ERC11M | 20 | 40 | 21 | 1 |
| D25PMT.L40.ERC11M | 25 | 40 | 21 | 1 |
| D16PMT.L40.ERC16M | 16 | 40 | 36 | 1 |
| D20PMT.L50.ERC16M | 20 | 50 | 30 | 1 |
| D20PMT.L70.ERC16M | 20 | 70 | 30 | 1 |
| D20PMT.L120.ERC16M | 20 | 120 | 30 | 1 |
| D25PMT.L50.ERC16M | 25 | 50 | 30 | 1 |
| D25PMT.L70.ERC16M | 25 | 70 | 30 | 1 |
| D25PMT.L120.ERC16M | 25 | 120 | 30 | 1 |
| D20PMT.L50.ERC20M | 20 | 50 | 40 | 1 |
| D20PMT.L70.ERC20M | 20 | 70 | 40 | 1 |
| D20PMT.L120.ERC20M | 20 | 120 | 40 | 1 |
| D25PMT.L50.ERC20M | 25 | 50 | 40 | 1 |
| D25PMT.L70.ERC20M | 25 | 70 | 40 | 1 |
| D25PMT.L120.ERC20M | 25 | 120 | 40 | 1 |
| D20PMT.L50.ERC25M | 20 | 50 | 42 | 1 |
| D20PMT.L70.ERC25M | 20 | 70 | 42 | 1 |
| D20PMT.L120.ERC25M | 20 | 120 | 42 | 1 |
| D25PMT.L50.ERC25M | 25 | 50 | 42 | 1 |
| D25PMT.L70.ERC25M | 25 | 70 | 42 | 1 |
| D25PMT.L120.ERC25M | 25 | 120 | 42 | 1 |

| Articolo | A | T | Tapping Range | Collets Range | Ghiera Nut |
|-----------------|----|----|---------------|---------------|------------|
| ...PMT...ERC11M | 16 | 10 | M3 ÷ M10 | 1÷7 | G11M |
| ...PMT...ERC16M | 22 | 14 | M3 ÷ M12 | 3,5 ÷ 10 | G16M |
| ...PMT...ERC20M | 28 | 14 | M3 ÷ M16 | 3,5 ÷ 12 | G20M |
| ...PMT...ERC25M | 35 | 14 | M3 ÷ M20 | 3,5 ÷ 16 | G25M |

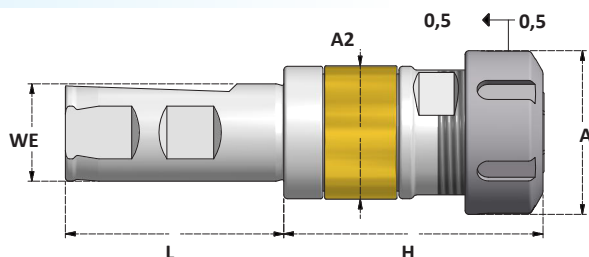
Corsa di trazione: **T**
Extension stroke:

| Articolo | D | L | H | Fig |
|------------------|----|----|----|-----|
| D16PMT.L32.ERC11 | 16 | 32 | 36 | 2 |
| D20PMT.L32.ERC11 | 20 | 32 | 36 | 2 |
| D16PMT.L32.ERC16 | 16 | 32 | 48 | 2 |
| D20PMT.L32.ERC16 | 20 | 32 | 48 | 2 |
| D20PMT.L46.ERC20 | 20 | 46 | 56 | 2 |
| D25PMT.L46.ERC20 | 25 | 46 | 56 | 2 |
| D20PMT.L46.ERC25 | 20 | 46 | 70 | 2 |
| D25PMT.L50.ERC25 | 25 | 50 | 64 | 2 |
| D25PMT.L80.ERC25 | 25 | 80 | 64 | 2 |
| D32PMT.L50.ERC25 | 32 | 50 | 64 | 2 |
| D40PMT.L85.ERC25 | 40 | 85 | 64 | 2 |
| D25PMT.L50.ERC32 | 25 | 50 | 66 | 2 |
| D25PMT.L80.ERC32 | 25 | 80 | 66 | 2 |
| D32PMT.L50.ERC32 | 32 | 50 | 64 | 2 |
| D40PMT.L85.ERC32 | 40 | 85 | 64 | 2 |

| Articolo | A | T | Tapping Range | Collets Range | Ghiera Nut |
|----------------|----|----|---------------|---------------|------------|
| ...PMT...ERC11 | 29 | 8 | M3 ÷ M10 | 1÷7 | G11SE |
| ...PMT...ERC16 | 29 | 8 | M3 ÷ M12 | 3,5 ÷ 10 | G16MSE |
| ...PMT...ERC20 | 44 | 12 | M3 ÷ M16 | 3,5 ÷ 12 | G20SE |
| ...PMT...ERC25 | 58 | 16 | M3 ÷ M20 | 3,5 ÷ 16 | G25S |
| ...PMT...ERC32 | 58 | 16 | M3 ÷ M27 | 3,5 ÷ 20 | G32S |

ACCESSORI - ACCESSORIES



**MANDRINI PER MASCHIATURA SINCRONIZZATA**
TAPPING CHUCKS FOR SYNCHRONIZED TAPPING

| Articolo | WE | L | H |
|----------------------|----|----|----|
| WE20.ERC16MSY | 20 | 51 | 58 |

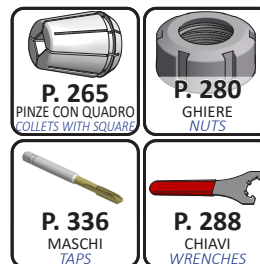
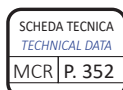
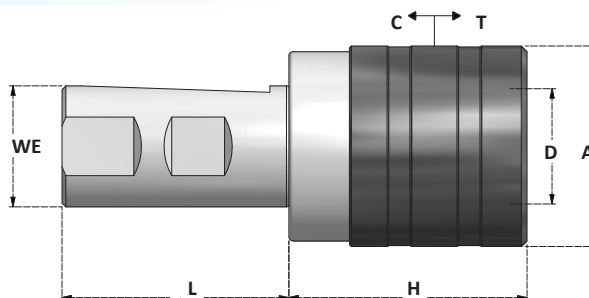
| Articolo | WE | L | H |
|---------------------|----|----|-----|
| WE25.ERC20SY | 25 | 56 | 61 |
| WE25.ERC25SY | 25 | 56 | 65 |
| WE25.ERC32SY | 25 | 56 | 87 |
| WE32.ERC40SY | 32 | 61 | 108 |

| | A | A2 | Collets Range | Tapping Range | Ghiera Nut |
|--------------------|----|----|---------------|---------------|------------|
| ...ERC16MSY | 22 | 34 | 3,5 ÷ 10 | M3 ÷ M12 | G16M |
| ...ERC20SY | 35 | 34 | 3,5 ÷ 12 | M3 ÷ M16 | G20S |
| ...ERC25SY | 42 | 45 | 3,5 ÷ 16 | M3 ÷ M20 | G25S |
| ...ERC32SY | 50 | 45 | 3,5 ÷ 20 | M3 ÷ M27 | G32S |
| ...ERC40SY | 63 | 62 | 6 ÷ 25 | M5 ÷ M33 | G40S |

VANTAGGI*ADVANTAGES*

- PASSAGGIO DEL REFRIGERANTE
- ADATTO PER MASCHIATURA AD ALTE VELOCITÀ
- SISTEMA PORTAPINZE ER

- COOLANT THROUGH
- SUITABLE FOR HIGH SPEED TAPPING
- ER COLLET SYSTEM

ACCESSORI - ACCESSORIES**DIN 1835-1 Form B****MASCHIATORI A CAMBIO RAPIDO CON COMPENSAZIONE ASSIALE**
QUICK CHANGE TAPPING CHUCKS WITH AXIAL COMPENSATION

Corsa di compressione:
Compression stroke: **C**

Corsa di trazione:
Extension stroke: **T**

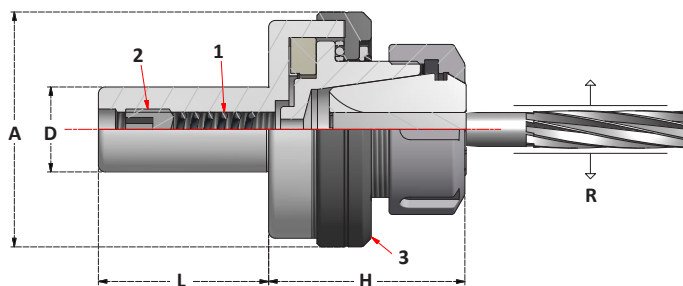
| Articolo | WE | H | L |
|--------------------|----|-----|----|
| WE20.MCR1TC | 20 | 40 | 50 |
| WE25.MCR1TC | 25 | 40 | 56 |
| WE25.MCR2TC | 25 | 63 | 56 |
| WE32.MCR1TC | 32 | 40 | 56 |
| WE32.MCR2TC | 32 | 63 | 60 |
| WE32.MCR3TC | 32 | 125 | 60 |
| WE40.MCR1TC | 40 | 40 | 70 |
| WE40.MCR2TC | 40 | 63 | 70 |
| WE40.MCR3TC | 40 | 125 | 70 |
| WE40.MCR4TC | 40 | 126 | 70 |

| | Bussola Adapter | D | Tapping Range | A | T | C |
|-----------------|-----------------|----|---------------|----|------|------|
| ..MCR1TC | B1 / BF1 | 19 | M2÷M14 | 36 | 7,5 | 7,5 |
| ..MCR2TC | B2 / BF2 | 31 | M6÷M27 | 53 | 12,5 | 12,5 |
| ..MCR3TC | B3 / BF3 | 48 | M14÷M45 | 78 | 20 | 20 |
| ..MCR4TC | BF4 | 60 | M22÷M45 | 96 | 22,5 | 22,5 |

ACCESSORI - ACCESSORIES

**PORTA ALESATORI FLOTTANTI CON REFRIGERAZIONE INTERNA**
FLOATING REAMER HOLDERS WITH COOLANT THROUGH

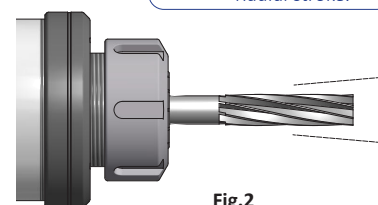
SCHEDA TECNICA
TECHNICAL DATA
RM P. 354



| Articolo | D | L | H |
|--------------|----|----|----|
| D16.L46.RM11 | 16 | 46 | 40 |
| D20.L46.RM11 | 20 | 46 | 40 |
| D16.L46.RM16 | 16 | 46 | 44 |
| D20.L46.RM16 | 20 | 46 | 44 |
| D25.L46.RM16 | 25 | 46 | 44 |
| D16.L46.RM20 | 16 | 46 | 50 |
| D20.L46.RM20 | 20 | 46 | 50 |
| D25.L46.RM20 | 25 | 46 | 50 |
| D16.L46.RM25 | 16 | 46 | 53 |
| D20.L46.RM25 | 20 | 46 | 53 |
| D25.L46.RM25 | 25 | 46 | 53 |
| D32.L46.RM25 | 32 | 46 | 53 |
| D25.L50.RM32 | 25 | 50 | 53 |
| D32.L50.RM32 | 32 | 50 | 53 |
| D25.L50.RM40 | 25 | 50 | 64 |
| D32.L50.RM40 | 32 | 50 | 64 |

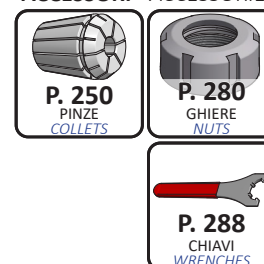
| Articolo | A | R | Collets Range | Ghiera Nut |
|----------|----|----------|---------------|------------|
| ...RM11 | 42 | ± 1 mm | 1÷7 | G11A.EX |
| ...RM16 | 42 | ± 1 mm | 1÷10 | G16SE |
| ...RM20 | 50 | ± 1 mm | 1÷14 | G20SE |
| ...RM25 | 57 | ± 1 mm | 1÷20 | G25S |
| ...RM32 | 69 | ± 1,5 mm | 2÷22 | G32S |
| ...RM40 | 79 | ± 1,5 mm | 3÷30 | G40S |

Movimento radiale: **R**
Radial stroke:



| Articolo | D | L | H |
|-----------------|--------|----|----|
| D5/8.L46.RM11 | 15,875 | 46 | 40 |
| D3/4.L46.RM11 | 19,05 | 46 | 40 |
| D1".L46.RM11 | 25,4 | 46 | 40 |
| D5/8.L46.RM16 | 15,875 | 46 | 44 |
| D3/4.L46.RM16 | 19,05 | 46 | 44 |
| D1".L46.RM16 | 25,4 | 46 | 44 |
| D3/4.L46.RM20 | 19,5 | 46 | 50 |
| D1".L46.RM20 | 25,4 | 46 | 50 |
| D3/4.L46.RM25 | 19,5 | 46 | 53 |
| D1".L46.RM25 | 25,4 | 46 | 53 |
| D1".L50.RM32 | 25,4 | 50 | 58 |
| D1-1/4.L50.RM32 | 31,75 | 50 | 58 |
| D1".L50.RM40 | 25,4 | 50 | 64 |
| D1-1/4.L50.RM40 | 31,75 | 50 | 64 |

ACCESSORI - ACCESSORIES



L'alesatore oscilla su un cuscinetto a sfere per compensare gli errori di allineamento tra il mandrino della macchina e il pezzo in lavorazione.

- La spinta della molla **1** mantiene l'utensile centrato anche in posizione orizzontale.
- La vite **2** regola la pressione della molla per regolare il movimento radiale.
- Allentando di 0,1/0,2mm la ghiera **3** si permette all'alesatore di avere un movimento pendolare. (Fig 2)

Free moving ball bearing drive permits to reamer to follow drilled hole of workpiece.

- Pressure of spring **1** keeps reamer centered, even in horizontal position.
- Screw **2** allows adjustment of floating level.
- Unscrewing nut **3** for 0,1/0,2mm the reamer has a pendulum float. (Fig 2)

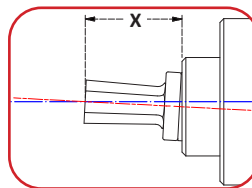
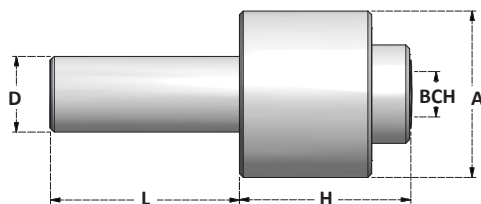
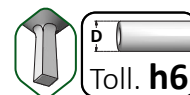




D

BCH

BROCCIATORI FISSI BROACH HOLDERS



SCHEDA TECNICA
TECHNICAL DATA
BCH | P. 355

| Articolo | D | BCH | A | L | H | X |
|---------------------|----|-----|----|----|----|----|
| D8.L35.BCH5 | 8 | 5 | 22 | 35 | 34 | 10 |
| D10.L35.BCH5 | 10 | 5 | 22 | 35 | 34 | 10 |
| D12.L35.BCH5 | 12 | 5 | 22 | 35 | 34 | 10 |
| D16.L35.BCH5 | 16 | 5 | 22 | 35 | 34 | 10 |
| D20.L46.BCH5 | 20 | 5 | 22 | 46 | 34 | 10 |

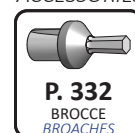
| Articolo | D | BCH | A | L | H | X |
|---------------------|----|-----|----|----|----|----|
| D10.L35.BCH8 | 10 | 8 | 32 | 35 | 38 | 18 |
| D12.L35.BCH8 | 12 | 8 | 32 | 35 | 38 | 18 |
| D16.L35.BCH8 | 16 | 8 | 32 | 35 | 38 | 18 |
| D20.L50.BCH8 | 20 | 8 | 32 | 50 | 38 | 18 |
| D25.L50.BCH8 | 25 | 8 | 32 | 50 | 38 | 18 |

| Articolo | D | BCH | A | L | H | X |
|----------------------|----|-----|----|----|----|----|
| D16.L50.BCH12 | 16 | 12 | 44 | 50 | 46 | 25 |
| D20.L50.BCH12 | 20 | 12 | 44 | 50 | 46 | 25 |
| D25.L50.BCH12 | 25 | 12 | 44 | 50 | 46 | 25 |
| D32.L50.BCH12 | 32 | 12 | 44 | 50 | 46 | 25 |

| Articolo | D | BCH | A | L | H | X |
|----------------------|----|-----|----|----|----|----|
| D20.L50.BCH16 | 20 | 16 | 58 | 50 | 76 | 40 |
| D25.L50.BCH16 | 25 | 16 | 58 | 50 | 76 | 40 |
| D32.L50.BCH16 | 32 | 16 | 58 | 50 | 76 | 40 |
| D40.L80.BCH16 | 40 | 16 | 58 | 80 | 76 | 40 |

ACCESSORI - ACCESSORIES

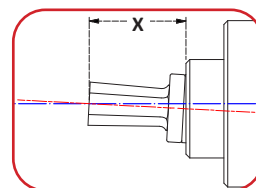
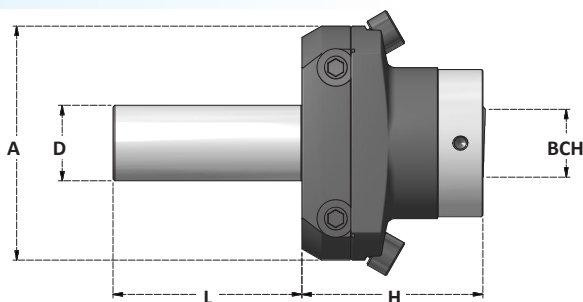
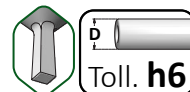
Utilizzare solo con brocche con lunghezza X
Use only broaches with lengths X



D

BCH R

BROCCIATORI REGISTRABILI ADJUSTABLE BROACH HOLDERS



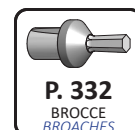
SCHEDA TECNICA
TECHNICAL DATA
BCH | P. 355

| Articolo | D | BCH | A | L | H |
|----------------------|----|-----|----|----|----|
| D10.L35.BCH8R | 10 | 8 | 50 | 35 | 34 |
| D12.L35.BCH8R | 12 | 8 | 50 | 35 | 34 |
| D16.L35.BCH8R | 16 | 8 | 50 | 35 | 34 |
| D20.L46.BCH8R | 20 | 8 | 50 | 46 | 34 |
| D25.L46.BCH8R | 25 | 8 | 50 | 46 | 34 |

| Articolo | D | BCH | A | L | H |
|-----------------------|----|-----|----|----|----|
| D20.L50.BCH12R | 20 | 12 | 62 | 50 | 52 |
| D25.L50.BCH12R | 25 | 12 | 62 | 50 | 52 |
| D32.L50.BCH12R | 32 | 12 | 62 | 50 | 52 |

Si possono usare brocche di diversa lunghezza X,
consentendo di eseguire brocciature all'interno di incamerature profonde.
You can use different broaching lengths X,
so that you can even broach inside deep chambers.

ACCESSORI - ACCESSORIES





MANDRINI PER FRESE A DISCO E SEGHE CIRCOLARI

END MILL SHANK ADAPTERS FOR SAW BLADES

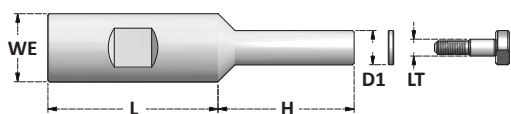
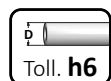


Fig.1

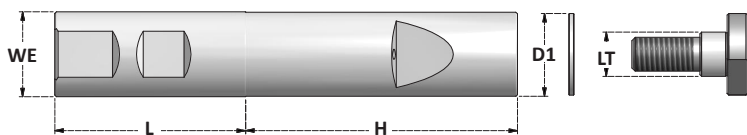
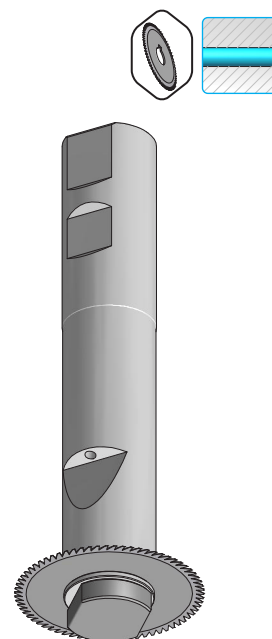


Fig.2



SENZA PASSAGGIO DEL REFRIGERANTE

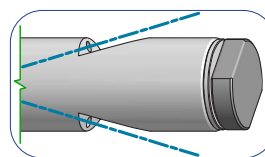
WITHOUT COOLANT CHANNELS

| Articolo | WE | D1 | LT | L | H | Fig | Per sega For saw blade |
|-----------------|----|------|----|-----|----|-----|---------------------------|
| WE20-5LT | 20 | 10,1 | 5 | 90 | 40 | 1 | Ø20 |
| WE20-8LT | 20 | 13,1 | 8 | 100 | 49 | 1 | Ø25 |

CON PASSAGGIO DEL REFRIGERANTE

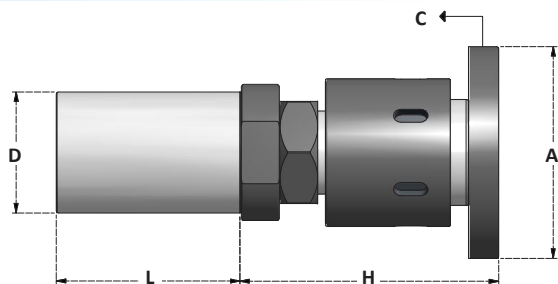
WITH COOLANT CHANNELS

| Articolo | WE | D1 | LT | L | H | Fig | Per sega For saw blade |
|------------------|----|------|----|-----|----|-----|---------------------------|
| WE20-10LT | 20 | 19,6 | 10 | 110 | 59 | 1 | Ø40 |
| WE25-13LT | 25 | 24,7 | 13 | 136 | 79 | 2 | Ø50 |
| WE25-16LT | 25 | 24,7 | 16 | 136 | 79 | 2 | Ø63 |





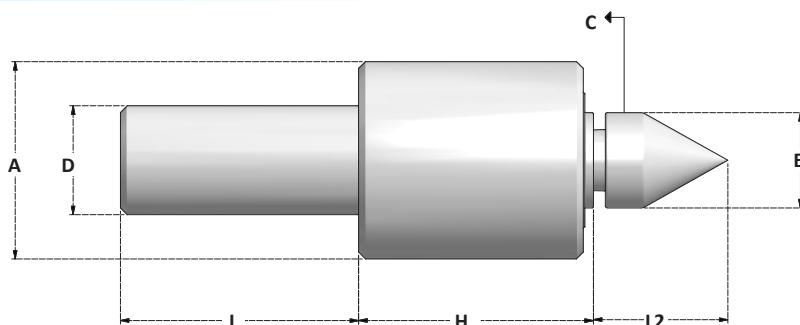
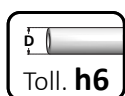
FERMO BARRA ROTANTI COMPENSATI ADJUSTABLE STOP - SHOCK ABSORBERS FOR LATHES



CORSA DI COMPRESSIONE
ABSORBER STROKE **C**

| Articolo | D | A | L | H _{min} | H _{max} | C |
|------------------|----|----|----|------------------|------------------|---|
| D20.SAS35 | 20 | 35 | 46 | 62 | 100 | 3 |
| D25.SAS35 | 25 | 35 | 50 | 62 | 100 | 3 |
| D32.SAS35 | 32 | 35 | 50 | 62 | 100 | 3 |
| D40.SAS35 | 40 | 35 | 85 | 62 | 100 | 3 |
| D25.SAS56 | 25 | 56 | 56 | 62 | 100 | 3 |
| D32.SAS56 | 32 | 56 | 56 | 62 | 100 | 3 |
| D40.SAS56 | 40 | 56 | 85 | 62 | 100 | 3 |

CONTROPUNTE ROTANTI CON COMPRESSIONE LIVE CENTRES WITH COMPRESSION



CORSA DI COMPRESSIONE
ABSORBER STROKE **C**

| Articolo | D | E | A | L | H | L2 | C |
|------------------|----|----|----|----|----|----|---|
| D16.CNP32 | 16 | 14 | 32 | 35 | 44 | 16 | 2 |
| D20.CNP32 | 20 | 14 | 32 | 46 | 44 | 16 | 2 |

| Articolo | D | E | A | L | H | L2 | C |
|------------------|----|----|----|----|----|----|---|
| D20.CNP43 | 20 | 18 | 43 | 46 | 43 | 21 | 3 |
| D25.CNP43 | 25 | 18 | 43 | 46 | 43 | 21 | 3 |
| D32.CNP43 | 32 | 18 | 43 | 46 | 43 | 21 | 3 |

| Articolo | D | E | A | L | H | L2 | C |
|------------------|----|----|----|----|----|----|-----|
| D25.CNP58 | 25 | 28 | 58 | 50 | 71 | 34 | 2,5 |
| D32.CNP58 | 32 | 28 | 58 | 70 | 71 | 34 | 2,5 |
| D40.CNP58 | 40 | 28 | 58 | 85 | 71 | 34 | 2,5 |

**FORNITI CON CUSPIDE
CNP.CS1**
SUPPLIED WITH TIP
CNP.CS1

CUSPIDI INTERCAMBIABILI
INTERCHANGEABLE TIPS

ACCESSORI - ACCESSORIES

