

CHIA-MO
WWW.CHIAMO.IT I T A L Y



CONTROPUNTE ROTANTI PER TORNI

LIVE CENTRES FOR LATHES



PELIZZARI
FAUSTINO
UTENSILI SRL

12

CONTROPUNTE ROTANTI PER TORNI

LIVE CENTRES FOR LATHES

Le contropunte rotanti vengono impiegate principalmente per lavori di tornitura su tutti i tipi di tornio con un utilizzo di giri medio/alto. Sono progettate per l'alloggiamento di cuscinetti radiali ed assiali di alta qualità su sedi rettificate e si differenziano in 3 tipologie di grandezza con diametro esterno 32, 43 e 58 per lavorazioni con carichi più o meno elevati. I modelli 172300, 172400 e 172600 sono tutti dotati di cuspidi intercambiabile per facilitare il cambio della punta in caso di usura e in caso di lavorazioni di particolari diversi. Possono essere fornite con attacco con morse, attacco cilindrico metrico e in pollici e attacco Vdi.

Descrizione e specifiche

Le contropunte rotanti sono costruite con acciaio certificato altamente legato, sono temprate e completamente rettificate. Tutto il ciclo produttivo viene svolto nel nostro stabilimento in Italia con macchine utensili di alta precisione ed è rigorosamente controllato. Grazie all'ampia disponibilità di magazzino possiamo generalmente spedire il materiale il giorno stesso della ricezione dell'ordine.

Maggiori informazioni

Oltre alla serie standard produciamo contropunte rotanti progettate con compensazione assiale grazie all'alloggiamento di una serie di molle a tazza montate all'interno del corpo contropunta. Questa compensazione le rende adatte, oltre all'utilizzo standard sulla contropunta, ad essere montate su supporti statici come per esempio il contro-mandrino del tornio, una seconda torretta del tornio ecc...

Prodotti

Contropunte rotanti per torni - Contropunte con cuspidi intercambiabile - Contropunte con compressione - Contropunte con attacco con morse, con attacco cilindrico, con attacco Vdi DIN 69880.

The live centers are mainly used for turning on all types of lathe with a medium / high r.p.m. use. They are designed to be assembled with radial and axial high quality bearings. They are manufactured in 3 types of size with outer diameter 32, 43 and 58 for machining with more or less high load. The models 172300, 172400 and 172600 are all equipped with interchangeable center to facilitate changing of the tip in case of wear and in case of workings of different details. They can be supplied with vice taper fitting, metric and inch cylindrical shaft fitting and Vdi fitting.

Description and Specifications

The live centers are produced with certified top quality steel, they are hardened and completely grinded. All production cycle is carried out in our factory in Italy with high precision machines and is carefully controlled. Thanks to the availability of stock, we can usually ship the material the same day as order is received.

Further Information

In addition to standard series we produce live centers designed with axial compensation thanks to the housing of a series of cup springs mounted into body tailstock. This compensation makes them suitable, in addition to using on the standard tailstock, to be assembled on supports static such as the counter-spindle of the lathe, a second turret of the lathe etc ...

Products

Revolving live centers for lathe - Live centers with interchangeable insert - Plug-in live centers - Live centers with Vdi DIN 69880 fitting, with vice taper fitting, with cylindrical fitting.



CONTROPUNTA ROTANTE CON COMPRESSIONE Tipo 172200
REVOLVING TAILSTOCK WITH COMPRESSION

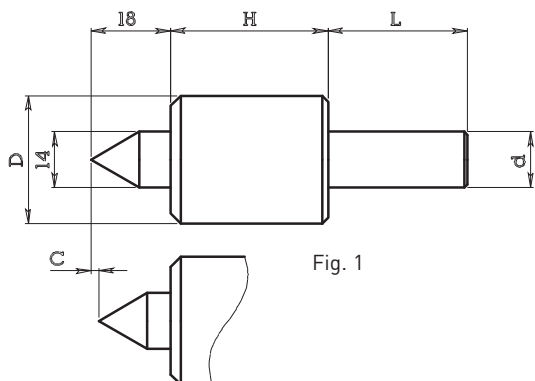
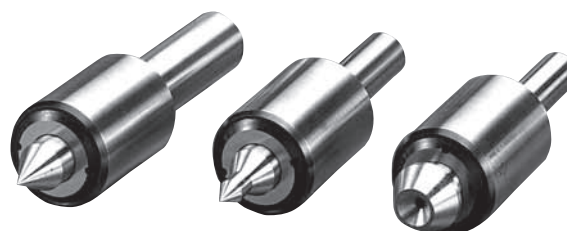

Fig. 1

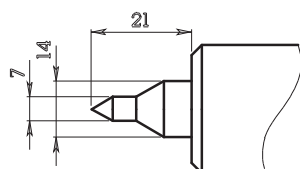

Fig. 2

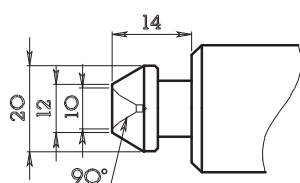

Fig. 3

C = Corsa di compressione
C = Absorber stroke

ATTACCO CILINDRICO (Cylindrical fitting)

| Art. / Code | | | d | D | H | L | C | Punta / Center |
|-------------|------------|------------|--------|----|------|----|---|----------------|
| Fig. 1 | Fig. 2 | Fig. 3 | | | | | | |
| 172.208 F1 | 172.208 F2 | 172.208 F3 | 8 | 32 | 39.5 | 35 | 2 | 60° |
| 172.210 F1 | 172.210 F2 | 172.210 F3 | 10 | 32 | 39.5 | 35 | 2 | 60° |
| 172.212 F1 | 172.212 F2 | 172.212 F3 | 12 | 32 | 39.5 | 35 | 2 | 60° |
| 172.214 F1 | 172.214 F2 | 172.214 F3 | 14 | 32 | 39.5 | 35 | 2 | 60° |
| 172.215 F1 | 172.215 F2 | 172.215 F3 | 15.875 | 32 | 39.5 | 35 | 2 | 60° |
| 172.216 F1 | 172.216 F2 | 172.216 F3 | 16 | 32 | 39.5 | 35 | 2 | 60° |
| 172.219 F1 | 172.219 F2 | 172.219 F3 | 19.05 | 32 | 39.5 | 46 | 2 | 60° |
| 172.220 F1 | 172.220 F2 | 172.220 F3 | 20 | 32 | 39.5 | 46 | 2 | 60° |
| 172.222 F1 | 172.222 F2 | 172.222 F3 | 22 | 32 | 39.5 | 46 | 2 | 60° |
| 172.225 F1 | 172.225 F2 | 172.225 F3 | 25 | 32 | 39.5 | 46 | 2 | 60° |
| 172.226 F1 | 172.226 F2 | 172.226 F3 | 25,40 | 32 | 39.5 | 46 | 2 | 60° |

ATTACCO CONO MORSE (Morse taper fitting)

| Art. / Code | | | d | D | H | L | C | Punta / Center |
|-------------|------------|------------|------|----|------|----|---|----------------|
| Fig. 1 | Fig. 2 | Fig. 3 | | | | | | |
| 172.202 F1 | 172.202 F2 | 172.202 F3 | C.M2 | 32 | 39.5 | 69 | 2 | 60° |

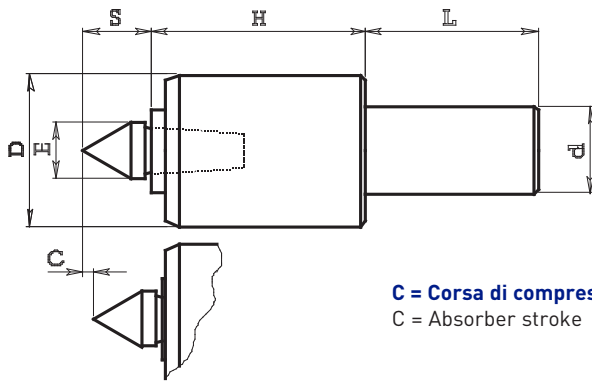
CONTROPUNTA ROTANTE CON COMPRESSIONE Tipo 172300
 REVOLVING TAILSTOCK WITH COMPRESSION

C = Corsa di compressione
 C = Absorber stroke

ATTACCO CILINDRICO (Cylindrical fitting)

| Art. / Code | d | D | E | H | L | S | C |
|-------------|--------|----|----|----|----|----|---|
| 172.308 | 8 | 32 | 14 | 44 | 35 | 16 | 2 |
| 172.310 | 10 | 32 | 14 | 44 | 35 | 16 | 2 |
| 172.312 | 12 | 32 | 14 | 44 | 35 | 16 | 2 |
| 172.314 | 14 | 32 | 14 | 44 | 35 | 16 | 2 |
| 172.315 | 15.875 | 32 | 14 | 44 | 35 | 16 | 2 |
| 172.316 | 16 | 32 | 14 | 44 | 35 | 16 | 2 |
| 172.319 | 19.05 | 32 | 14 | 44 | 46 | 16 | 2 |
| 172.320 | 20 | 32 | 14 | 44 | 46 | 16 | 2 |
| 172.322 | 22 | 32 | 14 | 44 | 46 | 16 | 2 |
| 172.325 | 25 | 32 | 14 | 44 | 46 | 16 | 2 |
| 172.326 | 25.40 | 32 | 14 | 44 | 46 | 16 | 2 |

ATTACCO CONO MORSE (Morse taper fitting)

| Art. / Code | d | D | E | H | L | S | C |
|-------------|-------|----|----|----|----|----|---|
| 172.300 CM2 | C.M.2 | 32 | 14 | 44 | 69 | 16 | 2 |

La contropunta viene fornita con cuspide art. 172.301 (salvo diversa identificazione)
 The revolving tailstock is provided with code 172.301 (interchangeable insert)

CUSPIDI INTERCAMBIABILI PER CONTROPUNTA
 INTERCHANGEABLE INSERT

Per articolo (for Code): 172.300

| Art. / Code | Fig. | E | S | G | F | Punta / Center |
|-------------|------|----|----|----|----|----------------|
| 172.301 | 1 | 14 | 16 | - | - | 60° |
| 172.301 090 | 1 | 14 | 22 | - | - | 90° |
| 172.302 | 2 | 14 | 22 | 7 | - | 60° |
| 172.302B | 2 | 14 | 26 | 8 | - | 60° |
| 172.303 | 3 | 20 | 12 | 12 | 10 | 60° |

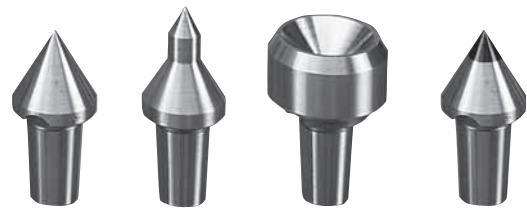
CON METALLO DURO (With hard metal)

| Art. / Code | Fig. | E | S | G | F | Punta / Center |
|-------------|------|----|----|---|---|----------------|
| 172.301 HM | 4 | 14 | 16 | 6 | - | 60° |

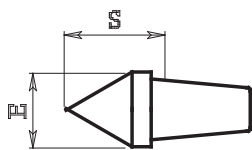

Fig. 1

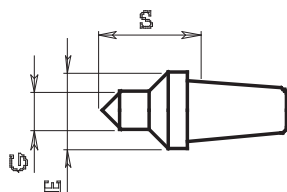

Fig. 2

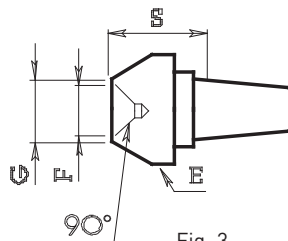

Fig. 3

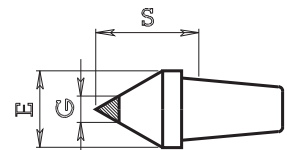
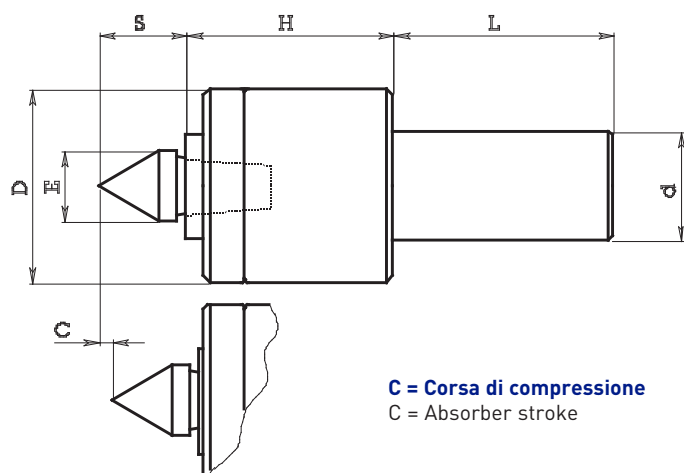

Fig. 4

CONTROPUNTA ROTANTE CON COMPRESSIONE Tipo 172400

REVOLVING TAILSTOCK WITH COMPRESSION



C = Corsa di compressione
C = Absorber stroke



ATTACCO CILINDRICO (Cylindrical fitting)

| Art. / Code | d | D | E | H | L | S | C |
|-------------|-------|----|----|----|----|----|---|
| 172.419 | 19.05 | 43 | 18 | 43 | 46 | 21 | 3 |
| 172.420 | 20 | 43 | 18 | 43 | 46 | 21 | 3 |
| 172.422 | 22 | 43 | 18 | 43 | 46 | 21 | 3 |
| 172.425 | 25 | 43 | 18 | 43 | 46 | 21 | 3 |
| 172.426 | 25.40 | 43 | 18 | 43 | 46 | 21 | 3 |
| 172.430 | 30 | 43 | 18 | 43 | 46 | 21 | 3 |
| 172.431 | 31.75 | 43 | 18 | 43 | 46 | 21 | 3 |
| 172.432 | 32 | 43 | 18 | 43 | 46 | 21 | 3 |

ATTACCO CONO MORSE (Morse taper fitting)

| Art. / Code | d | D | E | H | L | S | C |
|-------------|-------|----|----|----|----|----|---|
| 172.400 CM2 | C.M.2 | 43 | 18 | 43 | 69 | 21 | 3 |
| 172.400 CM3 | C.M.3 | 43 | 18 | 43 | 85 | 21 | 3 |

La contropunta viene fornita con cuspidi art. 172.401 (salvo diversa richiesta)

The revolving tailstock is provided with code 172.401 (interchangeable insert)

CHIAVI PER ESTRAZIONE CUSPIDI ART. 172.411

PULLER CODE 172.411

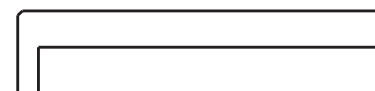

CUSPIDI INTERCAMBIABILI PER CONTROPUNTA

INTERCHANGEABLE INSERT

Per articolo (for Code): 172.400

| Art. / Code | Fig. | E | S | G | Punta / Center |
|-------------|------|----|----|----|----------------|
| 172.401 | 1 | 18 | 21 | — | 60° |
| 172.401 090 | 1 | 18 | 28 | — | 90° |
| 172.402 | 2 | 18 | 27 | 7 | 60° |
| 172.402B | 2 | 18 | 38 | 9 | 60° |
| 172.403 | 3 | 30 | 21 | 14 | 60° |
| 172.404 | 4 | 26 | 20 | 20 | — |



CON METALLO DURO (With hard metal)

| Art. / Code | Fig. | E | S | G | Punta / Center |
|-------------|------|----|----|---|----------------|
| 172.401 HM | 5 | 18 | 21 | 6 | 60° |

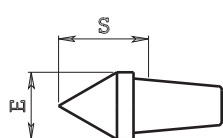

Fig. 1

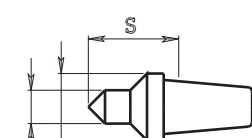

Fig. 2

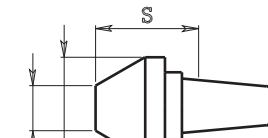

Fig. 3

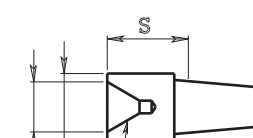

Fig. 4

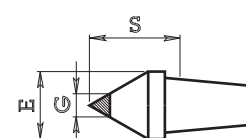
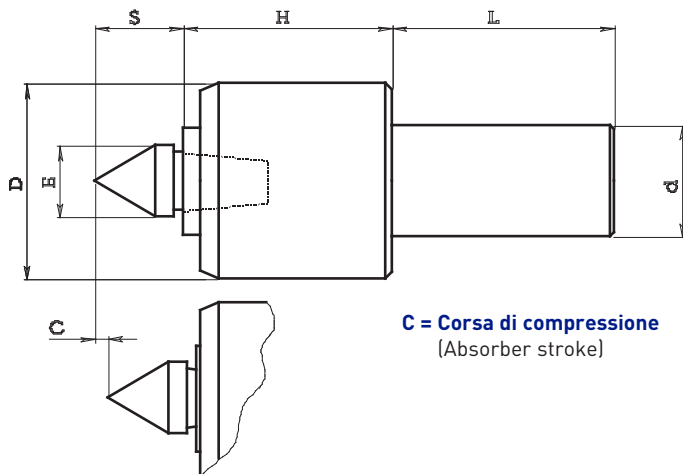

Fig. 5

CONTROPUNTA ROTANTE CON COMPRESSIONE Tipo 172600

REVOLVING TAILSTOCK WITH COMPRESSION

C = Corsa di compressione
 (Absorber stroke)

ATTACCO CILINDRICO (Cylindrical fitting)

| Art. / Code | d | D | E | H | L | S | C |
|-------------|-------|----|----|----|----|----|-----|
| 172.625 | 25 | 58 | 28 | 71 | 50 | 34 | 2.5 |
| 172.626 | 25.40 | 58 | 28 | 71 | 50 | 34 | 2.5 |
| 172.632 | 32 | 58 | 28 | 71 | 70 | 34 | 2.5 |
| 172.640 | 40 | 58 | 28 | 71 | 85 | 34 | 2.5 |

ATTACCO CONO MORSE (Morse taper fitting)

| Art. / Code | d | D | E | H | L | S | C |
|-------------|-------|----|----|----|-----|----|-----|
| 172.600 CM3 | C.M.3 | 58 | 28 | 71 | 85 | 34 | 2.5 |
| 172.600 CM4 | C.M.4 | 58 | 28 | 71 | 109 | 34 | 2.5 |
| 172.600 CM5 | C.M.5 | 58 | 28 | 71 | 136 | 34 | 2.5 |

La contropunta viene fornita con cuspidi art. 172.601 (salvo diversa richiesta)

The revolving tailstock is provided with code 172.601 (interchangeable insert)

CUSPIDI INTERCAMBIABILI PER CONTROPUNTA

INTERCHANGEABLE INSERT

 Per articolo (for Code): **172.600**

| Art. / Code | Fig. | E | S | G | Punta / Center |
|-------------|------|----|----|----|----------------|
| 172.601 | 1 | 28 | 34 | — | 60° |
| 172.602 | 2 | 28 | 40 | 7 | 60° |
| 172.602B | 2 | 28 | 40 | 12 | 60° |
| 172.603 | 3 | 58 | 36 | 25 | 60° |
| 172.604 | 4 | 28 | 32 | 24 | — |

CON METALLO DURO (With hard metal)

| Art. / Code | Fig. | E | S | G | Punta / Center |
|-------------|------|----|----|----|----------------|
| 172.601 HM | 5 | 28 | 34 | 10 | 60° |

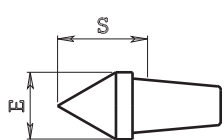

Fig. 1

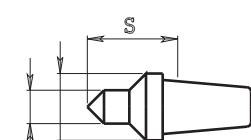

Fig. 2

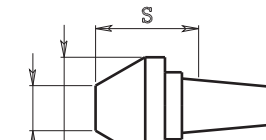

Fig. 3

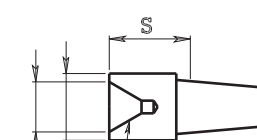

Fig. 4

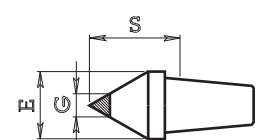
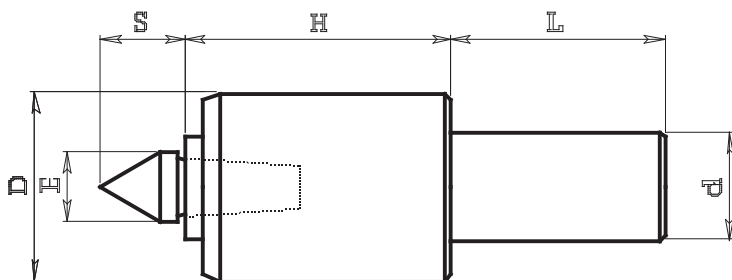

Fig. 5

CONTROPUNTA ROTANTE Tipo 172300 F

REVOLVING TAILSTOCK



Senza compressione
(Without compression)

ATTACCO CILINDRICO (Cylindrical fitting)

| Art. / Code | d | D | E | H | L | S |
|-------------|--------|----|----|----|----|----|
| 172.308 F | 8 | 32 | 14 | 44 | 35 | 16 |
| 172.310 F | 10 | 32 | 14 | 44 | 35 | 16 |
| 172.312 F | 12 | 32 | 14 | 44 | 35 | 16 |
| 172.314 F | 14 | 32 | 14 | 44 | 35 | 16 |
| 172.315 F | 15.875 | 32 | 14 | 44 | 35 | 16 |
| 172.316 F | 16 | 32 | 14 | 44 | 35 | 16 |
| 172.319 F | 19.05 | 32 | 14 | 44 | 46 | 16 |
| 172.320 F | 20 | 32 | 14 | 44 | 46 | 16 |
| 172.322 F | 22 | 32 | 14 | 44 | 46 | 16 |
| 172.325 F | 25 | 32 | 14 | 44 | 46 | 16 |
| 172.326 F | 25.40 | 32 | 14 | 44 | 46 | 16 |

ATTACCO CONO MORSE (Morse taper fitting)

| Art. / Code | d | D | E | H | L | S |
|---------------|-------|----|----|----|----|----|
| 172.300 F CM2 | C.M.2 | 32 | 14 | 44 | 69 | 16 |

La contropunta viene fornita con cuspidi art. 172.301 (salvo diversa identificazione)

The revolving tailstock is provided with code 172.301 (interchangeable insert)

CUSPIDI INTERCAMBIABILI PER CONTROPUNTA

INTERCHANGEABLE INSERT

Per articolo (for Code): 172.300

| Art. / Code | Fig. | E | S | G | F | Punta / Center |
|-------------|------|----|----|----|----|----------------|
| 172.301 | 1 | 14 | 16 | - | - | 60° |
| 172.301 090 | 1 | 14 | 22 | - | - | 90° |
| 172.302 | 2 | 14 | 22 | 7 | - | 60° |
| 172.302B | 2 | 14 | 26 | 8 | - | 60° |
| 172.303 | 3 | 20 | 12 | 12 | 10 | 60° |

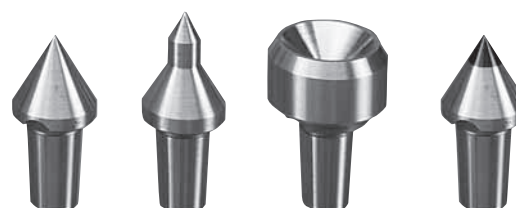

CON METALLO DURO (With hard metal)

| Art. / Code | Fig. | E | S | G | F | Punta / Center |
|-------------|------|----|----|---|---|----------------|
| 172.301 HM | 4 | 14 | 16 | 6 | - | 60° |

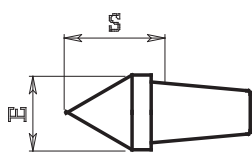

Fig. 1

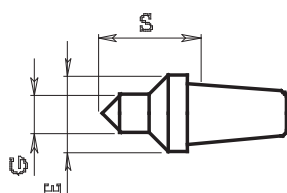

Fig. 2

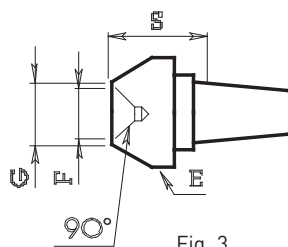

Fig. 3

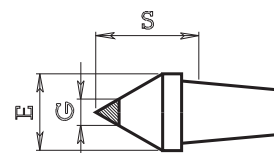
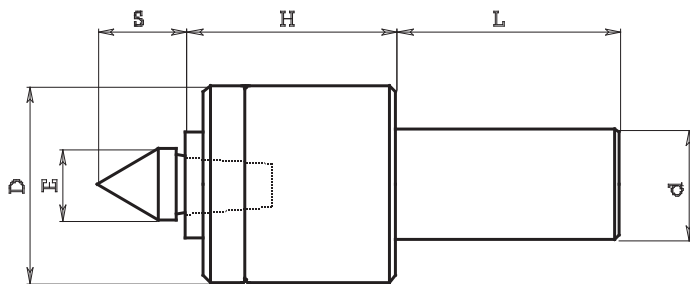

Fig. 4

CONTROPUNTA ROTANTE Tipo 172600 F

REVOLVING TAILSTOCK

 Senza compressione
 (Without compression)

ATTACCO CILINDRICO (Cylindrical fitting)

| Art. / Code | d | D | E | H | L | S |
|-------------|-------|----|----|----|----|----|
| 172.419 F | 19.05 | 43 | 18 | 43 | 46 | 21 |
| 172.420 F | 20 | 43 | 18 | 43 | 46 | 21 |
| 172.422 F | 22 | 43 | 18 | 43 | 46 | 21 |
| 172.425 F | 25 | 43 | 18 | 43 | 46 | 21 |
| 172.426 F | 25.40 | 43 | 18 | 43 | 46 | 21 |
| 172.430 F | 30 | 43 | 18 | 43 | 46 | 21 |
| 172.431 F | 31.75 | 43 | 18 | 43 | 46 | 21 |
| 172.432 F | 32 | 43 | 18 | 43 | 46 | 21 |

ATTACCO CONO MORSE (Morse taper fitting)

| Art. / Code | d | D | E | H | L | S |
|---------------|-------|----|----|----|----|----|
| 172.400 F CM2 | C.M.2 | 43 | 18 | 43 | 69 | 21 |
| 172.400 F CM3 | C.M.3 | 43 | 18 | 43 | 85 | 21 |

La contropunta viene fornita con cuspidi art. 172.401 (salvo diversa richiesta)

The revolving tailstock is provided with code 172.401 (interchangeable insert)

CHIAVI PER ESTRAZIONE CUSPIDI ART. 172.411

PULLER CODE 172.411

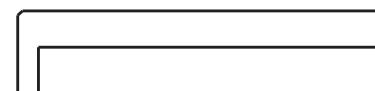
CONTROPUNTA ROTANTE CON COMPRESSIONE Tipo 172600

REVOLVING TAILSTOCK WITH COMPRESSION

Per articolo (for Code): 172.400

| Art. / Code | Fig. | E | S | G | Punta / Center |
|-------------|------|----|----|----|----------------|
| 172.401 | 1 | 18 | 21 | — | 60° |
| 172.401 090 | 1 | 18 | 28 | — | 90° |
| 172.402 | 2 | 18 | 27 | 7 | 60° |
| 172.402B | 2 | 18 | 38 | 9 | 60° |
| 172.403 | 3 | 30 | 21 | 14 | 60° |
| 172.404 | 4 | 26 | 20 | 20 | — |

CON METALLO DURO (With hard metal)

| Art. / Code | Fig. | E | S | G | Punta / Center |
|-------------|------|----|----|---|----------------|
| 172.401 HM | 5 | 18 | 21 | 6 | 60° |

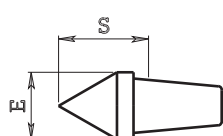

Fig. 1

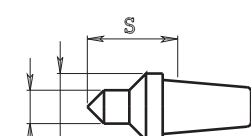

Fig. 2

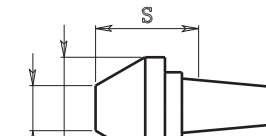

Fig. 3

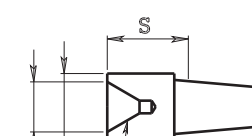

Fig. 4

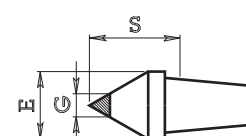
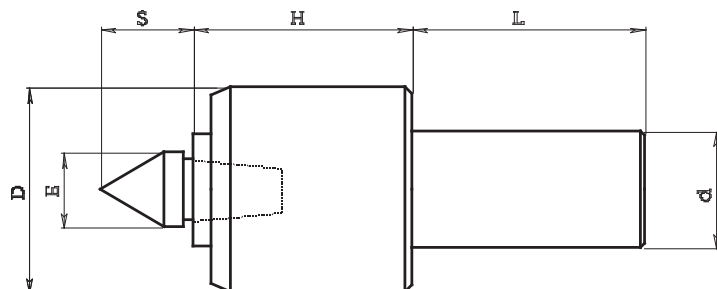

Fig. 5

CONTROPUNTA ROTANTE Tipo 172600 F
REVOLVING TAILSTOCK



ATTACCO CILINDRICO (Cylindrical fitting)

| Art. / Code | d | D | E | H | L | S |
|-------------|-------|----|----|----|----|----|
| 172.625 F | 25 | 58 | 28 | 71 | 50 | 34 |
| 172.626 F | 25.40 | 58 | 28 | 71 | 50 | 34 |
| 172.632 F | 32 | 58 | 28 | 71 | 70 | 34 |
| 172.640 F | 40 | 58 | 28 | 71 | 85 | 34 |

Senza compressione
(Without compression)

ATTACCO CONO MORSE (Morse taper fitting)

| Art. / Code | d | D | E | H | L | S |
|---------------|-------|----|----|----|-----|----|
| 172.600 F CM3 | C.M.3 | 58 | 28 | 71 | 85 | 34 |
| 172.600 F CM4 | C.M.4 | 58 | 28 | 71 | 109 | 34 |
| 172.600 F CM5 | C.M.5 | 58 | 28 | 71 | 136 | 34 |

La contropunta viene fornita con cuspidi art. 172.601 (salvo diversa richiesta)
The revolving tailstock is provided with code 172.601 (interchangeable insert)

CUSPIDI INTERCAMBIABILI PER CONTROPUNTA
INTERCHANGEABLE INSERT

Per articolo (for Code): 172.600

| Art. / Code | Fig. | E | S | G | Punta / Center |
|-------------|------|----|----|----|----------------|
| 172.601 | 1 | 28 | 34 | — | 60° |
| 172.602 | 2 | 28 | 40 | 7 | 60° |
| 172.602B | 2 | 28 | 40 | 12 | 60° |
| 172.603 | 3 | 58 | 36 | 25 | 60° |
| 172.604 | 4 | 28 | 32 | 24 | — |



CON METALLO DURO (With hard metal)

| Art. / Code | Fig. | E | S | G | Punta / Center |
|-------------|------|----|----|----|----------------|
| 172.601 HM | 5 | 28 | 34 | 10 | 60° |

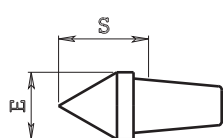

Fig. 1

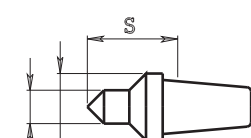

Fig. 2

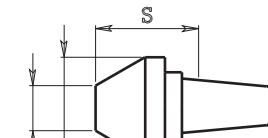

Fig. 3

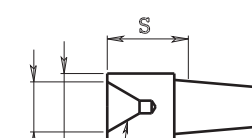

Fig. 4

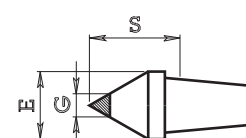
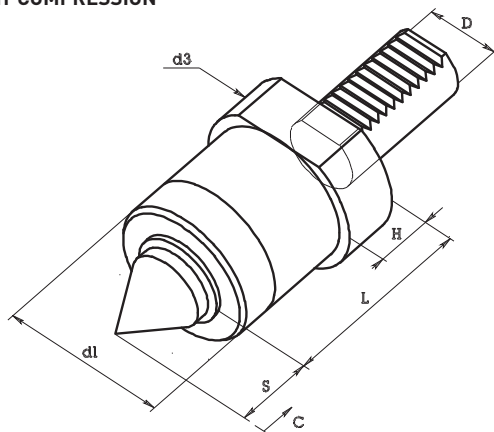

Fig. 5

CONTROPUNTA ROTANTE CON COMPRESSIONE

REVOLVING TAILSTOCK WITH COMPRESSION



C = Corsa di compressione

C = Absorber stroke

| Art. / Code | D | d1 | d3 | L | H | S | C |
|-------------|----|----|----|----|----|----|-----|
| 9 V3.30.78 | 30 | 58 | 68 | 78 | 20 | 34 | 2,5 |

| | | | | | | | |
|------------|----|----|----|----|----|----|-----|
| 9 V3.40.80 | 40 | 58 | 83 | 80 | 22 | 34 | 2,5 |
|------------|----|----|----|----|----|----|-----|

N.B. La contropunta viene fornita con cuspidi come Fig. 1 - Salvo diversa richiesta.

The revolving tailstock is provided with interchangeable insert Fig. 1.

CUSPIDI INTERCAMBIABILI PER CONTROPUNTA

INTERCHANGEABLE INSERT

| Art. / Code | Fig. | E | S | G |
|-------------|------|----|----|----|
| 172.601 | 1 | 28 | 34 | — |
| 172.602 | 2 | 28 | 40 | 7 |
| 172.602 B | 2 | 28 | 40 | 12 |
| 172.603 | 3 | 58 | 36 | 25 |
| 172.604 | 4 | 28 | 32 | 24 |

Con metallo duro (With hard metal)

| Art. / Code | Fig. | E | S | G |
|-------------|------|----|----|----|
| 172.601 HM | 5 | 28 | 34 | 10 |

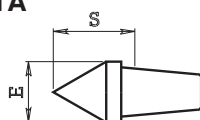

Fig. 1

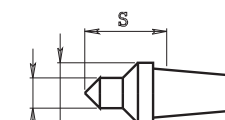

Fig. 2

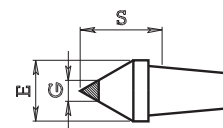

Fig. 5

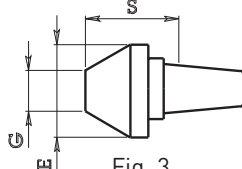

Fig. 3

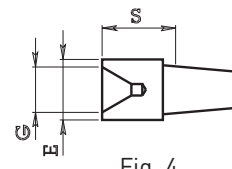

Fig. 4

CHIA-MO

WWW.CHIAMO.IT I T A L Y



Via Matteotti, 311 - GARDONE V.T. (BS) Tel. 030 832775 - Fax 030 8911264
www.utensileriapelizzari.it - commerciale@pelizzarifaustino.it